

WELL COMPLETION REPORT AND DRILLER'S LOG

KANSAS
State Geological Survey
WICHITA BRANCH

API No. 15 — 109 — 20,181
County Number

Operator
Beren Corporation

Address
970 Fourth Financial Center, Wichita, Kansas 67202

Well No. 1 Lease Name J & J FARMS

Footage Location
feet from (N) (S) line feet from (E) (W) line

Principal Contractor Geologist
Murfin Drilling Company Tony Kruse

Spud Date Date Completed Total Depth P.B.T.D.
8/25/81 9/7/81 4800

Directional Deviation Oil and/or Gas Purchaser

S. 2 T. 12S R. 34W E

Loc. SW NW

County Logan

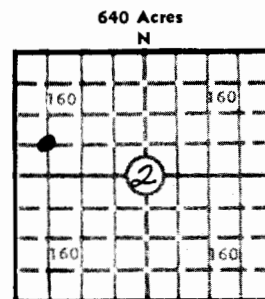

Locate well correctly
Elev.: Gr. 3208

DF KB 3213

CASING RECORD

Report of all strings set— surface, intermediate, production, etc.

Purpose of string	Size hole drilled	Size casing set (in O.D.)	Weight lbs/ft.	Setting depth	Type cement	Sacks	Type and percent additives
Surface	12 1/4"	8-5/8"	24#	329'	60-40 pozmix	275	2% gel, 3% CC
Production		5 1/2"		4798'	Pozmix	250	2% gel, 3% CC
					Howco Lite	500	
					Common	50	

LINER RECORD

Top, ft.	Bottom, ft.	Sacks cement
----------	-------------	--------------

PERFORATION RECORD

Shots per ft.	Size & type	Depth interval
---------------	-------------	----------------

TUBING RECORD

Size	Setting depth	Packer set at
------	---------------	---------------

ACID, FRACTURE, SHOT, CEMENT SQUEEZE RECORD

Amount and kind of material used	Depth interval treated

INITIAL PRODUCTION

Date of first production Producing method (flowing, pumping, gas lift, etc.)

RATE OF PRODUCTION PER 24 HOURS Oil Gas Water Gas-oil ratio
bbis. MCF bbls. CFPB

Disposition of gas (vented, used on lease or sold) Producing interval (s)

INSTRUCTIONS: As provided in KCC Rule 82-2-125, within 90 days after completion of a well, one completed copy of this Drillers Log shall be trans-
mitted to the State Geological Survey of Kansas, 4150 Monroe Street, Wichita, Kansas 67209. Copies of this form are available from the Conservation
Division, State Corporation Commission, 245 No. Water, Wichita, Kansas 67202. Phone AC 316-522-2206. If confidential custody is desired, please note
Rule 82-2-125. Drillers Logs will be on open file in the Oil and Gas Division, State Geological Survey of Kansas, Lawrence, Kansas 66044.

Operator Beren Corporation		DESIGNATE TYPE OF COMP.: OIL, GAS, DRY HOLE, SWDW, ETC.:
Well No. 1	Lease Name J & J FARMS	Oil
S 2 T 12S R 34W E W		

WELL LOG

Show all important zones of porosity and contents thereof; cored intervals, and all drill-stem tests, including depth interval tested, cushion used, time tool open, flowing and shut-in pressures, and recoveries.

SHOW GEOLOGICAL MARKERS, LOGS RUN,
OR OTHER DESCRIPTIVE INFORMATION.

FORMATION DESCRIPTION, CONTENTS, ETC.	TOP	BOTTOM	NAME	DEPTH
Surface soil and sand	0	124		
Sand and clay	124	240		
Shale (blue)	240	330		
Shale and sand	330	2090		
Shale and lime	2090	2490		
Shale and sand	2490	2680		
Anhydrite	2680	2703		
Shale and sand	2703	2798		
Shale and lime	2798	4085		
Lime	4085	4212		
Lime and shale	4212	4570		
Lime	4570	4800		
RTD	4800			

USE ADDITIONAL SHEETS, IF NECESSARY, TO COMPLETE WELL RECORD.

Date Received	
	Signature
	Don Beauchamp - Geologist
	Title
	October 22, 1981
	Date

158201

PI

WELL LOG

State Geological Survey
WICHITA BRANCH

PI

COMPANY Beren Corporation

SEC. 2 T. 12S R. 34W

FARM J & J Farms NO. 1

LOC. SW NW

RIG. NO. 21

TOTAL DEPTH 4800'

COUNTY Logan
KANSAS

COMM. 8-25-81

COMP. 9-7-81

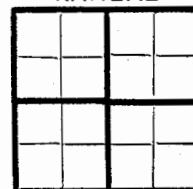

CONTRACTOR Murfin Drilling Co.

CASING

20

10

15

8-5/8" @ 329' w/275 sx 60-40 Pozmix, 3% CC, 2% Gel

12

6

13

5

PRODUCTION

5 1/2" @ 4798' w/250 sx Pozmix, 3% CC, 2% Gel,

FIGURES INDICATE BOTTOM OF FORMATIONS

500 Sx Howco Lite, 50 sx Common

Surface soil & sand	124
Sand & Clay	240
Shale (blue)	330
Shale & Sand	2090
Shale & Lime	2490
Shale & Sand	2680
Anhydrite	2703
Shale & Sand	2798
Shale & Lime	4085
Lime	4212
Lime & Shale	4570
Lime RTD	4800

RECEIVED
STATE CORPORATION COMMISSION

OCT 14
CONSERVATION DIVISION
Wichita, Kansas