

P1 [Signature]

STATE CORPORATION COMMISSION OF KANSAS
OIL & GAS CONSERVATION DIVISION

WELL COMPLETION OR RECOMPLETION FORM
ACO-1 WELL HISTORY

DESCRIPTION OF WELL AND LEASE

Operator: License # 5726
Name ... Driscoll Lease Operations, Inc.
Address ... Box 226
City/State/Zip Russell, Kansas 67665

Purchaser: Clear Creek, Inc.
P.O. Box 1045
McPherson, Kansas 67490

Operator Contact Person Larry Driscoll
Phone 913-483-5122

Contractor: License # 5671
Name Revlin Drlg. Inc.

Wellsite Geologist Roy Krueger
Phone 913-483-4783

Designate Type of Completion

- New Well Re-Entry Workover
- Oil SWD Temp Abd
- Gas Inj Delayed Comp.
- Dry Other (Core, Water Supply etc.)

If ONWO: old well info as follows:

Operator
Well Name
Comp. Date Old Total Depth

WELL HISTORY

Drilling Method:

- Mud Rotary Air Rotary Cable

9-15-85 9-19-85 9-20-85
Spud Date Date Reached TD Completion Date
3400 none
Total Depth PBDT

Amount of Surface Pipe Set and Cemented at 935 feet
Multiple Stage Cementing Collar Used? Yes No

If yes, show depth set...feet
If alternate 2 completion, cement circulated
from...feet depth to...w/...SX cmt

API NO. 15-167-22,665
County Russell
C. N1/2 NE1/4 Sec. 31 Twp. 13 Rge. 14 East West

4620 Ft North from Southeast Corner of Section
1320 Ft West from Southeast Corner of Section
(Note: Locate well in section plat below)

Lease Name Brown B Well # 3-A B

Field Name Gorham

Producing Formation Arhuckle

Elevation: Ground 1872 KB 1877

Section Plat

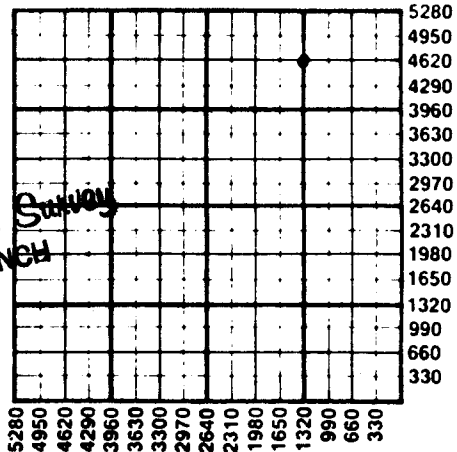

OCT 14 1985
State Geological Survey
WICHITA BRANCH

WATER SUPPLY INFORMATION

Disposition of Produced Water: Disposal Repressuring
Docket #

Questions on this portion of the ACO-1 call:

Water Resources Board (913) 296-3717

Source of Water:
Division of Water Resources Permit #

Groundwater...Ft North from Southeast Corner (Well) ...Ft West from Southeast Corner of Sec Twp Rge East West

Surface Water...Ft North from Southeast Corner (Stream, pond etc)...Ft West from Southeast Corner Sec Twp Rge East West

Other (explain) sink hole less than 15' acre (purchased from city, R.W.D. #)

INSTRUCTIONS: This form shall be completed in duplicate and filed with the Kansas Corporation Commission, 200 Colorado Derby Building, Wichita, Kansas 67202, within 90 days after completion or recompletion of any well. Rule 82-3-130 and 82-3-107 apply.

Information on side two of this form will be held confidential for a period of 12 months if requested in writing and submitted with the form. See rule 82-3-107 for confidentiality in excess of 12 months.

One copy of all wireline logs and drillers time log shall be attached with this form. Submit CP-4 form with all plugged wells. Submit CP-111 form with all temporarily abandoned wells.

SIDE TWO

Operator Name Driscoll Lease Operations Inc. Lease Name Brown B Well # 3 A B

Sec. 31 Twp. 13 Rge. 14 East West County Russell

WELL LOG

INSTRUCTIONS: Show important tops and base of formations penetrated. Detail all cores. Report all drill stem tests giving interval tested, time tool open and closed, flowing and shut-in pressures, whether shut-in pressure reached static level, hydrostatic pressures, bottom hole temperature, fluid recovery, and flow rates if gas to surface during test. Attach extra sheet if more space is needed. Attach copy of log.

Drill Stem Tests Taken Yes No
 Samples Sent to Geological Survey Yes No
 Cores Taken Yes No

Formation Description
 Log Sample

Name	Top	Bottom
Anhydrite (drillers)	927	+ 950
Howard	2703	- 826
Topeka	2764	- 887
Heebner	2990	-1113
Toronto	3008	-1131
Lansing-Kansas City	3042	-1165
Conglomerate	3294	-1417
Arbuckle	3309	-1432
RTD	3402	-1525
4 1/2" Casing	3398	-1521

Estimated Production Per 24 Hours	Oil	Gas	Water	Gas-Oil Ratio	Gravity
	25 Bbls	0 MCF	0 Bbls	CFPB	33

METHOD OF COMPLETION

Production Interval

Disposition of gas: Vented Open Hole Perforation
 Sold Other (Specify) _____

Report all strings set-conductor, surface, intermediate, production, etc.

Purpose of String	Size Hole Drilled	Size Casing Set (in O.D.)	Weight Lbs/Ft.	Setting Depth	Type of Cement	#Sacks Used	Type and Percent Additives
Surface	12.1/4	8.5/8	24#	935	60-40 Poz	415	2% gel 3% CC
Production	7.7/8	4.1/2	10.5#	3398	Common	150	10% salt 5% gil 3/4 of 1% CFR2 1/4# flo seal

PERFORATION RECORD

Acid, Fracture, Shot, Cement Squeeze Record

Shots Per Foot	Specify Footage of Each Interval Perforated	(Amount and Kind of Material Used)	Depth
4	3317-3318' 4 holes	came in natural	3355

TUBING RECORD	Size	Set At	Packer at	Liner Run	<input type="checkbox"/> Yes <input checked="" type="checkbox"/> No
	2 1/2" upset	3320'			

Date of First Production 10-2-85 Producing Method Flowing Pumping Gas Lift Other (explain) _____