

STATE CORPORATION COMMISSION OF KANSAS  
OIL & GAS CONSERVATION DIVISION

WELL COMPLETION OR RECOMPLETION FORM  
ACO-1 WELL HISTORY

DESCRIPTION OF WELL AND LEASE

Operator: license # 6772  
name V. Francis Weigel  
address Box 244  
Gorham, KS 67640  
City State Zip

Operator Contact Person V. Francis Weigel  
Phone (913)637-5383

Contractor: license # 6427  
name Rosencrantz-Bemis Drilling

Wellbore Geologist  
Phone

Designate Type of Completion  
 New Well  Re-Entry  Workover  
 Oil  SWD  Temp Abd  
 Gas  Inj  Delayed Comp.  
 Dry  Other (Core, Water Supply etc.)

If OWWO: old well info as follows:  
Operator  
Well Name  
Comp. Date Old Total Depth

WELL HISTORY

Drilling Method:  Mud Rotary  Air Rotary  Cable  
6-10-86 6-13-86 6-17-86  
Spud Date Date Reached TD Completion Date  
957' 957'  
Total Depth PBTD

Amount of Surface Pipe Set and Cemented at 233' feet  
Multiple Stage Cementing Collar Used?  Yes  No

If Yes, Show Depth Set

If alternate completion, cement circulated from 233 feet depth to surface 125 feet

API NO. 15- 167-22-745  
County Russell, Kansas  
3910'N & 4900W of the SE corner (location) Sec 32 Twp 13S Rge 15 East X West  
3910 Ft North from Southeast Corner of Section  
4900 Ft West from Southeast Corner of Section  
(Note: locate well in section plat below)

Lease Name Speer SWD Well# 3

Field Name

Producing Formation

Elevation: Ground 1903 KB N.A. KC-KCL

Section Plat

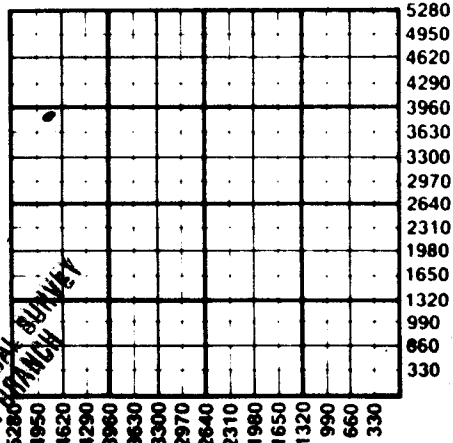

WATER SUPPLY INFORMATION

Source of Water:  
Division of Water Resources Permit #  
 Groundwater (Well) Ft North From Southeast Corner and Ft. West From Southeast Corner of Sec Twp Rge East West  
 Surface Water (Stream, Pond etc.) Ft North From Southeast Corner and Ft West From Southeast Corner Sec Twp Rge East West

Other (specify) (purchased from city, R.W.D.#)

Disposition of Produced Water:  Disposal  Repressuring

Depth #

**INSTRUCTIONS:** This form shall be completed in duplicate and filed with the Kansas Corporation Commission, 200 Colorado Derby Building, Wichita, Kansas 67202, within 90 days after completion or recompletion of any well. Rules 82-3-130 and 82-3-107 apply.  
Information on side two of this form will be held confidential for a period of 12 months if requested in writing and submitted with the form. See rule 82-3-107 for confidentiality in excess of 12 months.  
One copy of all wireline logs and drillers time log shall be attached with this form. Submit CP-4 form with all plugged wells. Submit CP-111 form with all temporarily abandoned wells.

Operator Name V. Francis Weigel Lease Name Speer SWD Well# 3 SEC 32 TWP 13S RGE 15W  East  West

<b>TUBING RECORD</b> size 2 3/8 Duo-Lined set at 505' packer at 505'		Liner Run <input type="checkbox"/> Yes <input checked="" type="checkbox"/> No
Date of First Production N/A	Producing method <input type="checkbox"/> flowing <input type="checkbox"/> pumping <input type="checkbox"/> gas lift <input type="checkbox"/> Other (explain) N/A	

Drill Stem Tests Taken  Yes  No  
 Samples Sent to Geological Survey  Yes  No  
 Cores Taken  Yes  No

**Formation Description**  
 Log  Sample

Name	Top	Bottom
Top soil	0	3
Brown Clay	3	22
Shale	22	75
Iron Pyrite	75	85
Shale	85	180
Sand Rock	180	195
Shale	195	228
Sand Rock	228	236
Shale	236	245
Fire Clay	245	280
Sand	280	302
Red Bed	302	330
Sand	330	350
Shale	350	355
Sand	355	472
Red Bed	472	500
Sand	500	590
Red Bed	590	948
Anhydrite	948	957

Estimated Production Per 24 Hours	Oil	Gas	Water	Gas-Oil Ratio	Gravity
	Bbls	MCF	Bbls	CFPB	
N/A					

Disposition of gas:  vented  sold  used on lease  
**METHOD OF COMPLETION**  open hole  perforation  other (specify)  
**PRODUCTION INTERVAL** Disposal 568-597

Purpose of string	size hole drilled	size casing set (I.D.)	weight lbs/ft	setting depth	type of cement	# sacks used	type and percent additives
Surface	12 1/2"	8 5/8"	24#	233'	common	125	2% gel, 3% cc.
Disposal	7 7/8"	5 1/2"	14#	954'	common	175	10% salt

shots per foot	specify footage of each interval perforated	Acid, Fracture, Shot, Cement Squeeze Record (amount and kind of material used)	
			Depth
1	568-597	None	