

TWIN DRILLING COMPANY  
 Riedel No. 1.

SEC 27 T. 13 R. 16W

SW c NE

Plotted Texas CO.

County. Ellis.

Total Depth. 3536'  
 Comm. 2-12-36 Comp. 5-6-36  
 Shot or Treated.  
 Contractor. Twin Drlg. Co.  
 Issued. 5-30-36 Rotary to 3182'

MAY 30 1936

CASING.  
 10 " 700'  
 6 " 3182'  
 5 " 3500'

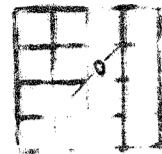

Elevation.

Production. Dry

Figures Indicate Bottom of Formations.

shale blue	28	shale blue med.	1983	lime light hard	3085
sand grey soft	36	lime grey med.	1988	lime hard	3095
shale dark soft	197	shale blue med.	2020	lime med.	3105
sand & shells	350	lime light hard	2075	lime hard	3113
sand grey soft	400	shale dark sft	2080	lime light hard	3130
shale blue sft	452	shale blue med.	2085	lime white sft	3140
pyrites hard	468	lime light hard	2095	lime grey hard	3164
shale dark soft	517	shale brown soft	2100	shale blue sft	3168
sand soft light	593	shale blue med.	2108	lime grey hard	3174
sand & shale	653	lime grey med.	2117	Cored 3174-84'	
shale blue med.	666	lime grey hard	2226	shale blue green	3179
shale & shells	676	lime grey broken med.	2254	shale red	3179.8
shale blue soft	691	shale blue med.	2273	shale blue green	3180
shale & shells	790	shale brown soft	2278	lime & few green shale	
shale red soft	860	shale blue soft	2315	streaks	3184
red sandy shale sft	960	lime light brkn med.	2350	Top Dodge 3180	
shale red med.	993	shale red soft	2363	6" 3182' RUST	
shale red sft	1010	lime broken hard	2385	lime	3197
shale & shells red	1055	lime broken med.	2390	shale blue	3201
pyrites of iron	1057	shale blue med.	2420	shale red	3207
shale red soft	1065	shale blue med.	2440	shale grey	3212
anhydrite soft	1086	lime light brkn med.	2455	Top OSWALD 3212	
anhydrite hard	1111	shale red soft	2460	lime	3232
shale red soft	1175	lime grey hard	2528	shale red	3240
shale red med.	1268	lime broken light med	2550	lime grey	3275
shale red brown	1343	shale blue sft	2570	Show oil 32 40-45	
shale red soft	1370	lime grey hard	2600	lime	3295
shale & shells blue		shale dark med	2612	lime grey	3332
grey	1414	lime med.	2640	lime hard	3355
shale blue & shells		shale dark	2655	lime grey	3370
grey med.	1430	lime	2660	lime	3393
shale dark soft	1450	broken lime & shale	2699	lime grey	3414
lime light broken med.	1465	lime broken med.	2702	shale blue	3420
lime light hard	1470	lime hard	2725	lime grey	3434
shale dark soft	1476	shale	2728	lime	3440
shale dark med.	1495	shale blue soft	2735	lime grey	3452
salt med.	1566	lime light brkn med	2750	lime	3461
salt grey med.	1690	shale blue sft	2755	red rock	3466
shale dark soft	1720	lime grey hard	2775	lime	3471
lime broken grey med.	1748	shale red med.	2781	conglomerate	3507
shale dark soft	1755	shale red	2788	lime	3536
shale blue soft	1760	broken lime	2805	Top Siliceous 3507	
lime grey hard	1770	shale	2810	HFV 3534-36	
shale dark med.	1785	lime shells	2815	Total Depth	3536
lime broken	1803	shale	2819		
lime light broken	1808	lime light brkn med	2840		
shale blue soft	1818	shale & lime shells			
lime grey hard	1828	blue & grey med	2865		
shale blue sft	1835	shale blue & shells grey			
lime grey hard	1844	med.	2888		
shale dark soft	1848	lime grey med	2905		
lime grey hard	1865	lime med	2939		
lime broken grey med	1881	lime brkn light med	2945		
lime grey hard	1939	lime grey hard	3010		
lime grey brkn med.	1958	lime med	3020		
lime grey hard	1973	lime broken light med	3060		