

State Geological Survey
WICHITA, BRANDED

KANSAS DRILLERS LOG

S. 34 T. 13 R. 17 ^W
 Loc. 50' NE/NW NW SE
 County Ellis

API No. 15 — 051 — 21,651
County Number

Operator
R. P. Nixon Operations

Address
207 West 12th St. Hays, Kansas 67601

Well No. #1 Lease Name Ben

Footage Location
280 APPROX feet from (N) line 380 feet from (W) line OF SEK

Principal Contractor RAINS & WILLIAMSON CO Geologist DAN A NIXON

Spud Date 3-30-79 Total Depth 3475 P.B.T.D.

Date Completed 4-5-79 Oil Purchaser CLEAR CREEK INC

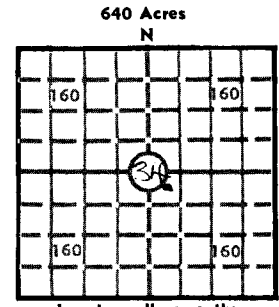

Locate well correctly
 Elev.: Gr. 1942
 DF 1944 KB 1947

CASING RECORD

Report of all strings set — surface, intermediate, production, etc.

Purpose of string	Size hole drilled	Size casing set (in O.D.)	Weight lbs/ft.	Setting depth	Type cement	Sacks	Type and percent additives
SURFACE	12 1/4	8 5/8	28#	227	COMMON	150	3% c.c. 2% gel
PRODUCTION	7 7/8	4 1/2"		3466	COMMON	125	10% salt 15bbls saltflus

LINER RECORD

PERFORATION RECORD

Top, ft.	Bottom, ft.	Sacks cement	Shots per ft.	Size & type	Depth interval
			one	L.E.	3249-3267
			one	D.P.	3391-94 3318-20
					3302-04

Size	Setting depth	Packer set at
2"	3472	-----

ACID, FRACTURE, SHOT, CEMENT SQUEEZE RECORD

Amount and kind of material used	Depth interval treated
750 gals 15% acid	ARBUCKLE
2000 gals 28% acid	3249-3267

INITIAL PRODUCTION

Date of first production <u>AUGUST 20 1979</u>	Producing method (flowing, pumping, gas lift, etc.) <u>PUMPING</u>
RATE OF PRODUCTION PER 24 HOURS	Oil <u>5</u> bbls. Gas <u>70</u> bbls. Water <u>70</u> bbls. Gas-oil ratio <u>CFPB</u>
Disposition of gas (vented, used on lease or sold)	Producing interval (s)

INSTRUCTIONS: As provided in KCC Rule 82-2-125, within 90 days after completion of a well, one completed copy of this Drillers Log shall be transmitted to the State Geological Survey of Kansas, 4150 Monroe Street, Wichita, Kansas 67209. Copies of this form are available from the Conservation Division, State Corporation Commission, 3830 So. Meridian (P.O. Box 17027), Wichita, Kansas 66217. Phone AC 316-522-2206. If confidential custody is desired, please note Rule 82-2-125. Drillers Logs will be on open file in the Oil and Gas Division, State Geological Survey of Kansas, Lawrence, Kansas 66044.

Operator R P NIXON OPERATIONS DESIGNATE TYPE OF COMP.: OIL, GAS, DRY HOLE, SWDW, ETC.: OIL

Well No. ONE Lease Name BEN

S 34 T 13 R 17 ^{EX} W ELLIS COUNTY KANSAS

WELL LOG

Show all important zones of porosity and contents thereof; cored intervals, and all drill-stem tests, including depth interval tested, cushion used, time tool open, flowing and shut-in pressures, and recoveries.

SHOW GEOLOGICAL MARKERS, LOGS RUN, OR OTHER DESCRIPTIVE INFORMATION.

FORMATION DESCRIPTION, CONTENTS, ETC.	TOP	BOTTOM	NAME	DEPTH
ANHYDRITE (DRLRS)	1127			
QUEEN HILL SHALE	3096			
HIEBNER SHALE	3179			
TORONTO LIME	3196			
LANSING - KANSAS CITY	3224			
BASE OF KANSAS CITY	3445			
ARBUCKLE DOLOMITE	3463			
R T D	3475			

USE ADDITIONAL SHEETS, IF NECESSARY, TO COMPLETE WELL RECORD.

Date Received _____

Signature Mamee N. Stefan

Title SECY

Date 6-26-81