

15-051-21778

KANSAS

WELL COMPLETION REPORT AND DRILLER'S LOG

API No. 15 — 051 — 21,778
 County Number

S. 8 T. 13S R. 17W E
 Loc. 330' W & 70' S of C N/2
 County Ellis

Operator
 Frontier Oil Company

Address
 1720 KSB&T Building, Wichita, Kansas 67202

Well No. 1 Lease Name Polifka Farms

Footage Location
 feet from (N) (S) line feet from (E) (W) line

Principal Contractor Red Tiger Drilling Company Geologist Richard Parker

Spud Date 9/24/79 Date Completed 10/7/79 Total Depth 3,636' P.B.T.D.

Directional Deviation Oil and/or Gas Purchaser

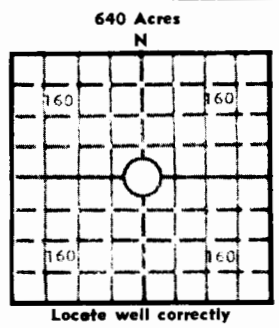

Elev.: Gr. _____

DF _____ KB 2,032'

CASING RECORD

Report of all strings set — surface, intermediate, production, etc.

Purpose of string	Size hole drilled	Size casing set (in O.D.)	Weight lbs/ft.	Setting depth	Type cement	Sacks	Type and percent additives
Surface	12 1/4"	8 5/8"	28#	218.30'	Common	150	2% Gel, 3% C.C.

LINER RECORD

PERFORATION RECORD

Top, ft.	Bottom, ft.	Sacks cement	Shots per ft.	Size & type	Depth interval

TUBING RECORD

Size	Setting depth	Packer set at

ACID, FRACTURE, SHOT, CEMENT SQUEEZE RECORD

Amount and kind of material used	Depth interval treated

INITIAL PRODUCTION

Date of first production Dry Hole Producing method (flowing, pumping, gas lift, etc.)

RATE OF PRODUCTION PER 24 HOURS	Oil bbls.	Gas MCF	Water bbls.	Gas-oil ratio	CFPB

Disposition of gas (vented, used on lease or sold) Producing interval (s)

INSTRUCTIONS: As provided in KCC Rule 82-2-125, within 90 days after completion of a well, one completed copy of this Drillers Log shall be transmitted to the State Geological Survey of Kansas, 4150 Monroe Street, Wichita, Kansas 67209. Copies of this form are available from the Conservation Division, State Corporation Commission, 245 No. Water, Wichita, Kansas 67202. Phone AC 316-522-2206. If confidential custody is desired, please note Rule 82-2-125. Drillers Logs will be on open file in the Oil and Gas Division, State Geological Survey of Kansas, Lawrence, Kansas 66044.

Operator
Frontier Oil Company

DESIGNATE TYPE OF COMP.: OIL, GAS,
DRY HOLE, SWDW, ETC.:
Capped Well

Well No. 1 Lease Name Polifka Farms

Dry Hole - Capped

S 8 T 13S R 17WE W

WELL LOG

Show all important zones of porosity and contents thereof; cored intervals, and all drill-stem tests, including depth interval tested, cushion used, time tool open, flowing and shut-in pressures, and recoveries.

SHOW GEOLOGICAL MARKERS, LOGS RUN, OR OTHER DESCRIPTIVE INFORMATION.

FORMATION DESCRIPTION, CONTENTS, ETC.	TOP	BOTTOM	NAME	DEPTH
Surface Soil & Post Rock	0	60		
Rock, Hard Sand Streaks & Shale	60	230		
Shale w/Sand Streaks	230	410		
Sand & Shale	410	450		
Sand	450	630		
Sand & Shale	630	732		
Sand	732	923		
Red Bed	923	1263		
Anhydrite	1263	1300		
Shale	1300	2188		
Shale & Lime	2188	2850		
Lime & Shale	2850	3089		
Lime	3089	3626		
Chert & Lime	3626	3636		
RTD		3636		

USE ADDITIONAL SHEETS, IF NECESSARY, TO COMPLETE WELL RECORD.

Date Received

Daphne E. Starn
Signature

Office Manager
Title

November 8, 1979
Date