

**WELL COMPLETION REPORT AND
DRILLER'S LOG**

S. 22 T. 13 R. 18 ^E/_W
Loc. 820' FSL & 780' FWL NW

API No. 15 — 051 — 21,911
County Number

County Ellis

Operator
J. B. Collins

Address
1007 Cody, Suite A Hays, Kansas 67601

Well No. #1 Lease Name Gross

Footage Location
820 feet from ~~HN~~ (S) line 780 feet from (E) (W) line

Principal Contractor Dreiling Oil, Inc. Geologist Lawrence F. Gray

Spud Date 2-6-80 Date Completed 2-13-80 Total Depth 3,660 P.B.T.D.

Directional Deviation Oil and/or Gas Purchaser

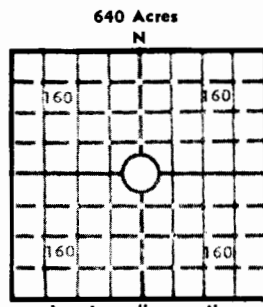

Elev.: Gr. 2079

DF 2081 KB 2084

CASING RECORD

Report of all strings set — surface, intermediate, production, etc.

| Purpose of string | Size hole drilled | Size casing set (in O.D.) | Weight lbs/ft. | Setting depth | Type cement | Sacks | Type and percent additives |
|-------------------|-------------------|---------------------------|----------------|---------------|-------------|-------|---|
| Surface pipe | 12 1/2 | 8 5/8 | | 1360 | common | 350 | 3% CC 2% Gel |
| Production | 7 7/8 | 5 1/2 | | 3659 | common | 150 | 8% Salt 4% Gilsonite .1 of 1% GDL |
| | | | | | | | |

LINER RECORD

PERFORATION RECORD

| Top, ft. | Bottom, ft. | Sacks cement | Shots per ft. | Size & type | Depth interval |
|----------|-------------|--------------|---------------|-------------|----------------|
| | | | | | |

TUBING RECORD

| Size | Setting depth | Packer set at |
|------|---------------|---------------|
| | | |

ACID, FRACTURE, SHOT, CEMENT SQUEEZE RECORD

| Amount and kind of material used | Depth interval treated |
|----------------------------------|------------------------|
| | |
| | |
| | |

INITIAL PRODUCTION

| | | | | | |
|--|---|-----|-----------------------|---------------|--|
| Date of first production | Producing method (flowing, pumping, gas lift, etc.) | | | | |
| RATE OF PRODUCTION PER 24 HOURS | Oil | Gas | Water | Gas-oil ratio | |
| | bbls. | MCF | bbls. | CFPB | |
| Disposition of gas (vented, used on lease or sold) | | | Producing interval(s) | | |

INSTRUCTIONS: As provided in KCC Rule 82-2-125, within 90 days after completion of a well, one completed copy of this Drillers Log shall be transmitted to the State Geological Survey of Kansas, 4150 Monroe Street, Wichita, Kansas 67209. Copies of this form are available from the Conservation Division, State Corporation Commission, 245 No. Water, Wichita, Kansas 67202. Phone AC 316-522-2206. If confidential custody is desired, please note Rule 82-2-125. Drillers Logs will be on open file in the Oil and Gas Division, State Geological Survey of Kansas, Lawrence, Kansas 66044.

Operator John B. Collins DESIGNATE TYPE OF COMP.: OIL, GAS, DRY HOLE, SWDW, ETC.: oil

Well No. 1 Lease Name Gross

S 22 T 13 R 18 ^E_W

WELL LOG

Show all important zones of porosity and contents thereof; cored intervals, and all drill-stem tests, including depth interval tested, cushion used, time tool open, flowing and shut-in pressures, and recoveries.

SHOW GEOLOGICAL MARKERS, LOGS RUN, OR OTHER DESCRIPTIVE INFORMATION.

| FORMATION DESCRIPTION, CONTENTS, ETC. | TOP | BOTTOM | NAME | DEPTH |
|---------------------------------------|------|--------|------|-------|
| Post Rock | 0 | 65 | | |
| Shale | 65 | 612 | | |
| Shale | 612 | 813 | | |
| Sand | 813 | 960 | | |
| Red Bed | 960 | 1165 | | |
| Red Bed & Shale | 1165 | 1349 | | |
| Anhydrite | 1349 | 1394 | | |
| Shale | 1394 | 2182 | | |
| Shale & Lime | 2182 | 2539 | | |
| Lime & Shale | 2539 | 2800 | | |
| Lime & Arbuckle | 2800 | 3660 | | |
| | 3660 | T.D. | | |

USE ADDITIONAL SHEETS, IF NECESSARY, TO COMPLETE WELL RECORD.

Date Received _____

John B. Collins
Signature

Operator
Title

3-13-80
Date

