

15-001-21477

*State Geological Survey*  
**WICHITA BRANCH**  
**KANSAS DRILLERS LOG**

API No. 15 — 051 — 21,449  
 County Number

S. 1 T. 13 R. 18 <sup>E</sup>/<sub>W</sub>  
 Loc. NE NW NE  
 County Ellis

Operator  
Karst Bros

Address  
Box 208 Russell, Kansas 67665

Well No. #1 Lease Name Staab

Footage Location  
330 feet from (N) (S) line 990 feet from (W) line

Principal Contractor Duke Dring Co. Geologist J. R. Green

Spud Date 2-23-78 Total Depth 3695 P.B.T.D. 3641

Date Completed 3-28-78 Oil Purchaser Koch

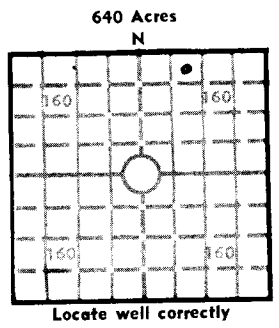

Elev.: Gr. 2066  
 DF 2069 KB 2071

**CASING RECORD**

Report of all strings set— surface, intermediate, production, etc.

Purpose of string	Size hole drilled	Size casing set (in O.D.)	Weight lbs/ft.	Setting depth	Type cement	Sacks	Type and percent additives
Surface	12 1/4"	8 5/8	28 <sup>z</sup>	264'	Common 10% salt	135	3% CAL-CAL.
Long String	7 7/8"	5 1/2	14 <sup>z</sup>	3662'	Common	200	10% salt

**LINER RECORD**

**PERFORATION RECORD**

Top, ft.	Bottom, ft.	Sacks cement	Shots per ft.	Size & type	Depth interval
			4	3/8"	3633 - 3631
			4	3/8"	3623 - 3621
			4	3/8"	3613 - 3610
			4	3/8"	3361 - 3362
			4	3/8"	3341 - 3338

**TUBING RECORD**

**ACID, FRACTURE, SHOT, CEMENT SQUEEZE RECORD**

Amount and kind of material used	Depth interval treated
Acid M.O.D. 202 - 250 Gal Arbuckle	3633 To 3610
Acid Regular 15% 1000 Gal Kansas City	3367 To 3362.

**INITIAL PRODUCTION**

Date of first production 4-5-78 Producing method (flowing, pumping, gas lift, etc.) Pumping

RATE OF PRODUCTION PER 24 HOURS  
 Oil 39.54 bbls. Gas NIL Water 13.98 MCF Gas-oil ratio NIL CFPB

Disposition of gas (vented, used on lease or sold) \_\_\_\_\_ Producing interval(s) \_\_\_\_\_

INSTRUCTIONS: As provided in KCC Rule 82-2-125, within 90 days after completion of a well, one completed copy of this Drillers Log shall be transmitted to the State Geological Survey of Kansas, 4150 Monroe Street, Wichita, Kansas 67209. Copies of this form are available from the Conservation Division, State Corporation Commission, 3830 So. Meridian (P.O. Box 17027), Wichita, Kansas 66217. Phone AC 316-522-2206. If confidential custody is desired, please note Rule 82-2-125. Drillers Logs will be on open file in the Oil and Gas Division, State Geological Survey of Kansas, Lawrence, Kansas 66044.

Operator Karst Bros		DESIGNATE TYPE OF COMP.: OIL, GAS, DRY HOLE, SWDW, ETC.:
Well No. 1	Lease Name <del>KARST</del> Staab	Oil
S 1 T 13 R 18 E W		

**WELL LOG**

Show all important zones of porosity and contents thereof; cored intervals, and all drill-stem tests, including depth interval tested, cushion used, time tool open, flowing and shut-in pressures, and recoveries.

SHOW GEOLOGICAL MARKERS, LOGS RUN, OR OTHER DESCRIPTIVE INFORMATION.

FORMATION DESCRIPTION, CONTENTS, ETC.	TOP	BOTTOM	NAME	DEPTH
Topka	3054	923		
Hueber	3290	1219		
Toronto	3315	1244		
Lansing-K.C.	3337	1266		
K.C. Base	3507	1496		
Argochle	3587	1516		
Total Depth	3696	1625		
<p>Depths corrected to Great Guns R.A. Guard Log</p> <p>D.S.T. No. 1 3288-3360            Open 1 hr, rec. 660' 945            120' OCM, 120' MGO &amp; 180'            CGO, 30" IAP 300#                  30" FAP 292#            F.P. 65-225 #</p> <p>D.S.T. No. 2 3563-3608            Open 30 min, rec. 10' mud            all pressures 32 #</p>				

USE ADDITIONAL SHEETS, IF NECESSARY, TO COMPLETE WELL RECORD.

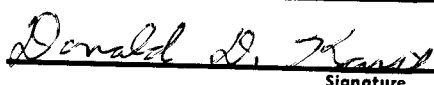
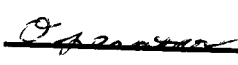
Date Received	 Signature
	 Title
	May 2 1978 Date