

Copy

WELL COMPLETION REPORT AND DRILLER'S LOG

S. 24 T. 13S R. 18 W

API No. 15 — 195 — 20,674
County Number

Loc. 50' W of NW SE NE

County Ellis

Operator
K & E Petroleum, Inc.

Address
816 Union Center Building, Wichita, KS 67202

Well No. #1 Lease Name KIPPES

Footage Location
1650 feet from (N) line 1040 feet from (E) line

Principal Contractor Abercrombie, Inc. Geologist Tom Satter

Spud Date 7/28/80 Date Completed 8/05/80 Total Depth 3713' P.B.T.D. 3593'

Directional Deviation Oil and/or Gas Purchaser

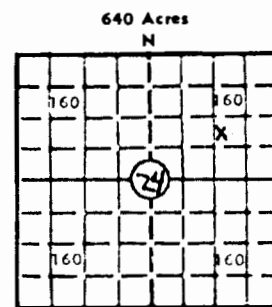

Locate well correctly
Elev.: Gr. 2128'
DF _____ KB 2133'

CASING RECORD

Report of all strings set — surface, intermediate, production, etc.

Purpose of string	Size hole drilled	Size casing set (in O.D.)	Weight lbs/ft.	Setting depth	Type cement	Sacks	Type and percent additives
Surface	12 1/4"	8 5/8"	20#	574.50'	50/50 posmix	150	2% gel. 3% c.c.
Production	7 7/8"	4 1/2"	10.5#	4037.83'	50/50 posmix	150	salt sat., 2% gel
			D.V.@	1369.96'	Lightweight	200	2% gel.

LINER RECORD

PERFORATION RECORD

Top, ft.	Bottom, ft.	Sacks cement	Shots per ft.	Size & type	Depth interval
			4	1/2" SSB-DP	3475 1/2' - 3479 1/2'
			4	1/2" SSB-DP	3499' - 3505'
			4	1/2" SSB-DP	3519' - 3523'

ACID, FRACTURE, SHOT, CEMENT SQUEEZE RECORD

Amount and kind of material used	Depth interval treated
1,000 gal. 15% NE acid	3499' - 3505' & 3519' - 3523'

INITIAL PRODUCTION

Date of first production September 10, 1980 Producing method (flowing, pumping, gas lift, etc.) Pumping

RATE OF PRODUCTION PER 24 HOURS	Oil 77.93 bbls.	Gas MCF	Water 5.87 bbls.	Gas-oil ratio CFPB
---------------------------------	-----------------	---------	------------------	--------------------

Disposition of gas (vented, used on lease or sold) Producing interval(s) 3499' - 3505' & 3519' - 3523'

INSTRUCTIONS: As provided in KCC Rule 82-2-125, within 90 days after completion of a well, one completed copy of this Drillers Log shall be transmitted to the State Geological Survey of Kansas, 4150 Monroe Street, Wichita, Kansas 67209. Copies of this form are available from the Conservation Division, State Corporation Commission, 245 No. Water, Wichita, Kansas 67202. Phone AC 316-522-2206. If confidential custody is desired, please note Rule 82-2-125. Drillers Logs will be on open file in the Oil and Gas Division, State Geological Survey of Kansas, Lawrence, Kansas 66044.

Operator K & E Petroleum, Inc.		DESIGNATE TYPE OF COMP.: OIL, GAS, DRY HOLE, SWDW, ETC.:
Well No. #1	Lease Name Kippes	Oil Well
S 24 T 13S R 18 W		

WELL LOG

Show all important zones of porosity and contents thereof; cored intervals, and all drill-stem tests, including depth interval tested, cushion used, time tool open, flowing and shut-in pressures, and recoveries.

SHOW GEOLOGICAL MARKERS, LOGS RUN,
OR OTHER DESCRIPTIVE INFORMATION.

FORMATION DESCRIPTION, CONTENTS, ETC.	TOP	BOTTOM	NAME	DEPTH
			<u>ELECTRIC LOGS</u>	
Sand & Shale	0	1712		
Shale & Lime	1712	3713	Heebner	3381'
Rotary Total Depth		3713	Toronto	3402'
			Lansing	3429'
			B/KC	3658'
			Conglomerate	3694'
			ELTD	3713'
DST #1 (Straddle) (3594'-3644')				
30/30/30/30 Recovered 2' mud.				
FP's 44#/44#/44#/44#/44#; SIP's 55#/44#				
DST #2 (Straddle) (3464'-3512')				
30/45/30/60 Recovered 600' fluid				
120' HO & GCM, 60' VHO & GCM, 420' MGCO				
FP's 121#/243#-243#/265#				
SIP's 1002#-914# and building.				
DST #3 (Straddle) (3408'-3463')				
30/45/30/60 Recovered 230' fluid				
80' HO & GCM, 120' MGCO, 30' froggy MO				
FP's 55#/110#-132#/143# SIP's 837#-760#				
SAMPLE TOPS:				
		Anhydrite	1363'	
		B/Anhydrite	1405'	

Spud hole at 5:00 p.m. 07-28-80. Drilled 578' of a 12-1/4" hole. Ran 15 joints of 8-5/8" - 20# casing (tally 568'). Set at 574.50'. Cemented with 150 sx. of 50/50 posmix, 2% gel, 3% c. Followed with 150 sx. of common, 2% gel, 3% c.c. Plug was down at 5:30 a.m. 07-28-80. Cement did circulate.

T.D. 3713'. Ran 89 joints of 4-1/2" - 10-1/2# casing (tally 3695.77'). Set at 3699.77'. Cemented with 150 sx. of 50/50 posmix salt saturated. Ran 20 barrels salt flush ahead of cement followed with 200 sx. of light 2% gel. Cement by Sun Cementing. Plug was down at 3:00 p.m. 08-05-80.

USE ADDITIONAL SHEETS, IF NECESSARY, TO COMPLETE WELL RECORD.

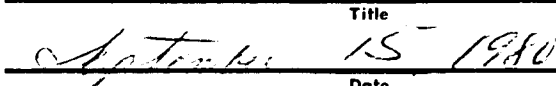
Date Received	 Wayne L. Brinegar Vice President
	Title  Date