

KANSAS DRILLERS LOG

S. 31 T. 13 R. 19 ^RW
Loc. 840' FNL & 2440' FWL NW
County Ellis

API No. 15 — 051 — 21,198
County Number

Operator
Sid Tomlinson

Address
Box 594 Twin Falls, Idaho 83301

Well No. #3 Lease Name Riedel

Footage Location
840 feet from (N) line 2440 feet from (W) line NW/4

Principal Contractor Revlin Drllg. Geologist J.E. Jespersen

Spud Date 7-1-76 Total Depth 4080 P.B.T.D. 4080

Date Completed 7-11-76 Oil Purchaser

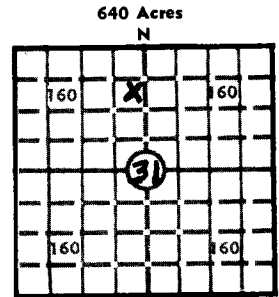

640 Acres N
Locate well correctly
Elev.: Gr. 2224
DF — KB 2229

CASING RECORD

Report of all strings set — surface, intermediate, production, etc.

| Purpose of string | Size hole drilled | Size casing set (in O.D.) | Weight lbs/ft. | Setting depth | Type cement | Sacks | Type and percent additives |
|---|-------------------|---------------------------|----------------|---------------|-------------|-------|----------------------------|
| SURFACE | 12 1/4 | 8 5/8 | 28 | 249 | Reg. | 140 | 3% CaCl |
| * DISPOSAL | 7 7/8 | 5 1/2 | 14 | 3932 | POZ | 125 | 18% SALT 34% CFR-2 |
| * CEMENTED TOP OF 5 1/2 CSG. THRU STAGE COLLAR @ 1540' WITH 325 SX. POZ + 4% GEL. | | | | | | | |

LINER RECORD

PERFORATION RECORD

| Top, ft. | Bottom, ft. | Sacks cement | Shots per ft. | Size & type | Depth interval |
|----------------------------|--------------------|---------------|---------------|-------------|----------------|
| TUBING RECORD (FIBERGLASS) | | | | | |
| Size 2 1/2" | Setting depth 3912 | Packer set at | | | |

ACID, FRACTURE, SHOT, CEMENT SQUEEZE RECORD

| Amount and kind of material used | Depth interval treated |
|----------------------------------|------------------------|
| 500 GALS 15% N.E. ACID | 3932 - 4080 |

INITIAL PRODUCTION

| | |
|--|---|
| Date of first production | Producing method (flowing, pumping, gas lift, etc.) |
| RATE OF PRODUCTION PER 24 HOURS | Oil bbls. Gas MCF Water bbls. Gas-oil ratio CFPB |
| Disposition of gas (vented, used on lease or sold) | Producing interval (s) |

INSTRUCTIONS: As provided in KCC Rule 82-2-125, within 90 days after completion of a well, one completed copy of this Drillers Log shall be transmitted to the State Geological Survey of Kansas, 4150 Monroe Street, Wichita, Kansas 67209. Copies of this form are available from the Conservation Division, State Corporation Commission, 3830 So. Meridian (P.O. Box 17027), Wichita, Kansas 66217. Phone AC 316-522-2206. If confidential custody is desired, please note Rule 82-2-125. Drillers Logs will be on open file in the Oil and Gas Division, State Geological Survey of Kansas, Lawrence, Kansas 66044.

Operator Sid TOMLINSON

DESIGNATE TYPE OF COMP.: OIL, GAS, DRY HOLE, SWDW, ETC.:

Well No. 3

Lease Name RIEDEL

SWDW

S 31 T 13 R 19 W

WELL LOG

Show all important zones of porosity and contents thereof; cored intervals, and all drill-stem tests, including depth interval tested, cushion used, time tool open, flowing and shut-in pressures, and recoveries.

SHOW GEOLOGICAL MARKERS, LOGS RUN, OR OTHER DESCRIPTIVE INFORMATION.

| FORMATION DESCRIPTION, CONTENTS, ETC. | TOP | BOTTOM | NAME | DEPTH |
|--|-----|--------------|---------------------------|-------|
| DST #1 3862-69 (ARBUCKLE) TEST FAILED | | | | |
| DST #2 3862-3874 (ARBUCKLE) 30/30/30/30 Recovered 100' MUD. 15IP 727 # FSIP 484 # | | | | |
| Dresser Ran Cased Hole Gamma Ray/Neutron Log | | | | |
| | | | <u>Electric Log Tops:</u> | |
| | | | ANHYDRITE | 1518 |
| | | | HEEBNER | 3479 |
| | | | LANSING | 3522 |
| | | | BASE LKC | 3771 |
| | | Reworked | ARBUCKLE | 3860 |
| | | | ARBUCKLE | 3886 |
| | | | <hr/> | |
| | | SAMPLE TOP - | GRANITE WASH | 4038 |
| | | | TD | 4080 |

USE ADDITIONAL SHEETS, IF NECESSARY, TO COMPLETE WELL RECORD.

Date Received

Sid Tomlinson
Signature

OPERATOR

Title

7/29/76

Date