

State Geological Survey
WICHITA, BRANCH

KANSAS DRILLERS LOG

S. 26 T. 13 R. 20 ^RW

Loc. NE SE SE

County Ellis

API No. 15 — 051 — 21,186
County Number

Operator

Black-Stem Investors

Address

Catherine Route, Box 39 Nays, Kansas 67601

Well No.

#1

Lease Name

Herman Estate

Footage Location

330 feet from (N) (S) line 330 feet from (E) (W) line

Principal Contractor

Rains & Williamson

Geologist

Don Moore

Spud Date

5-21-76

Total Depth

3808 KB

P.B.T.D.

3808

Date Completed

5-29-76

Oil Purchaser

Cities Service

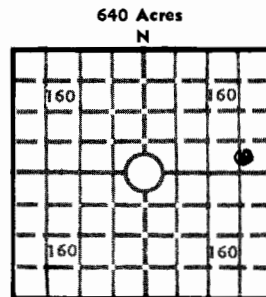

Locate well correctly

Elev.: Gr. 2156

DF 2159 KB 2161

CASING RECORD

Report of all strings set — surface, intermediate, production, etc.

Purpose of string	Size hole drilled	Size casing set (in O.D.)	Weight lbs/ft.	Setting depth	Type cement	Sacks	Type and percent additives
Surface	9 3/4	8 5/8	18.6 lb/ft	218 ft	Bulk	105	396 lbs Ca Cl 45 sacks 244 lbs gel per sack
Production	9 3/4	4 1/2	10.5	3806	Common (Baker's) Tap	200 375	10% salt flush 50-50 Per 6% gel

LINER RECORD

Top, ft.	Bottom, ft.	Sacks cement
----------	-------------	--------------

PERFORATION RECORD

Shots per ft.	Size & type	Depth interval
4	Jet H.P.	3805-3808

TUBING RECORD

Size	Setting depth	Packer set at
2 3/8	3808	None

ACID, FRACTURE, SHOT, CEMENT SQUEEZE RECORD

Amount and kind of material used	Depth interval treated

INITIAL PRODUCTION

Date of first production	Pumping			
Producing method (flowing, pumping, gas lift, etc.)				
RATE OF PRODUCTION PER 24 HOURS	Oil	Gas	Water	Gas-oil ratio
	bbbls.	MCF	bbbls.	CFPB
Disposition of gas (vented, used on lease or sold)			Producing interval (s)	

INSTRUCTIONS: As provided in KCC Rule 82-2-125, within 90 days after completion of a well, one completed copy of this Drillers Log shall be transmitted to the State Geological Survey of Kansas, 4150 Monroe Street, Wichita, Kansas 67209. Copies of this form are available from the Conservation Division, State Corporation Commission, 3830 So. Meridian (P.O. Box 17027), Wichita, Kansas 66217. Phone AC 316-522-2206. If confidential custody is desired, please note Rule 82-2-125. Drillers Logs will be on open file in the Oil and Gas Division, State Geological Survey of Kansas, Lawrence, Kansas 66044.

Operator <u>Black Stem Investors</u>		DESIGNATE TYPE OF COMP.: OIL, GAS, DRY HOLE, SWDW, ETC.:	
Well No. <u>1</u>	Lease Name <u>Herman</u>	<u>oil</u>	
S <u>26</u> T <u>13</u> R <u>20</u> E W			
WELL LOG Show all important zones of porosity and contents thereof; cored intervals, and all drill-stem tests, including depth interval tested, cushion used, time tool open, flowing and shut-in pressures, and recoveries.		SHOW GEOLOGICAL MARKERS, LOGS RUN, OR OTHER DESCRIPTIVE INFORMATION.	
FORMATION DESCRIPTION, CONTENTS, ETC.	TOP	BOTTOM	NAME
Arb	3802	3808	Arb
Lansing	3444	3687	K C
USE ADDITIONAL SHEETS, IF NECESSARY, TO COMPLETE WELL RECORD.			
Date Received	<u>Black Stem Investors</u> <u>Francis C. Maab</u>		
	Title <u>June 25 - 76</u> Date		