

KANSAS

WELL COMPLETION REPORT AND
DRILLER'S LOGState Geological Survey
WICHITA BRANCHAPI No. 15 — 051 — 22-589
County NumberS. 30 T. 13S R. 20 W
Loc. 1650' FNL & 990' FWL
County EllisOperator
TXO Production Corp.Address
200 W. Douglas, Ste. 300, Wichita, KS 67202

Well No. #1 Lease Name Weber "A"

Footage Location
1650' feet from (N) XX line 990' feet from (E) (W) line

Principal Contractor Kandrilco Geologist Prof. Well Logging

Spud Date 9-13-81 Date Completed 10-4-81 Total Depth 4005 P.B.T.D. N/A

Directional Deviation Not directionally drilled Oil and/or Gas Purchaser N/A

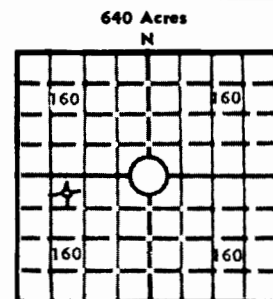
Locate well correctly
Elev.: Gr. 2284
DF KB 2292

CASING RECORD

Report of all strings set — surface, intermediate, production, etc.

Purpose of string	Size hole drilled	Size casing set (in O.D.)	Weight lbs/ft.	Setting depth	Type cement	Sacks	Type and percent additives
Surface	12½	8-5/8"	23#	249'	K-55	150 sxs	lite wt
						100 sxs	common 2% gel, 3% CaCl

LINER RECORD

PERFORATION RECORD

Top, ft.	Bottom, ft.	Sacks cement	Shots per ft.	Size & type	Depth interval
N/A	N/A	N/A	N/A	N/A	N/A
TUBING RECORD					
Size	Setting depth	Packer set at			
N/A	N/A	N/A			

ACID, FRACTURE, SHOT, CEMENT SQUEEZE RECORD

Amount and kind of material used	Depth interval treated
N/A	N/A

INITIAL PRODUCTION

Date of first production		Producing method (flowing, pumping, gas lift, etc.)			
D & A, 10-4-81		dry			
RATE OF PRODUCTION PER 24 HOURS	Oil	Gas	Water	Gas-oil ratio	
	N/A bbls.	N/A MCF	N/A bbls.	N/A	CFPB
Disposition of gas (vented, used on lease or sold)			Producing interval(s)		
dry			N/A		

INSTRUCTIONS: As provided in KCC Rule 82-2-125, within 90 days after completion of a well, one completed copy of this Drillers Log shall be transmitted to the State Geological Survey of Kansas, 4150 Monroe Street, Wichita, Kansas 67209. Copies of this form are available from the Conservation Division, State Corporation Commission, 245 No. Water, Wichita, Kansas 67202. Phone AC 316-522-2206. If confidential custody is desired, please note Rule 82-2-125. Drillers Logs will be on open file in the Oil and Gas Division, State Geological Survey of Kansas, Lawrence, Kansas 66044.

FIELD: Kaiser

Operator TXO Production Corp.		DESIGNATE TYPE OF COMP.: OIL, GAS, DRY HOLE, SWDW, ETC.: D & A	
Well No. #1	Lease Name Weber "A"		
S <u>30</u> T <u>13S</u> R <u>20</u> W <u>X</u>			
WELL LOG <small>Show all important zones of porosity and contents thereof; cored intervals, and all drill-stem tests, including depth interval tested, cushion used, time tool open, flowing and shut-in pressures, and recoveries.</small>		SHOW GEOLOGICAL MARKERS, LOGS RUN, OR OTHER DESCRIPTIVE INFORMATION.	
FORMATION DESCRIPTION, CONTENTS, ETC.	TOP	BOTTOM	NAME
LOG TOPS Herington Cottonwood Tarkio Howard Topeka Heebner L. Kansas City B. Kansas City Marmaton Arbuckle RTD LTD	2312 2780 3128 3241 3294 3547 3586 3836 3894 3968 4005 3999	-20 -488 -836 -949 -1002 -1255 -1294 -1544 -1602 -1676	
Ran O.H. Logs			
DST #1, 3959-3980' (Arbuckle), w/results as follows:			
IFP/30": 108-116# ISIP/60": 1361# FFP/30 & FSIP/60": tool plugging Rec: 134' DM			
USE ADDITIONAL SHEETS, IF NECESSARY, TO COMPLETE WELL RECORD.			
Date Received	<div style="text-align: center;">  Harold R. Trapp District Geologist </div>		
	<div style="text-align: center;"> Signature <hr/> Title <hr/> October 5, 1981 <hr/> Date <hr/> </div>		