

State Geological Survey

WICHITA BRANCH KANSAS DRILLERS LOG

API No. 15 — 051 — 21,303
County Number

Operator
Rupe Oil Company, Inc.

Address
P. O. Box 2273, Wichita, Kansas 67201

Well No. 2 Lease Name BOOS 'A'

Footage Location
330 feet from (N) line 540 feet from (W) line

Principal Contractor Red Tiger Drilling Drilling Company Geologist William G. Clement

Spud Date March 17, 1977 Total Depth 3935' P.B.T.D.

Date Completed June 1, 1977 Oil Purchaser

S. 32 T. 13S R. 20 W
Loc. 210' E of NW SW SE
County Ellis

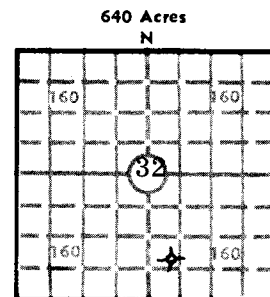

Locate well correctly
Elev.: Gr. 2298'
DF KB 2303'

CASING RECORD

Report of all strings set — surface, intermediate, production, etc.

Purpose of string	Size hole drilled	Size casing set (in O.D.)	Weight lbs/ft.	Setting depth	Type cement	Sacks	Type and percent additives
Surface	1 2 1/4"	8 5/8"	24#	285'	Common	175	2% Gel, 3% Calcium Chloride
Production	7 7/8"	4 1/2"	17#	3934'	50-50 Pozmix	100	Salt Saturated
		DVTool at 1675'			50-50 Pozmix	300	

LINER RECORD

Top, ft.	Bottom, ft.	Sacks cement
----------	-------------	--------------

PERFORATION RECORD

Shots per ft.	Size & type	Depth interval
---------------	-------------	----------------

TUBING RECORD

Size	Setting depth	Packer set at
------	---------------	---------------

ACID, FRACTURE, SHOT, CEMENT SQUEEZE RECORD

Amount and kind of material used	Depth interval treated
----------------------------------	------------------------

INITIAL PRODUCTION

Date of first production Producing method (flowing, pumping, gas lift, etc.)

RATE OF PRODUCTION PER 24 HOURS	Oil bbls.	Gas MCF	Water bbls.	Gas-oil ratio CFPB
---------------------------------	-----------	---------	-------------	--------------------

Disposition of gas (vented, used on lease or sold) Producing interval (s)

INSTRUCTIONS: As provided in KCC Rule 82-2-125, within 90 days after completion of a well, one completed copy of this Drillers Log shall be transmitted to the State Geological Survey of Kansas, 4150 Monroe Street, Wichita, Kansas 67209. Copies of this form are available from the Conservation Division, State Corporation Commission, 3830 So. Meridian (P.O. Box 17027), Wichita, Kansas 66217. Phone AC 316-522-2206. If confidential custody is desired, please note Rule 82-2-125. Drillers Logs will be on open file in the Oil and Gas Division, State Geological Survey of Kansas, Lawrence, Kansas 66044.

Operator Rupe Oil Company, Inc. DESIGNATE TYPE OF COMP.: OIL, GAS, DRY HOLE, SWDW, ETC.: Temporary Abandoned

Well No. 2 Lease Name Boos 'A'

S 32 T 13 S 20 R W

WELL LOG

Show all important zones of porosity and contents thereof; cored intervals, and all drill-stem tests, including depth interval tested, cushion used, time tool open, flowing and shut-in pressures, and recoveries.

SHOW GEOLOGICAL MARKERS, LOGS RUN, OR OTHER DESCRIPTIVE INFORMATION.

FORMATION DESCRIPTION, CONTENTS, ETC.	TOP	BOTTOM	NAME	DEPTH
DST #1 - 3900' - 35' 30"-45"-60"-45" Fair blow, rec. 40' GIP; 10' free Gassy Oil; 310' OC Mud. ISIP 1145# IFP 21-52# FFP 94-126# FSIP 1125# T. - 120° No Log			Anhydrite Topeka Heebner Marmaton Reagan	1609' 3299' 3543' 3889' 3934'

USE ADDITIONAL SHEETS, IF NECESSARY, TO COMPLETE WELL RECORD.

Date Received

Rupe Oil Company, Inc.

William G. Clement

William G. Clement
Petroleum Geologist

July 4, 1977

Title

Date