

KANSAS *PT*

*State Geological Survey
WICHITA, BRANCH*

**WELL COMPLETION REPORT AND
DRILLER'S LOG**

API No. 15 — 195 — 20,780
County Number

S. 3 T. 13 R. 21 ^{XX} W
Loc. NW NW NW
County Trego

Operator
Southern States Oil Company

Address
P.O. Box 1365, Great Bend, Kansas 67530

Well No. 2 Lease Name Deutscher

Footage Location
330 feet from (N) (S) line 330 feet from (E) (W) line

Principal Contractor Future Drilling, Inc. Geologist Green & Green

Spud Date 4-1-81 Date Completed 4-9-81 Total Depth 3869' P.B.T.D.

Directional Deviation Oil and/or Gas Purchaser Clear Creek

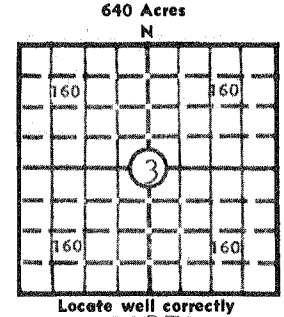

Locate well correctly
Elev.: Gr. 2207'
DF KB 2212'

CASING RECORD

Report of all strings set — surface, intermediate, production, etc.

Purpose of string	Size hole drilled	Size casing set (in O.D.)	Weight lbs/ft.	Setting depth	Type cement	Sacks	Type and percent additives
Surface	12 1/4"	8-5/8	24#	264'	Quick set Common	180	
Production	7-7/8"	5 1/2"	14#	3864'	Common	150	15bbl salt flush

LINER RECORD

PERFORATION RECORD

Top, ft.	Bottom, ft.	Sacks cement	Shots per ft.	Size & type	Depth interval
					none

TUBING RECORD

Size	Setting depth	Packer set at
2-7/8"	3864'	

ACID, FRACTURE, SHOT, CEMENT SQUEEZE RECORD

Amount and kind of material used	Depth interval treated
	natural

INITIAL PRODUCTION

Date of first production 4-25-81 Producing method (flowing, pumping, gas lift, etc.) pumping

RATE OF PRODUCTION PER 24 HOURS	Oil <u>30</u> bbls.	Gas <u>—</u> MCF	Water <u>trace</u> bbls.	Gas-oil ratio <u>—</u> CFPB
---------------------------------	---------------------	------------------	--------------------------	-----------------------------

Disposition of gas (vented, used on lease or sold) none Producing interval(s) Arbuckle

INSTRUCTIONS: As provided in KCC Rule 82-2-125, within 90 days after completion of a well, one completed copy of this Drillers Log shall be transmitted to the State Geological Survey of Kansas, 4150 Monroe Street, Wichita, Kansas 67209. Copies of this form are available from the Conservation Division, State Corporation Commission, 245 No. Water, Wichita, Kansas 67202. Phone AC 316-522-2206. If confidential custody is desired, please note Rule 82-2-125. Drillers Logs will be on open file in the Oil and Gas Division, State Geological Survey of Kansas, Lawrence, Kansas 66044.

Operator Southern States Oil Company
 DESIGNATE TYPE OF COMP.: OIL, GAS, DRY HOLE, SWDW, ETC.: Oil Well

Well No. 2 Lease Name Deutscher

S 3 T 13 R 21 X W

WELL LOG
 Show all important zones of porosity and contents thereof; cored intervals, and all drill-stem tests, including depth interval tested, cushion used, time tool open, flowing and shut-in pressures, and recoveries.
 SHOW GEOLOGICAL MARKERS, LOGS RUN, OR OTHER DESCRIPTIVE INFORMATION.

FORMATION DESCRIPTION, CONTENTS, ETC.	TOP	BOTTOM	NAME	DEPTH
Anhydrite	1578		L-K Wire Line ran an R/A Log from 3200' to 3870'	
Topeka	3238			
Heebner	3464			
Toronto	3484			
Lansing-Kansas City	3497			
Base Kansas City	3742			
Marmaton Chert	3802			
Arbuckle	3861	3861		
ROTARY TOTAL DEPTH	3869			
DST #1-3490-3570': IOP-45, ISI-30, FOP-45, FSI-30, IFP 59-99, FFP 128-148, ISIP-809, FSIP-860. Rec'd 233' water,				
DST #2-3569-3590': IOP-45, ISI-30, FOP-45, FSI-30, IFP 29-39, FFP 59-59, ISIP-870, FSIP-820. Rec'd 90' total fluid, 1' free oil, 89' waterw/skum of oil,				
DST #3-3840-3869': IOP-45, ISI-30, FOP-45, FSI-30, IFP 39-69, FFP 99-119, ISIP-1007, FSIP-978. Rec'd 10' free oil 230' Frosing oil,				
RECOMMENDATION: It was recommended and confirmed by all parties to set pipe and test the Arbuckle open hole. The Marmaton Chert section should be tested at some later date or before abandoning well.				

USE ADDITIONAL SHEETS, IF NECESSARY, TO COMPLETE WELL RECORD.

Date Received _____
 Signature Claude B. Bakerby
 Title Gen. Supt.
 Date May 13, 1981