

KANSAS

WELL COMPLETION REPORT AND
DRILLER'S LOG

State Geological Survey
WICHITA BRANCH

API No. 15 — 195 — 20,721
County Number

S. 7 T. 13 R. 21 ~~XX~~ W
Loc. 100' N.NW NW SW
County Trego

Operator
Gear Petroleum Co., Inc.

Address
300 Sutton Place, Wichita, Kansas 67202

Well No. 4 Lease Name Herl

Footage Location
220 feet from (N) line 330 feet from (W) line

Principal Contractor Red Tiger Drilling Co. Geologist Frosty Cox

Spud Date 11-4-80 Date Completed 11-12-80 Total Depth 4005 P.B.T.D. 3981

Directional Deviation Oil and/or Gas Purchaser Koch Oil Co.

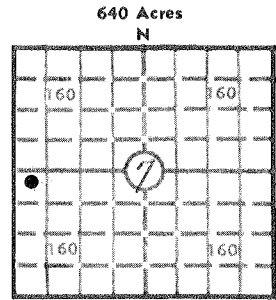

Locate well correctly
Elev.: Gr. 2221
DF KB 2226

CASING RECORD

Report of all strings set — surface, intermediate, production, etc.

Purpose of string	Size hole drilled	Size casing set (in O.D.)	Weight lbs/ft.	Setting depth	Type cement	Sacks	Type and percent additives
Surface	12 1/4"	8 5/8		207.82	Quick Set	150	None
		4'		3981	Common	200	10% Salt

LINER RECORD

PERFORATION RECORD

Top, ft.	Bottom, ft.	Sacks cement	Shots per ft.	Size & type	Depth interval
			3		3908-3914

TUBING RECORD

Size	Setting depth	Packer set at
2"	3900	

ACID, FRACTURE, SHOT, CEMENT SQUEEZE RECORD

Amount and kind of material used	Depth interval treated
500 gals BDA; Frac. w/10,000# 20-40 Sand	3908-3914

INITIAL PRODUCTION

Date of first production 1/24/81 Producing method (flowing, pumping, gas lift, etc.) Pumping

RATE OF PRODUCTION PER 24 HOURS	Oil	Gas	Water	Gas-oil ratio
	60	None	2	

Disposition of gas (vented, used on lease or sold) Producing interval (s) 3908-14

INSTRUCTIONS: As provided in KCC Rule 82-2-125, within 90 days after completion of a well, one completed copy of this Drillers Log shall be transmitted to the State Geological Survey of Kansas, 4150 Monroe Street, Wichita, Kansas 67209. Copies of this form are available from the Conservation Division, State Corporation Commission, 245 No. Water, Wichita, Kansas 67202. Phone AC 316-522-2206. If confidential custody is desired, please note Rule 82-2-125. Drillers Logs will be on open file in the Oil and Gas Division, State Geological Survey of Kansas, Lawrence, Kansas 66044.

Operator
Gear Petroleum Co., Inc.

DESIGNATE TYPE OF COMP.: OIL, GAS,
DRY HOLE, SWDW, ETC.:

Well No. 4 Lease Name Herl Oil

S 7 T 13 R 21 ^{EX} W

WELL LOG

Show all important zones of porosity and contents thereof; cored intervals, and all drill-stem tests, including depth interval tested, cushion used, time tool open, flowing and shut-in pressures, and recoveries.

SHOW GEOLOGICAL MARKERS, LOGS RUN,
OR OTHER DESCRIPTIVE INFORMATION.

FORMATION DESCRIPTION, CONTENTS, ETC.	TOP	BOTTOM	NAME	DEPTH
DST #1 30-45-60-60 Rec. 125' HOCM (60% oil) FP 73-73, 73-82, SIP 623-385	4904	3940	LOG TOPS	
			Anhydrite	1656 +570
			B/Anhydrite	1700 +526
			Heebner	3534 -1308
			Toronto	3550 -1324
			Lansing	3566 -1340
			B/KC	3806 -1580
			Marmaton	3894 -1668
			Conglom.	3953 -1727
			Arbuckle	3992 -1766
			LTD	3998 -1772
			RTD	4005 -1779

USE ADDITIONAL SHEETS, IF NECESSARY, TO COMPLETE WELL RECORD.

Date Received

 Jim Thatcher Signature
 Engineer
 Title
 5/28/81
 Date