

STATE CORPORATION COMMISSION OF KANSAS
OIL & GAS CONSERVATION DIVISION

WELL COMPLETION OR RECOMPLETION FORM
ACC-1 WELL HISTORY

DESCRIPTION OF WELL AND LEASE

Operator: License # 5088
Name John Jay Darrah, Jr.
Address 412 E. Douglas, Ste. One
City/State/Zip Wichita, Ks. 67202

Purchaser Derby Refining Company
Wichita, Kansas

Operator Contact Person Dorene K. Dunn
Phone 316/263-2243

Contractor: License # 4630
Name Mallard Drilling

Wellsite Geologist Beth A. Fuhr
Phone 316/263-2243

Designate Type of Completion

- New Well
- Re-Entry
- Workover
- Oil
- Gas
- Dry
- SWD
- Inj
- Other (Core, Water Supply etc.)
- Temp Abd
- Delayed Comp.

If OWWO: old well info as follows:

Operator
Well Name
Comp. Date Old Total Depth

WELL HISTORY

Drilling Method:

- Mud Rotary
- Air Rotary
- Cable

1-10-86	1-18-86	2-10-86
Start Date	Date Reached TD	Completion Date
3900	3883	
Total Depth	PBTD	

Amount of Surface Pipe Set and Cemented at 5 jts 219.07 feet

Multiple Stage Cementing Collar Used? Yes No

If yes, show depth set.....feet

If alternate 2 completion, cement circulated from 3899 feet depth to surf w/ 400 SX cmt

API NO. 15-195-21,839

County Trego

S/2 S/2 Sec 11 Twp 13S Rge 21 East West

660 Ft North from Southeast Corner of Section
2640 Ft West from Southeast Corner of Section
(Note: Locate well in section plat below)

Lease Name Hamburg Well # 6

Field Name

Producing Formation Arbuckle

Elevation: Ground 2157 2165 KB

Section Plat

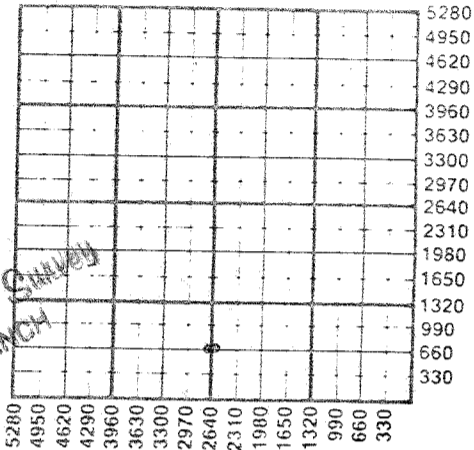

FEB 25 1986
State Geological Survey
WICHITA BRANCH

WATER SUPPLY INFORMATION

Disposition of Produced Water: Disposal Repressuring
Docket # D-22,358

Questions on this portion of the ACC-1 call:
Water Resources Board (913) 296-3717

Source of Water:
Division of Water Resources Permit #

Groundwater.....Ft North from Southeast Corner (Well)Ft West from Southeast Corner of Sec Twp Rge East West

Surface Water.....Ft North from Southeast Corner (Stream, pond etc).....Ft West from Southeast Corner Sec Twp Rge East West

Other (explain) Purchased - Wellbrock's Tank Service Wakeeney, Kansas (purchased from city, R.W.D. #)

INSTRUCTIONS: This form shall be completed in duplicate and filed with the Kansas Corporation Commission, 200 Colorado Derby Building, Wichita, Kansas 67202, within 90 days after completion or recompletion of any well. Rule 82-3-130 and 82-3-107 apply.

Information on side two of this form will be held confidential for a period of 12 months if requested in writing and submitted with the form. See rule 82-3-107 for confidentiality in excess of 12 months. One copy of all wireline logs and drillers time log shall be attached with this form. Submit CP-4 form with all plugged wells. Submit CP-111 form with all temporarily abandoned wells.

All requirements of the statutes, rules and regulations promulgated to regulate the oil and gas industry have been fully complied with and the statements herein are complete and correct to the best of my knowledge.

Signature John Jay Darrah, Jr.
Title Operator Date 2/19/86

Subscribed and sworn to before me this 19th day of February 1986
Notary Public Dorene K. Dunn

Date Commission Expires October 13, 1989



K.C.C. OFFICE USE ONLY

F Letter of Confidentiality Attached

C Wireline Log Received

C Drillers Timelog Received

Distribution

KCC SWD/Rep NGPA

KGS Plug Other (Specify)

RECEIVED STATE CORPORATION COMMISSION

FEB 24 1986

CONSERVATION DIVISION

Form ACC-1 (7-84)

Sec. 11 Twp. 13 Rge. 21W

Operator Name John Jay Darrah, Jr. Lease Name Hamburg Well # 6

Sec. 11 Twp. 13S Rge. 21 County Trego

East
 West

WELL LOG

INSTRUCTIONS: Show important tops and base of formations penetrated. Detail all cores. Report all drill stem tests giving interval tested, time tool open and closed, flowing and shut-in pressures, whether shut-in pressure reached static level, hydrostatic pressures, bottom hole temperature, fluid recovery, and flow rates if gas to surface during test. Attach extra sheet if more space is needed. Attach copy of log.

Drill Stem Tests Taken Yes No
Samples Sent to Geological Survey Yes No
Cores Taken Yes No

Formation Description
 Log Sample

DST #1, 3197-3247'; 30/30/45/45; weak to air blow both openings. Rec. 330' muddy water show of oil. IFP 68-118#; FFP 147-177#; SIP 867#; FSIP 867#.
DST #2, 3740-3540'; 30/15, flushed tool, no help. 1st open-very weak surf. blow. 2nd open w died in 10 min. IHP 58-68#; ISIP 177#; FFP 8-78#; FSIP N/A
DST #3, 3775-3820'; 30/30/45/45, weak to air 7" blow both openings. Rec: 120' gas in pipe, 130' clean oil, 180' muddy oil, IFP 68-118#; FFP 127-147#; ISIP 768#; FSIP 749#
DST #4, 3803-3855'. 30/30/30/30. Strong low both openings. Rec 120' gas in pipe; 660' mud c oil (50% oil); IFP 127-226#; FFP 265-205#; ISIP 1105#; FSIP 1025#

Name	Top	Subsea Bottom
Anhy	1525	+ 641
B/Anhy	1570	+ 593
Topeka	3193	-1028
Heebner	3424	-1259
Lansing	3461	-1296
B/KC	3700	-1535
Marmaton	3767	-1602
Arbuckle	3820	-1655
LTD	3899	-1734

CASING RECORD New Used

Report all strings set-conductor, surface, intermediate, production, etc.

Purpose of String	Size Hole Drilled	Size Casing Set (in O.D.)	Weight Lbs/Ft.	Setting Depth	Type of Cement	#Sacks Used	Type and Percent Additives
Surf (used)		8-5/8"	20	219.07	60/40 poz	145	3% cc; 2% gel
Prod (used)		5-1/2"	14#	3899'	Econolite	250	1/2 Flocele, 38 t
and (used)		5-1/2"	15-1/2#		mud spacer and	150	sx 60/40
pozmix, 2% gel, 10% salt, 3/4% CRF-2. Cement did circulate Job by Halliburton							

Shots Per Foot	Specify Footage of Each Interval Perforated	Acid, Fracture, Shot, Cement Squeeze Record (Amount and Kind of Material Used)	Depth
10 total	3827-3842' (open hole measure)	1,000 gals... 20% Reg... Acid... Max press... 850#... 2 Bbls/minute... Doc squeeze w/ 7 sxs cmt in oil @ 3820-3850'	

TUBING RECORD Size Set At Packer at Liner Run Yes No

Date of First Production Producing Method Flowing Pumping Gas Lift Other (explain).....

Estimated Production Per 24 Hours	Oil Bbls	Gas MCF	Water Bbls	Gas-Oil Ratio	Gravity
	30		160		

METHOD OF COMPLETION

Production Interval

Disposition of gas: Vented Soid Used on Lease Open Hole Perforation Other (Specify)..... Dually Completed Comingled

3830-58

HALLIBURTON SERVICES
JOB SUMMARY

Hamburg Moys. Ks.
#6
SEC. 11 TWP. 13 RANG. 21 COUNTY Ell. STATE Ks.

15-196-21839
BILLED ON 077365
TICKET NO.

WELL DATA

FORMATION NAME	TYPE	NEW USED	WEIGHT	SIZE	FROM	TO	MAXIMUM P. ALLOWABLE
FORMATION THICKNESS	FROM TO	CASING	11	5 1/2	13	2859	
INITIAL PROD. OIL	BPD, WATER	BPD, GAS	MCPD	LINER			
PRESENT PROD. OIL	BPD, WATER	BPD, GAS	MCPD	TUBING			
COMPLETION DATE	MUD TYPE	MUD WT.	OPEN HOLE				SHOTS/FT.
PACKER TYPE	SET AT		PERFORATIONS				
BOTTOM HOLE TEMP.	PRESSURE		PERFORATIONS				
LOG DATA	TOTAL DEPTH 3900		PERFORATIONS				

TOOLS AND ACCESSORIES

TYPE AND SIZE	QTY.	MAKE
COAT COLLAR 5/8"	1	Hawsco
COAT SHOE		
GUIDE SHOE 5/8" Reg	1	Hawsco
CENTRALIZERS 5/8" S-38"	4	Hawsco
BOTTOM PLUG		
SP PLUG 5/8"	1	Hawsco
PACKER		
OTHER		

JOB DATA

CALLED OUT	ON LOCATION	JOB STARTED	JOB COMPLETED
DATE 1-18-85	DATE 1-18-85	DATE 1-18-85	DATE 1-18-85
TIME 4:00	TIME 5:30	TIME 09:15	TIME 14:00

PERSONNEL AND SERVICE UNITS

NAME	UNIT NO. & TYPE	LOCATION
L. D. Noel	2472	Hays, Ks.
A. Herman	CG 480	Hays, Ks.
F. Uandre	51252	Hays, Ks.
	Bull	Hays, Ks.

MATERIALS

REAT. FLUID	DENSITY	LB/GAL. API
ISPL. FLUID	DENSITY	LB/GAL. API
ROP. TYPE	SIZE	LB.
ROP. TYPE	SIZE	LB.
CID TYPE	GAL.	
CID TYPE	GAL.	
CID TYPE	GAL.	
REFRACTANT TYPE	GAL.	IN
E AGENT TYPE	GAL.	IN
FLUID LOSS ADD. TYPE	GAL.-LB.	IN
CELLING AGENT TYPE	GAL.-LB.	IN
RIC. RED. AGENT TYPE	GAL.-LB.	IN
SEALER TYPE	GAL.-LB.	IN
LOCKING AGENT TYPE	GAL.-LB.	
IRFPAC BALLS TYPE	QTY.	
OTHER		
OTHER		

DEPARTMENT: *10-1*

DESCRIPTION OF JOB: *Put long string*

JOB DONE THRU: TUBING CASING ANNULUS TBC./ANN.

CUSTOMER REPRESENTATIVE: *X Bob [Signature]*

HALLIBURTON OPERATOR: *Richard [Signature]*

COPIES REQUESTED: _____

CEMENT DATA

STAGE	NUMBER OF SACKS	TYPE	API CLASS	BRAND	BULK SACKED	ADDITIVES	YIELD CU.FT./SK.	MIXED LBS./GAL.
	250	1/2	A	Port.	B	4% Gel - 2% Eccelrite 2% Shellac	3.67	10.7
	150	1/4	A	Port.	B	2% Gel 10% salt 2% CBR 2	1.21	15

PRESSURES IN PSI

SUMMARY

VOLUMES

REGULATING DISPLACEMENT _____ PRESLUSH: BBL.-GAL. _____ TYPE _____

BEAKDOWN MAXIMUM _____ LOAD & BKDN: BBL.-GAL. _____ PAD: BBL.-GAL. _____

PERAGE FRACTURE GRADIENT _____ TREATMENT: BBL.-GAL. _____ DISPL. BBL.-GAL. 95

OUT-IN: INSTANT _____ 5-MIN. _____ 15-MIN. _____ CEMENT SLURRY: BBL.-GAL. 193

HYDRAULIC HORSEPOWER _____ TOTAL VOLUME: BBL.-GAL. _____

ORDERED AVAILABLE _____ USED _____ REMARKS: *RECEIVED sheet # 6 1/2*

AVERAGE RATES IN BPM _____ STATE CORPORATION COMMISSION

HEATING DISPL. _____ OVERALL _____

CEMENT LEFT IN PIPE _____

REASON: *S. J.*

FEB 24 1986

CONSERVATION DIVISION
Wichita Kansas

CUSTOMER: John V. Wornick
JOB TYPE: Long string
DATE: 1/18/85