

PI

State Geological Survey

KANSAS DRILLERS LOG

API No. 15 — 195 — 20,500
County Number

S. 14 T. 13 R. 21 W
Loc. SW SE NW
County Trego

Operator
Euwer Petroleum Company and Parrish Oil Company

Address
206 Litwin Building Wichita, Kansas 67202

Well No. #3 Lease Name Muhlheim "C"

Footage Location 2310 1650
feet from (N) (S) line feet from (E) (W) line

Principal Contractor Rains + Williamson Geologist C. I. Slagle

Spud Date 11-5-78 Total Depth 3925 P.B.T.D. 3906

Date Completed 11-18-78 Oil Purchaser Phillips

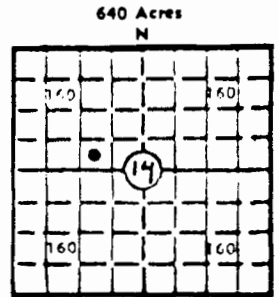

Locate well correctly
Elev.: Gr. 2189
DF 2191 KB 2194

CASING RECORD

Report of all strings set — surface, intermediate, production, etc.

| Purpose of string | Size hole drilled | Size casing set (in O.D.) | Weight lbs/ft. | Setting depth | Type cement | Sacks | Type and percent additives |
|-------------------|-------------------|---------------------------|----------------|---------------|-------------|-------|----------------------------|
| Surface | 12 1/4 | 8 5/8 | 28 | 259 | 50/50 Poz. | 165 | 2% Gel 3% CaCl |
| Production | 7 7/8 | 5 1/2 | 14 | 3924 | 50/50 Poz. | 200 | 2% Gel |
| | | | | | | | |
| | | | | | | | |

LINER RECORD

PERFORATION RECORD

| Top, ft. | Bottom, ft. | Sacks cement | Shots per ft. | Size & type | Depth interval |
|----------|-------------|--------------|---------------|-------------|----------------|
| | | | 4 | 3/8 | 3855-3860 |

| Size | Setting depth | Packer set at |
|------|---------------|---------------|
| | | |

ACID, FRACTURE, SHOT, CEMENT SQUEEZE RECORD

| Amount and kind of material used | Depth interval treated |
|----------------------------------|------------------------|
| 500 gal. 15% HCl | 3855-3860 |
| | |
| | |

INITIAL PRODUCTION

| | | | |
|--|---|--------------------------------------|-----------------------|
| Date of first production Jan 3, 1979 | Producing method (flowing, pumping, gas lift, etc.) Pump | | |
| RATE OF PRODUCTION PER 24 HOURS Oil 60 bbls. | Gas — MCF | Water — bbls. | Gas-oil ratio CFPB |
| Disposition of gas (vented, used on lease or sold) | | Producing interval(s) 7 1/2 weeks | |

INSTRUCTIONS: As provided in KCC Rule 82-2-125, within 90 days after completion of a well, one completed copy of this Drillers Log shall be transmitted to the State Geological Survey of Kansas, 4150 Monroe Street, Wichita, Kansas 67209. Copies of this form are available from the Conservation Division, State Corporation Commission, 3830 So. Meridian (P.O. Box 17027), Wichita, Kansas 66217. Phone AC 316-522-2206. If confidential custody is desired, please note Rule 82-2-125. Drillers Logs will be on an open file in the Oil and Gas Division, State Geological Survey of Kansas, Lawrence, Kansas 66044.

Operator Parrish Oil Co. DESIGNATE TYPE OF COMP.: OIL, GAS, DRY HOLE, SWDW, ETC.: Oil

Well No. 3C Lease Name Muhlheim

S. 14 T. 13S R. 21 E. W.

WELL LOG

Show all important zones of porosity and contents thereof; cored intervals, and all drill-stem tests, including depth interval tested, cushion used, time tool open, flowing and shut-in pressures, and recoveries.

SHOW GEOLOGICAL MARKERS, LOGS RUN, OR OTHER DESCRIPTIVE INFORMATION.

| FORMATION DESCRIPTION, CONTENTS, ETC. | TOP | BOTTOM | NAME | DEPTH |
|---|-----|------------------------|--------------------|-------|
| STATE <u>KANSAS</u> 1-4-29 MAP NO. _____ | | S-T-R <u>14-3S-21W</u> | <u>D</u> | |
| OPER. <u>PARRISH OIL CO & EUWER PETROLEUM CO</u> | | SPOT <u>SW SE NW</u> | <u>INIT</u> | |
| <u>110 N MARKET, WICHITA, KS 67202</u> | | CO <u>TRIGO</u> | <u>DO</u> | |
| WELL <u>3 MUHLHEIM "C"</u> | | ELEV. <u>2194 KB</u> | <u>FIN</u> | |
| CONTR. <u>RAINS & WILLIAMSON</u> | | | | |
| FIELD <u>HOMBURG (MULTIPAY)</u> | | | | |
| IP <u>IPP 60 BOPD, NW (ARB) 3855-60</u> | | | | |
| <u>API 15-195-20500 FR 9-15-78</u> | | | | |
| SPUD <u>11-5-78, 8 5/8" @ 259 w/165</u> | | KB SPL TOPS: | | |
| DST 1 (LAN) <u>3502-25, op30, si60, op90, si90, 720' GIP,</u> | | STONE CORRAL | <u>1551 + 643</u> | |
| Rec <u>20' OCM, 300' G & MCO, ISIP 475, FP 50-75/</u> | | B/STONE CORRAL | <u>1596 + 598</u> | |
| <u>100-150, FSIP 450, BHT 106</u> | | STOTLER | <u>3040 - 846</u> | |
| DST 2 (LAN) <u>3542-68, op30, si60, op90, si90, 285' GIP,</u> | | HOWARD | <u>3152 - 958</u> | |
| Rec <u>135' O & WCM, 60' O & MCW, ISIP 505, FP 46-69/</u> | | TOPEKA | <u>3202 - 1008</u> | |
| <u>92-115, FSIP 481</u> | | HEEBNER | <u>3443 - 1249</u> | |
| DST 3 (LAN) <u>3603-30, op30, si60, op90, si90, Rec 15'</u> | | LANSING | <u>3481 - 1287</u> | |
| <u>OSM, ISIP 138, FP 50-50/50-50, FSIP 150</u> | | B/KANSAS CITY | <u>3724 - 1530</u> | |
| DST 4 (LAN) <u>3630-55, op30, si45, op30, si45, Rec 20'</u> | | MARMATON | <u>3793 - 1599</u> | |
| <u>MCO, ISIP 669, FP 50-50/50-50, FSIP 125, BHT 110</u> | | ARBUCKLE | <u>3855 - 1661</u> | |
| DST 5 (LAN) <u>3655-75, op30, si45, op30, si45, Rec 10'</u> | | FTD | <u>3925 - 1731</u> | |
| (CON'T) | | TD IN ARBUCKLE | | |
| Mud, ISIP 1007, FP 50-50/50-50, FSIP 935 | | FTD | <u>3906 - 1712</u> | |
| DST 6 (MAR) <u>3796-3826, op30, si60, op90, si90, 390'</u> | | COMP ISSUED | <u>1-23-79</u> | |
| GIP, Rec <u>1050' Oil, ISIP 862, FP 75-175/250-425,</u> | | | | |
| <u>FSIP 814</u> | | | | |
| DST 7 (MAR-ARB) <u>3840-63, op30, si60, op90, 480' GIP,</u> | | | | |
| Rec <u>900' Oil, 60' GCO, ISIP 1176, FP 75-150/200-400,</u> | | | | |
| <u>FSIP 1152</u> | | | | |
| DST 8 (ARB) <u>3863-73, op30, si60, op90, si90, 450' GIP, Rec 850' GCO, 150' G & MCO,</u> | | | | |
| <u>ISIP 1176, FP 50-125/150-475, FSIP 1152, BHT 120</u> | | | | |
| DST 9 (ARB) <u>3873-83, op30, si60, op90, 300' GIP, Rec 1110' GCO, 185' OCM, 240' SW,</u> | | | | |
| <u>ISIP 1152, FP 100-250/328-621, FSIP 1152, BHT 124</u> | | | | |
| RTD <u>3925 (11-18-78), 4 1/2" @ 3924 w/200</u> | | | | |
| <u>CO 3906 PBD, Perf (ARB) 20/3855-60, 500 Gal A, Swbd load + 35 BO, NW, FU 2600'</u> | | | | |
| <u>Oil, NW/15 hrs, Swbd 12 BOPH/3 hrs</u> | | | | |
| <u>IPP 60 BOPD, NW, ARBUCKLE 3855-60</u> | | | | |
| <u>COMPLETED 1-11-79</u> | | | | |

Petroleum Information Corporation
 Copyright © 1979 All Rights Reserved
 REPRODUCTION PROHIBITED

USE ADDITIONAL SHEETS, IF NECESSARY, TO COMPLETE WELL RECORD.

Date Received _____

Signature Lloyd K Parrish

Title Partner

Date Feb 4, 1979