

KANSAS

IMPORTANT
Kans. Geo. Survey request
samples on this well.

State Geological Survey
WICHITA, KANSAS

WELL COMPLETION REPORT AND
DRILLER'S LOG

S. 14 T. 13 R. 21 ^N/_W

Loc. SW-NE-NW

County Trego

API No. 15 - 195 - 20,699
County Number

Operator
Parrish Oil Company

Address
110 North Market #201 Wichita

Well No. 6 Lease Name Muhlheim "CY"

Footage Location 990 1320
feet from (N) line feet from (W) line

Principal Contractor H-30, Inc. Geologist Charles Slagel

Spud Date 8-31-80 Date Completed 9-10-80 Total Depth 3883 P.B.T.D.

Directional Deviation Oil and/or Gas Purchaser

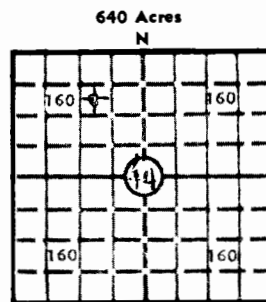

Elev.: Gr. 2179

DF 2182 KB 2184

CASING RECORD

Report of all strings set — surface, intermediate, production, etc.

Purpose of string	Size hole drilled	Size casing set (in O.D.)	Weight lbs/ft.	Setting depth	Type cement	Sacks	Type and percent additives
Surface	12 1/2	8 5/8	24	257	Common	180	2% Gel

LINER RECORD

PERFORATION RECORD

Top, ft.	Bottom, ft.	Sacks cement	Shots per ft.	Size & type	Depth interval

Size	Setting depth	Packer set at

ACID, FRACTURE, SHOT, CEMENT SQUEEZE RECORD

Amount and kind of material used	Depth interval treated

INITIAL PRODUCTION

Date of first production None	Producing method (flowing, pumping, gas lift, etc.)
RATE OF PRODUCTION PER 24 HOURS	Oil bbls. Gas MCF Water bbls. Gas-oil ratio CFPB
Disposition of gas (vented, used on lease or sold)	Producing interval (s)

INSTRUCTIONS: As provided in KCC Rule 82-2-125, within 90 days after completion of a well, one completed copy of this Drillers Log shall be trans-
mitted to the State Geological Survey of Kansas, 4150 Monroe Street, Wichita, Kansas 67209. Copies of this form are available from the Conservation
Division, State Corporation Commission, 245 No. Water, Wichita, Kansas 67202. Phone AC 316-522-2206. If confidential custody is desired, please note
Rule 82-2-125. Drillers Logs will be on open file in the Oil and Gas Division, State Geological Survey of Kansas, Lawrence, Kansas 66044.

Operator **Parrish Oil Company** DESIGNATE TYPE OF COMP.: OIL, GAS, DRY HOLE, SWDW, ETC.: **Dry Hole**

Well No. **6** Lease Name **Muhlheim "C"**

S 14 T 13 R 21 ^{XX}_W

WELL LOG

Show all important zones of porosity and contents thereof; cored intervals, and all drill-stem tests, including depth interval tested, cushion used, time tool open, flowing and shut-in pressures, and recoveries.

SHOW GEOLOGICAL MARKERS, LOGS RUN, OR OTHER DESCRIPTIVE INFORMATION.

FORMATION DESCRIPTION, CONTENTS, ETC. TOP BOTTOM NAME DEPTH

PARRISH OIL COMPANY
110 N MARKET #201
WICHITA, KS 67202
CONTR H-30 INC

#6 MUHLHEIM "C" 14-13-21W SW NE NW

CTY TREGO

GEOL _____ FIELD HOMBURG

E 2184 KB CM 8/31/80 CARD ISSUED 9/25/80 IP D&A/ARB 9/10/80

API 15-195-20,699

LOG	TOPS	DEPTH	DATUM
ANH		1548	+ 636
B ANH		1594	+ 590
TOP		3198	-1014
HEEB		3441	-1257
LANS		3479	-1295
B KC		3722	-1538
MARM		3788	-1604
ARB		3855	-1671
RTD		3883	-1699
LTD		3883	-1699

INDEPENDENT OIL & GAS SERVICE
WICHITA, KANSAS

8 5/8" 257/180sx

DST (1) 3605-55/MISRUN

DST (2) 3606-55/1HR, 15' M, SN, SIP
769#/60"-704#/60", ALL FP 32#

DST (3) 3798-3824/1HR, 15' OCM, SIP
834#/60"-758#/60", ALL FP 21#

DST (4) 3824-59/1HR, 10' M, SSO, SIP
43#/60"-32#/60", ALL FP 32#

DST (5) 3822-68/1HR, 10' M, NS, SIP
54-43#/60", ALL FP 32#

DST (6) 3868-83/1HR, 57B' GCW, SIP
1178#/60"-1167#/90", FP 32-27#

USE ADDITIONAL SHEETS, IF NECESSARY, TO COMPLETE WELL RECORD.

Date Received

Loyal K. Parrish
Signature
Partner
Title
October 9, 1980
Date