

KANSAS DRILLERS LOG

S. 9 T. 14S R. 10W $\frac{1}{2}$ W

API No. 15 — 053 — 20,464
County Number

Loc. NW NW SE

County Ellsworth

Operator
MACK OIL CO.

Address
908 Union Center, Wichita, KS 67202

Well No. 1 Lease Name Hlaus

Footage Location
330 feet from (N) (X) line 330 feet from (E) (W) line of SE/4

Principal Contractor Red Tiger Drlg. Geologist Earl Moore

Spud Date 4-19-77 Total Depth 3487' P.B.T.D.

Date Completed 4-28-77 Oil Purchaser none

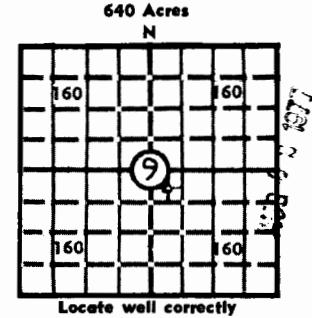

Locate well correctly
Elev.: Gr. 1783'

DF 1787' KB 1788'

CASING RECORD

Report of all strings set — surface, intermediate, production, etc.

Purpose of string	Size hole drilled	Size casing set (in O.D.)	Weight lbs./ft.	Setting depth	Type cement	Sacks	Type and percent additives
surface pipe	12 1/4"	8 5/8"	28#	254'	common	180	2% gel, 3% CC

LINER RECORD

PERFORATION RECORD

Top, ft.	Bottom, ft.	Sacks cement	Shots per ft.	Size & type	Depth interval

TUBING RECORD

Size	Setting depth	Packer set at

ACID, FRACTURE, SHOT, CEMENT SQUEEZE RECORD

Amount and kind of material used	Depth interval treated

INITIAL PRODUCTION

Date of first production _____ Producing method (flowing, pumping, gas lift, etc.) _____

RATE OF PRODUCTION PER 24 HOURS
Oil _____ bbls. Gas _____ MCF Water _____ bbls. Gas-oil ratio _____ CFPB

Disposition of gas (vented, used on lease or sold) _____ Producing interval (s) _____

INSTRUCTIONS: As provided in KCC Rule 82-2-125, within 90 days after completion of a well, one completed copy of this Drillers Log shall be transmitted to the State Geological Survey of Kansas, 4150 Monroe Street, Wichita, Kansas 67209. Copies of this form are available from the Conservation Division, State Corporation Commission, 3830 So. Meridian (P.O. Box 17027), Wichita, Kansas 66217. Phone AC 316-522-2206. If confidential custody is desired, please note Rule 82-2-125. Drillers Logs will be on open file in the Oil and Gas Division, State Geological Survey of Kansas, Lawrence, Kansas 66044.

erator
MACK OIL CO.

DESIGNATE TYPE OF COMP.: OIL, GAS,
DRY HOLE, SWDW, ETC.:
DRY HOLE

Well No. 1	Lease Name Hlaus
S 9 T 14 S R 10 W E W	

WELL LOG

Show all important zones of porosity and contents thereof; cored intervals, and all drill-stem tests, including depth interval tested, cushion used, time tool open, flowing and shut-in pressures, and recoveries.

SHOW GEOLOGICAL MARKERS, LOGS RUN,
OR OTHER DESCRIPTIVE INFORMATION.

FORMATION DESCRIPTION, CONTENTS, ETC.	TOP	BOTTOM	NAME	DEPTH
Surface soil, clay, shale & sand		257	L-GR-N	0' -3488'
Sand & shale		458		
Shale		571	Tarkio	2254 (- 466)
Anhydrite		599	Heebner	2796 (-1008)
Shale		1185	Brown Lime	2894 (-1106)
Shale & Lime		1435	Lansing	2916 (-1128)
Lime & shale		2030	Viola	3330 (-1542)
Lime		2332	Simpson	3396 (-1618)
Lime & Shale		2608	Arbuckle	3450 (-1672)
Lime		3487		
		RTD		
No tests				

USE ADDITIONAL SHEETS, IF NECESSARY, TO COMPLETE WELL RECORD.

Date Received	<p><i>Nancy Laggart</i> Signature</p> <p>Secretary</p> <p>May 4, 1977</p> <p>Title</p> <p>Date</p>
---------------	--