

August 16, 1972

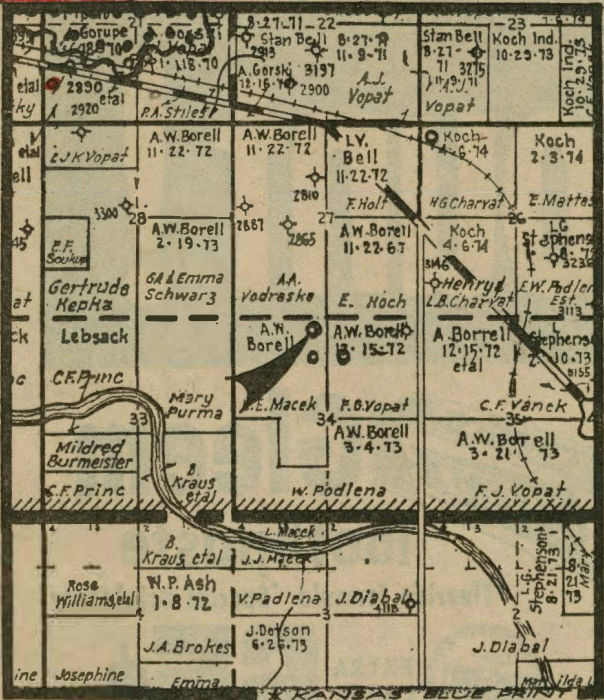

ELLSWORTH HOTSPOT—Albert Borell, Wilson, Kan., has a new oil field of unknown magnitude sprouting in Ellsworth County, three miles southeast of Wilson and a mile and one-half from the outline Wilson Creek field (above). Borell set 2,882 feet of production pipe on No. 1 Macek, ne ne nw of 34-14-10w (arrow). Completion tests were unrevealed, but south and southeast offset wells are under way. A Koch Exploration test is also drilling in the northeast corner of Section 26.