

WELL LOG BUREAU - KANSAS GEOLOGICAL SOCIETY
412 Union National Bank Bldg, Wichita, Kansas.

THE TEXAS COMPANY,
E.A. Borell No. 3

SEC. 32 T. 14 R. 12 W.
CS $\frac{1}{2}$ SE SE

Total Depth, 3170
Comm. 8-26-42 Comp. 9-18-42
Shot or Treated.
Contractor. Helmerich and Payne, Inc.
Issued. 10-31-42

County Russell.

CASING. Rotary 3168
Cable 3170

103/4" 360' cemented.
5 1/2" 3168' cemented.

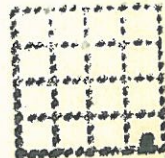

Elevation.

Production. Pot. 276 I
no wtr. Physical.

Figures Indicate Bottom of Formations.

sand and shale	220
shale and shells	405
shale and red bed	650
anhydrite	680
shale	700
shale and shells	1170
salt and shale	1315
anhydrite	1345
lime and shale	1480
lime	1560
shale and lime	1655
sdv lime	1760
sdv lime and shale	1860
sdv lime	1970
shale and lime	2560
broken lime	2686
shale and lime	2722
broken lime.	2786
lime	2840
shale and lime	2898
lime hard	2910
lime soft	2925
lime hard	2942
shale and lime	2978
lime	3060
lime soft	3072
lime	3100
lime soft	3106
lime little shale	3127
lime	3145
shale and lime	3160
lime	3168
sand	3170

Total Depth.

Tops - Heebner 2794
Lansing 2865
2910-25 Porous
2980-86 Med, Porous
Gorham 3168