

STATE CORPORATION COMMISSION OF KANSAS  
OIL & GAS CONSERVATION DIVISION

WELL COMPLETION OR RECOMPLETION FORM  
ACO-1 WELL HISTORY

DESCRIPTION OF WELL AND LEASE

Operator: License # 6879  
Name Solar Petroleum, Inc.  
Address Stellar Plaza  
1099 18th St., Suite 2900  
City/State/Zip Denver, CO 80202-1999

Purchaser TEXACO

Operator Contact Person Sherwin Artus  
Phone 303-861-9561

Contractor: License # 8241  
Name Emphasis Oil Operations

Wellsite Geologist Richard Smith  
Phone 316-792-2871

Designate Type of Completion  
 New Well  Re-Entry  Workover  
 Oil  SWD  Temp Abd  
 Gas  Inj  Delayed Comp.  
 Dry  Other (Core, Water Supply etc.)

If ONWO: old well info as follows:  
Operator  
Well Name  
Comp. Date Old Total Depth

WELL HISTORY

Drilling Method:  
 Mud Rotary  Air Rotary  Cable  
4/4/85 4/10/85 6/19/85  
Spud Date Date Reached TD Completion Date  
3242  
Total Depth PBT

Amount of Surface Pipe Set and Cemented at 708 feet  
Multiple Stage Cementing Collar Used?  Yes  No  
If yes, show depth set feet  
If alternate 2 completion, cement circulated  
from feet depth to w/SX cmt

API NO. 15-167-22,583  
County Russell  
NW NE NE 31 14S Rge 13  
Sec Twp Rge  East  West

4950 Ft North from Southeast Corner of Section  
990 Ft West from Southeast Corner of Section  
(Note: Locate well in section plat below)

Lease Name G. Miller Well # 17-31

Field Name Hall-Gurney

Producing Formation LAWSON, KANSAS CITY

Elevation: Ground 1750 KB 1755  
Section Plat

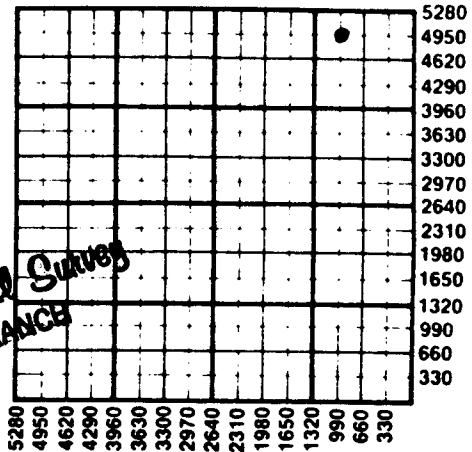

AUG 07 1985  
State Geological Survey  
WICHITA BRANCH

WATER SUPPLY INFORMATION  
Disposition of Produced Water:  Disposal  Repressuring  
Docket # E-231659  
C15078

Questions on this portion of the ACO-1 call:  
Water Resources Board (913) 296-3717

Source of Water:  
Division of Water Resources Permit #

Groundwater Ft North from Southeast Corner (Well) Ft West from Southeast Corner of Sec Twp Rge  East  West

Surface Water 4980 Ft North from Southeast Corner (Stream, pond etc) 2300 Ft West from Southeast Corner Sec 31 Twp 14S Rge 13  East  West

Other (explain) (purchased from city, R.W.D. #)

INSTRUCTIONS: This form shall be completed in duplicate and filed with the Kansas Corporation Commission, 200 Colorado Derby Building, Wichita, Kansas 67202, within 90 days after completion or recompletion of any well. Rule 82-3-130 and 82-3-107 apply.

Information on side two of this form will be held confidential for a period of 12 months if requested in writing and submitted with the form. See rule 82-3-107 for confidentiality in excess of 12 months.

One copy of all wireline logs and drillers time log shall be attached with this form. Submit CP-4 form with all plugged wells. Submit CP-111 form with all temporarily abandoned wells.

502157

SIDE TWO

Operator Name Solar Petroleum, Inc. Lease Name G. Miller Well # 17-31

Sec 31 Twp 14S Rge 13 East West County Russell

WELL LOG

INSTRUCTIONS: Show important tops and base of formations penetrated. Detail all cores. Report all drill stem tests giving interval tested, time tool open and closed, flowing and shut-in pressures, whether shut-in pressure reached static level, hydrostatic pressures, bottom hole temperature, fluid recovery, and flow rates if gas to surface during test. Attach extra sheet if more space is needed. Attach copy of log.

Drill Stem Tests Taken [ ] Yes [X] No
Samples Sent to Geological Survey [X] Yes [ ] No
Cores Taken [ ] Yes [X] No

Formation Description [X] Log [ ] Sample

Table with 3 columns: Name, Top, Bottom. Lists formations like Granhaven, Tarkio Limestone, Tarkio Sand, Topeka, Heebner, etc.

AUG 07 1985
State Geological Survey
WICHITA BRANCH

Table with 6 columns: Oil, Gas, Water, Gas-Oil Ratio, Gravity. Includes handwritten production values like 17.74 Bbls and 38.9 CFPB.

METHOD OF COMPLETION

Production Interval

Disposition of gas: [X] Vented [ ] Open Hole [X] Perforation
[ ] Sold [ ] Other (Specify)
[ ] Used on Lease

2970-78, 2910-21, 2896-2902

Table with 8 columns: Surface, Production, etc. Includes handwritten values like 46-1/4, 7-7/8, 15%, 3241, 50/50 poa, 340, 225, 3% S.S., 2% gel, 10% salt, 5% gilsonite.

PERFORATION RECORD and Acid, Fracture, Shot, Cement Squeeze Record. Includes columns for Shots Per Foot, Specify Footage, Amount and Kind of Material Used, Depth.

TUBING RECORD. Includes columns for Size, Set At, Packer at, Liner Run, Yes/No.

Date of First Production Producing Method

31-14-13W

*Handwritten initials*

EMPHASIS OIL OPERATIONS

Box 506

Russell, KS 67665 X

DRILLERS LOG

OPERATOR: Solar Petroleum, Inc.  
Stellar Plaza  
1099 18th St., Suite 2900  
Denver, CO 80202-1999

CONTRACTOR: Emphasis Oil Operations  
Box 506  
Russell, KS 67665

LEASE: G. Miller

WELL: #17-31

LOCATION: NW NE NE  
Section 31-14S-13W  
Russell County, Kansas

Log Total Depth: 3242'

Rotary Total Depth: 3242'

Elevation: 1755' K.B.

Commenced: 4/04/85

Completed: 4/10/85

Casing: 8-5/8" @ 708' w/340 sks cement  
5-1/2" @ 3241' w/225 sks cement

Status: Oil Well

**AUG 07 1985**  
**State Geological Survey**  
**WICHITA BRANCH**

DEPTHS & FORMATIONS

(All measurements from K.B.)

Top soil & Sand	30'	Shale	2163'
Sand	96'	Shale & Lime	2370'
Shale	145'	Shale	2835'
Iron Pyrite	165'	Lime	3175'
Shale	690'	Granite Wash & Granite (R.T.D.)	3242'
Anhydrite	723'		

STATE OF KANSAS )  
COUNTY OF RUSSELL) ss

Kyle B. Branum, of Emphasis Oil Operations, states that the above and foregoing is a true and correct log of the above captioned well, to the best of his knowledge.

*Handwritten signature*