

KANSAS DRILLERS LOG

S. 27 T. 14S R. 13 ^W
 Loc. 200' E N/2 SE SW
 County Russell

API No. 15 _____
 County _____ Number _____

Operator
John O. Farmer, Inc.

Address
Box 352, Russell, Kansas 67665

Well No. 9 Lease Name REIN ✓

Footage Location
990 feet from (N) (S) line 460 feet from (E) (W) line

Principal Contractor
John O. Farmer, Inc. Geologist Francis Whisler

Spud Date
March 4, 1976 Total Depth 3122 P.B.T.D. 3030

Date Completed
April 14, 1976 Oil Purchaser None - Temp. Abandoned

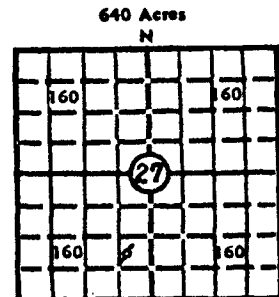

Elev.: Gr. 1708'
 DF 1711' KB 1713'

CASING RECORD

Report of all strings set — surface, intermediate, production, etc.

Purpose of string	Size hole drilled	Size casing set (in O.D.)	Weight lbs/ft.	Setting depth	Type cement	Secks	Type and percent additives
Surface	12½	8-5/8	26	200'	Common		
Production	7-7/8	5½	15	3112½	Common		

LINER RECORD

PERFORATION RECORD

Top, ft.	Bottom, ft.	Secks cement	Shots per ft.	Size & type	Depth interval
			4	Jets	2296-2302 2284-2289
			4	Jets	2199-2204 2219-2224

ACID, FRACTURE, SHOT, CEMENT SQUEEZE RECORD

Amount and kind of material used	Depth interval treated
10,000 Gal. Jelled Water & 8000# 10/20 Sand	2296-2302 2284-2289
10,000 Gal. Jelled Water & 8000# 10/20 Sand	2199-2204 2219-2224

INITIAL PRODUCTION

Date of first production _____ Producing method (flowing, pumping, gas lift, etc.) _____

RATE OF PRODUCTION PER 24 HOURS	Oil	Gas	Water	Gas-oil ratio
	bbls.	bbls.	MCFT	CFPB

Disposition of gas (vented, used on lease or sold) _____ Producing interval (s) _____

INSTRUCTIONS: As provided in KCC Rule 82-2-125, within 90 days after completion of a well, one completed copy of this Drillers Log shall be transmitted to the State Geological Survey of Kansas, 4150 Monroe Street, Wichita, Kansas 67209. Copies of this form are available from the Conservation Division, State Corporation Commission, 3830 So. Meridian (P.O. Box 17027), Wichita, Kansas 66217. Phone AC 316-522-2206. If confidential custody is desired, please note Rule 82-2-125. Drillers Logs will be on an open file in the Oil and Gas Division, State Geological Survey of Kansas, Lawrence, Kansas 66044.

RECEIVED
 STATE CORPORATION COMMISSION
 State Geological Survey
 WICHITA, KANSAS
 12 16 1985

DEC 1 1985

CONSERVATION DIVISION
 Wichita, Kansas

Operator

John O. Farmer, Inc.

DESIGNATE TYPE OF COMP.: OIL, GAS, DRY HOLE, SWDW, ETC.:

Well No.

9

Lease Name

REIN

Temporarily Abandoned

s 27 T 14 R 13 W

Russell County, Kansas

WELL LOG

Show all important zones of porosity and contents thereof; cored intervals, and all drill-stem tests, including depth interval tested, cushion used, time tool open, flowing and shut-in pressures, and recoveries.

SHOW GEOLOGICAL MARKERS, LOGS RUN, OR OTHER DESCRIPTIVE INFORMATION.

FORMATION DESCRIPTION, CONTENTS, ETC.	TOP	BOTTOM	NAME	DEPTH	
Shale & Shells	197	632	Sample Tops:		
Anhydrite	632	667			
Shale & Shells	667	1385		Anhydrite	632' (+1081)
Lime & Shale	1385	1685		Topeka	2528 (-815)
Shale & Lime	1685	2575		Lansing/KC	2830 (-1117)
Lime & Shale	2575	2765		B/KC	3102 (-1389)
Lime	2765	3070		Arbuckle	3111 (-1398)
Arbuckle	3070	3113		T.D.	3113 (-1400)
Total Depth	3113				
Cable Tool T.D.	3122				
DST #1 2193-2235 Tool Open 30-60-60-60; strong blow Rec: 420' gas; 90' thin mud with trace of oil IFP: 30-42 FFP: 59-77 IBHP: 927 FBHP: 686					
DST #2 2269-2310 Tool Open 30-60-60-60; good blow Rec: 90' slightly oil & gas cut mud; 60' watery mud; 120' muddy water IFP: 47-59 FFP: 94-145 IBHP: 1238 FBHP: 1238					
DST #3 2910-2961 Tool Open 30-60-60-60 Rec: 180' muddy water; 190' water IFP: 56-111 FFP: 128-214 IBHP: 763 FBHP: 729					

USE ADDITIONAL SHEETS, IF NECESSARY, TO COMPLETE WELL RECORD.

Date Received

John O. Farmer
Signature

President

Title

April 26, 1976

Date