

MAR 17 1977

KANSAS DRILLERS LOG

S. 28 T. 14 R. 13 **K**
W

Loc. SW SE NE

County Russell

API No. 15 — 167 — 20,943
 County Number

Operator
 Shields Oil Producers, Inc.

Address
 Shields Building Russell, Kansas 67665

Well No. #15 Lease Name Giese

Footage Location 2970 FSL-KCC
330 feet from (N) (S) line 990 feet from (E) (W) line

Principal Contractor Shields Drlg. Co., Inc. Geologist M. L. Ratts

Spud Date 8-17-76 Total Depth 2400 P.B.T.D. 2374

Date Completed 8-21-76 Oil Purchaser Continental

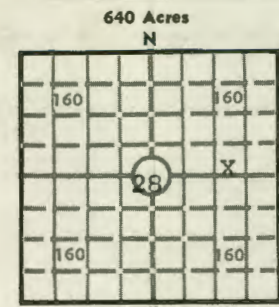

Locate well correctly
 Elev.: Gr. 1742

DF 1744 KB 1747

CASING RECORD

Report of all strings set—surface, intermediate, production, etc.

Purpose of string	Size hole drilled	Size casing set (in O.D.)	Weight lbs/ft.	Setting depth	Type cement	Sacks	Type and percent additives
Surface	12 1/4	8 5/8	20	210	Quickset	165	
Production	7 7/8	4 1/2	9 1/2	2400	Common	100	

LINER RECORD

PERFORATION RECORD

Top, ft.	Bottom, ft.	Sacks cement	Shots per ft.	Size & type	Depth interval
			3	Jet	2246-2249 2274-2277
			3	Jet	2332-2335 2342-2345

TUBING RECORD

ACID, FRACTURE, SHOT, CEMENT SQUEEZE RECORD

Amount and kind of material used	Depth interval treated
Fracture w/40,000# Sand & 800 B.W.	2246-2345

INITIAL PRODUCTION

Date of first production 10-22-76	Producing method (flowing, pumping, gas lift, etc.) Pumping
RATE OF PRODUCTION PER 24 HOURS Oil 25 bbls.	Gas Yes MCF
Water Yes bbls.	Gas-oil ratio CFPB
Disposition of gas (vented, used on lease or sold) Used on Lease	Producing interval (s) 2246-2345

INSTRUCTIONS: As provided in KCC Rule 82-2-125, within 90 days after completion of a well, one completed copy of this Drillers Log shall be transmitted to the State Geological Survey of Kansas, 4150 Monroe Street, Wichita, Kansas 67209. Copies of this form are available from the Conservation Division, State Corporation Commission, 3830 So. Meridian (P.O. Box 17027), Wichita, Kansas 66217. Phone AC 316-522-2206. If confidential custody is desired, please note Rule 82-2-125. Drillers Logs will be on open file in the Oil and Gas Division, State Geological Survey of Kansas, Lawrence, Kansas 66044.

Operator
Shields Oil Producers, Inc.

DESIGNATE TYPE OF COMP.: OIL, GAS,
DRY HOLE, SWDW, ETC.:

Well No. 15

Lease Name
Giese

Oil

S 28 T 14 R 13 E
W

WELL LOG

Show all important zones of porosity and contents thereof; cored intervals, and all drill-stem tests, including depth interval tested, cushion used, time tool open, flowing and shut-in pressures, and recoveries.

SHOW GEOLOGICAL MARKERS, LOGS RUN,
OR OTHER DESCRIPTIVE INFORMATION.

FORMATION DESCRIPTION, CONTENTS, ETC.	TOP	BOTTOM	NAME	DEPTH
			Anhydrite	676
			Grandhaven Lm.	2232
			Tarkio Sand	2246
			Dover Lm.	2258
			Tarkio Lm.	2304
			3rd. Tarkio Sd.	2332
			Elmont Lm.	2370

USE ADDITIONAL SHEETS, IF NECESSARY, TO COMPLETE WELL RECORD.

Date Received

Prod. Engineer
Signature

M. F. Rott
Title

10-22-76
Date