

State Geological Survey
WICHITA, BRANCH

KANSAS DRILLERS LOG

S. 28 T. 14 R. 13 ^R_W

API No. 15 — 167 — 20,944
County Number

Loc. SE SW NE

County Russell

Operator
Shields Oil Producers, Inc.
Address
Shields Building Russell, Kansas 67665

Well No. #16 Lease Name Giese

Footage Location
2310 feet from (N) (S) line 1650 feet from (E) (W) line
1650 - FEL - KCC

Principal Contractor Shields Drlg Co., Inc. Geologist M. I. Ratto

Spud Date 8-23-76 Total Depth 2400 P.B.T.D. 2364

Date Completed 8-26-76 Oil Purchaser Continental

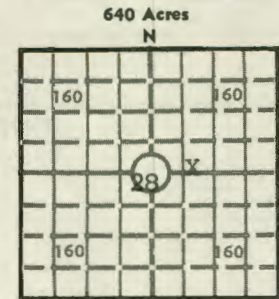

Elev.: Gr. 1729

DF 1731 KB 1734

CASING RECORD

Report of all strings set — surface, intermediate, production, etc.

Purpose of string	Size hole drilled	Size casing set (in O.D.)	Weight lbs/ft.	Setting depth	Type cement	Sacks	Type and percent additives
Surface	12 1/4	8 5/8	20#	238	Quickset	165	
Production	7 7/8	4 1/2	9 1/2#	2397	Common	100	

LINER RECORD

PERFORATION RECORD

Top, ft.	Bottom, ft.	Sacks cement	Shots per ft.	Size & type	Depth interval
			3	Jet	2233-2236 2264-2267
			3	Jet	2320-2323 2332-2335

TUBING RECORD

ACID, FRACTURE, SHOT, CEMENT SQUEEZE RECORD

Amount and kind of material used	Depth interval treated
Fractured w/40,000# Sand & 20,000 gal. water	2233-2335

INITIAL PRODUCTION

Date of first production <u>10-15-76</u>	Producing method (flowing, pumping, gas lift, etc.) <u>Pumping</u>			
RATE OF PRODUCTION PER 24 HOURS	Oil <u>25</u> bbls.	Gas <u>Yes</u> MCF	Water <u>Yes</u> bbls.	Gas-oil ratio <u>CFPB</u>
Disposition of gas (vented, used on lease or sold) <u>Used on Lease</u>			Producing interval (s) <u>2233-2335</u>	

INSTRUCTIONS: As provided in KCC Rule 82-2-125, within 90 days after completion of a well, one completed copy of this Drillers Log shall be transmitted to the State Geological Survey of Kansas, 4150 Monroe Street, Wichita, Kansas 67209. Copies of this form are available from the Conservation Division, State Corporation Commission, 3830 So. Meridian (P.O. Box 17027), Wichita, Kansas 66217. Phone AC 316-522-2206. If confidential custody is desired, please note Rule 82-2-125. Drillers Logs will be on open file in the Oil and Gas Division, State Geological Survey of Kansas, Lawrence, Kansas 66044.

MAR 17 1977

Operator
Shields Oil Producers, Inc.

DESIGNATE TYPE OF COMP.: OIL, GAS,
DRY HOLE, SWDW, ETC.:

Well No. 16

Lease Name
Giese

Oil

S 28 T 14 R 13 E 4
W

WELL LOG

Show all important zones of porosity and contents thereof; cored intervals, and all drill-stem tests, including depth interval tested, cushion used, time tool open, flowing and shut-in pressures, and recoveries.

SHOW GEOLOGICAL MARKERS, LOGS RUN,
OR OTHER DESCRIPTIVE INFORMATION.

FORMATION DESCRIPTION, CONTENTS, ETC.	TOP	BOTTOM	NAME	DEPTH
			Anhydrite	662
			Grandhaven Lm.	2222
			Tarkio Sd.	2230
			Dover Lm.	2246
			Tarkio Lm.	2292
			3rd Tarkio Sd.	2319
			Elmont Lm.	2356

USE ADDITIONAL SHEETS, IF NECESSARY, TO COMPLETE WELL RECORD.

Date Received

M. F. Ratto
Signature

Prod. Engineer
Title

10-27-76
Date