

WICHITA BRANCH

KANSAS DRILLERS LOG

S. 34 T. 14 R. 14 $\frac{E}{W}$

Loc. C S2 SE NW

County Russell

API No. 15 — 167 — 21,117
 County Number

Operator
 National Cooperative Refinery Assoc.

Address
 Box 6 Great Bend, Kansas 67530

Well No. #6 SWD Lease Name Mai

Footage Location
 feet from (N) (S) line feet from (E) (W) line

Principal Contractor WOODMAN - IANNITTI DRLG. Geologist J. C. MUSGROVE

Spud Date DEC. 1, 1977 Total Depth 3456' P.B.T.D.

Date Completed DEC. 29, 1977 Oil Purchaser

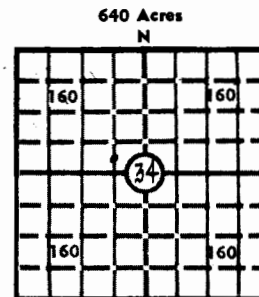

Locate well correctly

Elev.: Gr. 1710'

DF 1712' KB 1715'

CASING RECORD

Report of all strings set — surface, intermediate, production, etc.

Purpose of string	Size hole drilled	Size casing set (in O.D.)	Weight lbs/ft.	Setting depth	Type cement	Sacks	Type and percent additives
SURFACE	12 1/4"	8 5/8"	24#	711'	50/50 Poz.	250	4% GEL 3% CaCl ₂
					PLUS COMMON	100	3% CaCl ₂
DISPDSAL	7 7/8"	5 1/2"	14#	3205'	50/50 Poz.	150	3/4 OF 1% CFR2

LINER RECORD

PERFORATION RECORD

Top, ft.	Bottom, ft.	Sacks cement	Shots per ft.	Size & type	Depth interval

TUBING RECORD		
Size	Setting depth	Packer set at
2 7/8"	3198'	

ACID, FRACTURE, SHOT, CEMENT SQUEEZE RECORD

Amount and kind of material used	Depth interval treated
4000 GAL. M-38 15% Acid	3205' - 3456' OPEN HOLE

INITIAL PRODUCTION

Date of first production		Producing method (flowing, pumping, gas lift, etc.)			
RATE OF PRODUCTION PER 24 HOURS	Oil bbls.	Gas MCF	Water bbls.	Gas-oil ratio CFPB	
Disposition of gas (vented, used on lease or sold)			Producing interval(s)		

INSTRUCTIONS: As provided in KCC Rule 82-2-125, within 90 days after completion of a well, one completed copy of this Drillers Log shall be transmitted to the State Geological Survey of Kansas, 4150 Monroe Street, Wichita, Kansas 67209. Copies of this form are available from the Conservation Division, State Corporation Commission, 3830 So. Meridian (P.O. Box 17027), Wichita, Kansas 66217. Phone AC 316-522-2206. If confidential custody is desired, please note Rule 82-2-125. Drillers Logs will be on open file in the Oil and Gas Division, State Geological Survey of Kansas, Lawrence, Kansas 66044.

Operator NATIONAL COOPERATIVE REFINERY ASSN, DESIGNATE TYPE OF COMP.: OIL, GAS, DRY HOLE, SWDW, ETC.: SWDW

Well No. 6 Lease Name MAI

S 34 T 14 R 14 W

WELL LOG

Show all important zones of porosity and contents thereof; cored intervals, and all drill-stem tests, including depth interval tested, cushion used, time tool open, flowing and shut-in pressures, and recoveries.

SHOW GEOLOGICAL MARKERS, LOGS RUN, OR OTHER DESCRIPTIVE INFORMATION.

FORMATION DESCRIPTION, CONTENTS, ETC.	TOP	BOTTOM	NAME	DEPTH
<u>TARKIO-</u>			<u>SAMPLE TOPS:</u>	
SAND, GREY TO DIRTY GREY, MICACEOUS, ARGILLACEOUS, POORLY SORTED, POOR VISABLE POROSITY. NO SHOWS OF OIL.	2265'	2295'	ANHYDRITE	693'
			GRAND HAVEN	2255'
			DOVER LIME	2280'
SAND, GREY TO WHITE, FINE GRAIN, MICACEOUS, WELL SORTED, ARGILLACEOUS, NO SHOWS OF OIL.	2363'	2391'	TARKIO LIME	2324'
			HEEBNER	2821'
			TORONTO	2840'
<u>TOPEKA -</u> LIMESTONE, GREY TO TAN, FOSSILIFEROUS, CHALKY, POOR POROSITY SPOTTY STAIN, TRACE OF FREE OIL AND FAINT ODDOR.	2773'	2776'	DOUGLAS	2854'
			LANSING - Ks. CITY	2881'
<u>LANSING-</u>			CONG. SAND	3122'
LIMESTONE, GREY, FINELY CRYSTALLINE TO OOLASTIC POROSITY, GOOD STAIN, GOOD SHOW OF FREE OIL AND ODDOR.	2886'	2930'	ARBUCKLE	3156'
			<u>LOG TOPS:</u>	
LIMESTONE, GREY TO BUFF, OOLASTIC, GOOD POROSITY, FAIR SPOTTY STAIN. SHOW OF FREE OIL AND FAIR ODDOR.	2970'	2986'	ANHYDRITE	693'
			GRAND HAVEN	2255'
LIMESTONE, CREAM TO GREY TO WHITE, OOLITIC TO FOSSILIFEROUS, POOR POROSITY, TRACE STAIN. NO FREE OIL OR ODDOR.	3028'	3055'	DOVER	2281'
			TARKIO LIME	2327'
			TOPEKA	2593'
			HEEBNER	2823'
<u>CONGLOMERATE -</u>			TORONTO	2841'
SAND, COARSE GRAIN, UNCONSOLIDATED, CLEAR, ANGULAR. ABUNDANT FRACTURE POROSITY, ABUNDANT VARI-COLORED SHALE. SHOW OF FREE OIL AND GOOD ODDOR.	3119'	3130'	DOUGLAS	2855'
			LANSING	2883'
SAND, GREY, FINE GRAIN, CONSOLIDATED, GOOD INTERGRANULAR POROSITY, FRIABLE WELL SORTED, ROUNDED. GOOD STAIN AND SATURATION. GOOD SHOW OF FREE OIL AND WEAK ODDOR.	3143'	3149'	BASE Ks. CITY	3087'
			CONG. SAND	3143'
			ARBUCKLE	3159'
			LTD	3458'

USE ADDITIONAL SHEETS, IF NECESSARY, TO COMPLETE WELL RECORD.

Date Received

Shirley J. [Signature]

Signature

DISTRICT SUPERINTENDENT

Title

1-3-78

Date

ARBUCKLE -

DOLOMITE, WHITE, FINE TO MEDIUM CRYSTALLINE, SPOTTY INTERCRYSTALLINE POROSITY, TRACE SPOTTY STAIN, WEAK SHOW OF FREE OIL.

TOP BOTTOM

3163' 3187'

DOLOMITE, GREY TO WHITE, FINE TO MEDIUM CRYSTALLINE, FAIR INTERCRYSTALLINE POROSITY, SPOTTY STAIN. NO FREE OIL OR ODOR.

3186' 3277'

PINK TO RED, FINE GRAIN SAND. ABUNDANT, CLEAR, LOOSE, COARSE, QUARTZ GRAINS, ABUNDANT MAROON AND GREEN SHALE, TRACES OF GREY SANDY DOLOMITE.

3277' 3328'

QUARTZITE - PURE QUARTZ SAND, GLASSY WITH WHITE TO GREY MICA, ANGULAR, ABUNDANT MAROON AND GREEN WAXY SHALE, AND RED GRANITIC MATERIAL. NO SHOWS OF OIL.

3328' 3458'

DST #1 15-45-45-60 IHP 1535# ISIP 727#

2885' 2930'

IF 46-46# FF 70-82# FSIP 1501# FHP 1501#

STRONG BLOW THROUGHOUT TEST. REC. 150' GAS IN PIPE - 30' SL. O & GCM - 120' HD & GCM.

DST #2 15-45-60-60 IHP 1558# ISIP 774#

2954' 2985'

IF 58-58# FF 70-93# FSIP 727# FHP 1558#

WEAK TO STRONG BLOW. REC. 10' SL. OIL CUT WATERY MUD - 120' WATERY MUD.

DST #3 15-45-60-60 1HP 1627# 1SIP 528#
 IF 35-35# FF 46-58# FSIP 328# FHP 1627#
 VERY WEAK BLOW. REC. 60' WATERY MUD WITH SPECKS
 OF OIL ON TOP.

DST #4 30-45-60-60 1HP 1649# 1SIP 821#
 IF 23-35# FF 35-46# FSIP 762# FHP 1649#
 VERY WEAK BLOW. REC. 20' OCM - 40' THIN WATERY MUD.

	TOP	BOTTOM
DST #3	3110'	3130'
DST #4	3131'	3147'