

15-063-20348

## State Geological Survey

WICHITA BRANCH  
KANSAS DRILLERS LOGAPI No. 15 — 063 — 20,348  
County NumberS. 31 T. 14 R. 29 E W  
Loc. 2050' FEL & 1000' FSL  
County GoveOperator  
Energy Reserves Group, Inc.Address  
P. O. Box 1201, Wichita, Kansas 67202

Well No. #4 Lease Name E. J. Lundgren "A"

Footage Location  
2050' feet from (N) (S) line 1000 South  
feet from (X) (Y) linePrincipal Contractor Geologist  
Slawson Drilling Co. Bob Hammond

Spud Date 6-23-77 Total Depth RTD 4400' P.B.T.D. 4365'

Date Completed 9-1-77 Oil Purchaser WIW

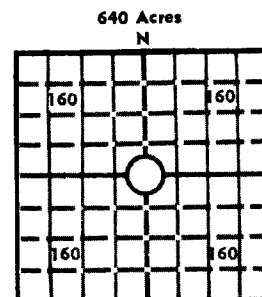

Locate well correctly

Elev.: Gr. 2645'

DF KB 2650'

## CASING RECORD

Report of all strings set — surface, intermediate, production, etc.

| Purpose of string | Size hole drilled | Size casing set (in O.D.) | Weight lbs/ft. | Setting depth | Type cement      | Sacks         | Type and percent additives |
|-------------------|-------------------|---------------------------|----------------|---------------|------------------|---------------|----------------------------|
| Surface           | 12-1/4"           | 8-5/8"                    | 24#            | 195           | Common 50-50 poz | 50 sx 100 sx. | 2% gel 2% CaCl             |
| Oil string        | 4-1/2"            |                           | 11#            | 4396'         |                  | 910 sx        |                            |
|                   |                   |                           |                |               |                  |               |                            |
|                   |                   |                           |                |               |                  |               |                            |

## LINER RECORD

## PERFORATION RECORD

| Top, ft. | Bottom, ft. | Sacks cement | Shots per ft.<br>3/jets/ft | Size & type | Depth interval |
|----------|-------------|--------------|----------------------------|-------------|----------------|
|          |             |              |                            |             | 4311-14        |
|          |             |              | "                          |             | 4317-20        |
|          |             |              | "                          |             | 4324-30        |

## TUBING RECORD

| Size           | Setting depth | Packer set at |  |  |
|----------------|---------------|---------------|--|--|
| 2 3/8" Duoline |               | 4285'         |  |  |

## ACID, FRACTURE, SHOT, CEMENT SQUEEZE RECORD

| Amount and kind of material used | Depth interval treated |
|----------------------------------|------------------------|
| A/500 15% MCA                    | 4234-30'               |
| A/1500 gal. MOD-202              | 4317-20", 4311-14'     |
|                                  |                        |

## INITIAL PRODUCTION

|  |       |   |                        |               |      |
|--|-------|---|------------------------|---------------|------|
| Date of first production                           |       | Producing method (flowing, pumping, gas lift, etc.) |                        |               |      |
| 9-1-77   |       | WIW 564 BWPD  |                        |               |      |
| RATE OF PRODUCTION<br>PER 24 HOURS                 | Oil   | Gas   | Water                  | Gas-oil ratio |      |
|  | bbls. | MCF   | 564 bbls.              |               | CFPB |
| Disposition of gas (vented, used on lease or sold) |       |   | Producing interval (s) |               |      |

INSTRUCTIONS: As provided in KCC Rule 82-2-125, within 90 days after completion of a well, one completed copy of this Drillers Log shall be transmitted to the State Geological Survey of Kansas, 4150 Monroe Street, Wichita, Kansas 67209. Copies of this form are available from the Conservation Division, State Corporation Commission, 3830 So. Meridian (P.O. Box 17027), Wichita, Kansas 66217. Phone AC 316-522-2206. If confidential custody is desired, please note Rule 82-2-125. Drillers Logs will be on open file in the Oil and Gas Division, State Geological Survey of Kansas, Lawrence, Kansas 66044.

|   |   |   |   |
|---|---|---|---|
| Operator<br><b>Slawson Energy Reserves Group, Inc.</b>  |   | DESIGNATE TYPE OF COMP.: OIL, GAS,<br>DRY HOLE, SWDW, ETC.:<br><b>SWI</b> |   |
| Well No.<br><b>#4</b>   | Lease Name<br><b>E. J. Lundgren "A"</b>   |   |   |
| s ec <b>31</b> T <b>14</b> R <b>29</b> <b>SW</b>  |   | <b>Gove County, Kansas</b>  |   |
| <b>WELL LOG</b>   |   | SHOW GEOLOGICAL MARKERS, LOGS RUN,<br>OR OTHER DESCRIPTIVE INFORMATION.   |   |
| Show all important zones of porosity and contents thereof; cored intervals, and all drill-stem tests, including depth interval tested, cushion used, time tool open, flowing and shut-in pressures, and recoveries. |   |   |   |
| FORMATION DESCRIPTION, CONTENTS, ETC.   | TOP   | BOTTOM  | NAME  |
|   |   |   | <b>Heebner</b> 3660 (-1010)<br><b>Lansing</b> 3697 (-1047)<br><b>Stark Shale</b><br><b>Pawnee</b> 4140 (-1490)<br><b>Ft. Scott</b> 4202 (-1552)<br><b>Cherokee</b> 4228 (-1578)<br><b>Miss-St. Louis</b> 4301 (-1651)<br><b>Dolo</b> 4310 (-1660) |
| USE ADDITIONAL SHEETS, IF NECESSARY, TO COMPLETE WELL RECORD.   |   |   |   |
| Date Received   | <div style="text-align: right;"> <b>Energy Reserves Group, Inc.</b><br/>           Signature<br/> <br/> <b>John Mullen</b> Title <b>Sr. Geologist</b><br/> <b>Sept. 21, 1977</b><br/>           Date         </div> |   |   |

31-14-29W

DRILLERS LOG

OCT 25 1983  
KANSAS GEOLOGICAL SURVEY  
WICHITA BRANCH

OPERATOR: Energy Reserves Group, Inc.  
1022 Hoover Street  
Great Bend, Kansas 67530

CONTRACTOR: Slawson Drilling Company, Inc.  
408 One Twenty Building  
Wichita, Kansas 67202

LEASE: Lundgren 'A' No. 4  
2050' FEL & 1000' FSL  
Sec. 31-14S-29W  
Gove County, Kansas

COMMENCED: June 23, 1977

COMPLETED: June 29, 1977

RTD: 4400'

CASING: 8-5/8" set at 192' with 150 sx cement

OIL STRING: 4-1/2" set at 4396' with 910 sx cement

0' to 204' Shale (12 1/2" Surface Hole)  
204' to 1241' Shale  
1241' to 2044' Shale  
2044' to 2100' Anhydrite  
2100' to 2420' Shale & Lime  
2420' to 2851' Lime & Shale  
2851' to 3076' Shale & Lime  
3076' to 3500' Lime & Shale  
3500' to 3727' Shale & Lime  
3727' to 4077' Lime & Shale  
4077' to 4222' Shale & Lime  
4222' to 4355' Lime & Shale  
4355' to 4400' Lime  
4400' RTD

RECEIVED  
STATE CORPORATION COMMISSION  
OCT 10 1983  
CONSERVATION DIVISION  
Wichita, Kansas

STATE OF KANSAS

COUNTY OF SEDGWICK

I, Jim Thatcher, of the Slawson Drilling Company, Inc.  
hereby state that the above and foregoing is a true and accurate  
copy of the log of the Lundgren 'A' No. 4.

JIM THATCHER  
Jim Thatcher

Subscribed and sworn to me on this 11th day of July, 1977.

Mary Lou Taylor  
Mary Lou Taylor, Notary

My commission expires January 17, 1981

