

32-14-42W

State Geological Survey

WICHITA BRANCH
KANSAS DRILLERS LOG

IMPORTANT
Kans. Geo. Survey request
samples on this well.

API No. 15 _____ County _____ Number - 199-20,006

Operator
Ute Prod. Co.

Address
PO Box 1743 GRAND JUNCTION, Colo 81501

Well No. #32-41 Lease Name Neena Development Corp.

Footage Location
665 feet from (N) line 665 feet from (E) line

Principal Contractor STERLING DRILLING Co Geologist OCCIDENTAL PET. Co

Spud Date 4-20-72 Total Depth 5280' P.B.T.D.

Date Completed 5-16-72 Oil Purchaser DRY HOLE.

S. 32 T. 14 R. 42 W NE NE
Loc. 660' WEL & 660' SNL (Intent)
County Wallace

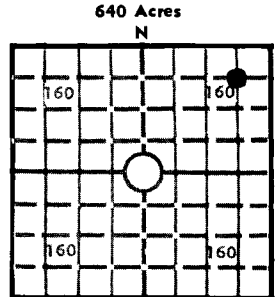

Locate well correctly
Elev.: Gr. 3842
DF 3853 KB 3856

CASING RECORD

Report of all strings set — surface, intermediate, production, etc.

Purpose of string	Size hole drilled	Size casing set (in O.D.)	Weight lbs/ft.	Setting depth	Type cement	Sacks	Type and percent additives
SURFACE	15"	10 3/4		494'	NEAT	165	35% Pozmix
INTERMEDIATE	9 7/8	7 5/8	26.4#	1155'	NEAT	250	NEAT

LINER RECORD

PERFORATION RECORD

Top, ft.	Bottom, ft.	Sacks cement	Shots per ft.	Size & type	Depth interval
NONE			NONE		

Size	Setting depth	Packer set at
NONE		NONE

ACID, FRACTURE, SHOT, CEMENT SQUEEZE RECORD

Amount and kind of material used	Depth interval treated
LOST CIR. SQUEEZED OF 2510X - HELD.	517'

INITIAL PRODUCTION

Date of first production NONE	Producing method (flowing, pumping, gas lift, etc.) NONE			
RATE OF PRODUCTION PER 24 HOURS	Oil NONE bbls.	Gas NONE MCF	Water NONE bbls.	Gas-oil ratio NONE CFPB
Disposition of gas (vented, used on lease or sold) NONE		Producing interval (s) NONE		

INSTRUCTIONS: As provided in KCC Rule 82-2-125, within 90 days after completion of a well, one completed copy of this Drillers Log shall be transmitted to the State Geological Survey of Kansas, 4150 Monroe Street, Wichita, Kansas 67209. Copies of this form are available from the Conservation Division, State Corporation Commission, 3830 So. Meridian (P.O. Box 17027), Wichita, Kansas 66217. Phone AC 316-522-2206. If confidential custody is desired, please note Rule 82-2-125. Drillers Logs will be on open file in the Oil and Gas Division, State Geological Survey of Kansas, Lawrence, Kansas 66044.

