

WICHITA BRANCH
WELL COMPLETION REPORT AND
DRILLER'S LOG

API No. 15 _____ County _____ Number _____

S. 13 T. 15 R. 11W ^E/_W
Loc. W/2 of NW/4
County Russell

Operator
Pan-Western Petroleum, Inc.

Address
1408 Douglas Bldg., Wichita, Kansas 67202

Well No. 1 Lease Name Bouska

Footage Location
feet from (N) (S) line _____ feet from (E) (W) line _____

Principal Contractor Revlin Drilg., Inc. Geologist Toby Elster

Spud Date 2-13-80 Date Completed 2-20-80 Total Depth 3338' R.T.D. P.B.T.D. _____

Directional Deviation _____ Oil and/or Gas Purchaser _____

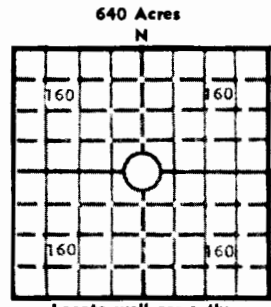

Elev.: Gr. _____
DF _____ KB 1829' K.B.

CASING RECORD

Report of all strings set — surface, intermediate, production, etc.

Purpose of string	Size hole drilled	Size casing set (in O.D.)	Weight lbs/ft.	Setting depth	Type cement	Sacks	Type and percent additives
Surface	12 1/4	8 5/8	28#	239.25	Sun-Set	160	

LINER RECORD

PERFORATION RECORD

Top, ft.	Bottom, ft.	Sacks cement	Shots per ft.	Size & type	Depth interval

TUBING RECORD

Size	Setting depth	Packer set at

ACID, FRACTURE, SHOT, CEMENT SQUEEZE RECORD

Amount and kind of material used	Depth interval treated

INITIAL PRODUCTION

Date of first production _____		Producing method (flowing, pumping, gas lift, etc.) _____			
RATE OF PRODUCTION PER 24 HOURS	Oil _____ bbls.	Gas _____ MCF	Water _____ bbls.	Gas-oil ratio _____	CFPB _____
Disposition of gas (vented, used on lease or sold) _____			Producing interval (s) _____		

INSTRUCTIONS: As provided in KCC Rule 82-2-125, within 90 days after completion of a well, one completed copy of this Drillers Log shall be transmitted to the State Geological Survey of Kansas, 4150 Monroe Street, Wichita, Kansas 67209. Copies of this form are available from the Conservation Division, State Corporation Commission, 245 No. Water, Wichita, Kansas 67202. Phone AC 316-522-2206. If confidential custody is desired, please note Rule 82-2-125. Drillers Logs will be on open file in the Oil and Gas Division, State Geological Survey of Kansas, Lawrence, Kansas 66044.

Operator
Pan-Western Petroleum, Inc.

DESIGNATE TYPE OF COMP.: OIL, GAS,
 DRY HOLE, SWDW, ETC.:

Well No. **1**

Lease Name **Bouska**

D & A

S **13** T **15** R **11** W ^E/_W

WELL LOG

Show all important zones of porosity and contents thereof; cored intervals, and all drill-stem tests, including depth interval tested, cushion used, time tool open, flowing and shut-in pressures, and recoveries.

SHOW GEOLOGICAL MARKERS, LOGS RUN, OR OTHER DESCRIPTIVE INFORMATION.

FORMATION DESCRIPTION, CONTENTS, ETC.	TOP	BOTTOM	NAME	DEPTH
Postrock Shale	0	249	R.T.D.	
Shale	249	678		
Anhydrite	678	708		
Shale	708	800		
Shale	800	1130		
Shale-Line	1130	1560		
Shale w/Line	1560	1850		
Shale	1850	2083		
Line-Shale	2083	2367		
Shale w/Line	2367	2602		
Shale - Shale	2602	2730		
Shale - Line	2730	2877		
Shale w/Line	2877	3030		
Line	3030	3062		
Line	3062	3150		
Line	3150	3270		
Line	3270	3326		
Conglomerate	3326	3338		

USE ADDITIONAL SHEETS, IF NECESSARY, TO COMPLETE WELL RECORD.

Date Received

 Signature
Bookkeeper, Revlin Drilg., Inc.
 Title
February 25, 1980
 Date

111862