

KANSAS

Map No. 55 Sec. 9 Twp. 15 R. 12W

Well No. 4 Kaufman

Texas Company

FIRST REPORT Contractor

C SE NW

SECTION PLAT

Ft. from N. Line

660 Ft. from S. Line

660 Ft. from E. Line

Ft. from W. Line

Hall-Gurney Pool

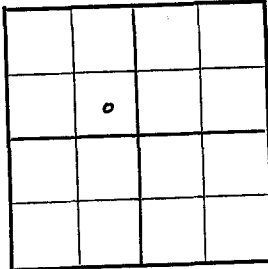

Location

Rig up

Drilling and Remarks:

Rotary

RECORD

Cased in, ft.

Sand

Gas

Oil

Total Depth

PRODUCTION

1st 24 hrs. Nat.

1st 24 hrs. after shot

Gas Cu. Ft.

Dry Hole

Abandoned

Date

AUG 25 1943 19

S. J. LEWIS Scout

KANSAS

Map No. 55 Sec. 9 Twp. 15 R. 12W

Well No. 4 Kaufman

Texas Company

ABANDONED Contractor

C SE NW

SECTION PLAT

Ft. from N. Line

660 Ft. from S. Line

660 Ft. from E. Line

Ft. from W. Line

Hall-Gurney Pool

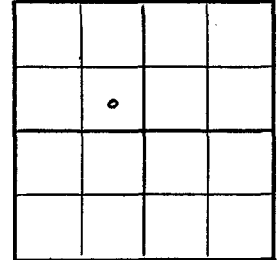

Location

Rig up

Drilling and Remarks:

*8 1/2 km 3297*

*7" casing*

*250' x 5" line 3301*

*Notes*

RECORD

Cased in, ft.

Sand

Gas

Oil

Total Depth *3331*

PRODUCTION

1st 24 hrs. Nat.

1st 24 hrs. after shot

Gas Cu. Ft.

Dry Hole

Abandoned

Date

OCT 13 1943 19

S. J. LEWIS Scout

KANSAS

Russell

Sec. 9 Twp. 15 R. 12-W

Well No. #4 Kaufman Farm \_\_\_\_\_

Texas Company \_\_\_\_\_

1943  
10/13

Gornham 3297  
7" @ 3084"  
250' of 5" liner 3301  
Water ~  
T.D. 3331'

ABANDONED

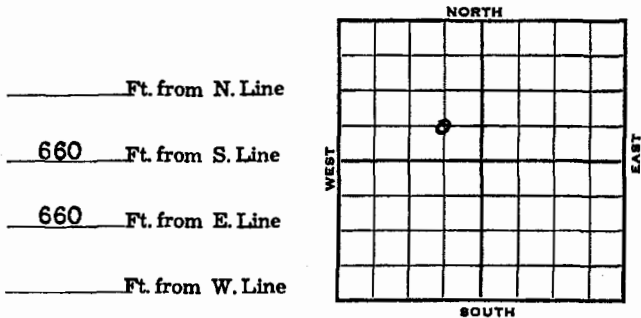

*ELEV. 1858*

1943	REPORT
8/25	Rotary
9/1	13" @ 367' Drlg. 1460'
9/8	Lans 3304 SO 3016-20 T.D. 3096 7" @ 3084 Rust
10/15	4000 acid
9/22	Pump 10 oil & 15 water in 15 hrs fsg.
9/29	Drlg. 3301
10/6	Cong 3284 Gornham 3297 T.D. 3331 250' of 5" lime @ 3301 PB

OVER

Section 9 Township 15 Range 12-W

Well No. #4 Kaufman

Company Texas

