

County <u>Russell</u> Elev. _____				Co.
Sec. <u>14</u> Twp. <u>19</u> Rge. <u>12W</u>				
Company <u>Shields Oil Prod.</u>				No.
Farm Name <u>Gustafson Est.</u> No. <u>2</u>				
TOPS	DEPTH	LOG	DATUM	Loc. in Sec.
Anh.				NW NE NW
Tr.				
H.				
Tr.				
Dg.				
Bl.				
L.				
K.C.				
B.K.C.				
Ce.				
C.				Geol. _____
M.				Contr. _____
M.				Co. tools _____
K.				Pool _____
Mz.				Gustafson
Me.				FIRST REPORT MAY 9 '56
V.				
S.				
S.				
A.				
R.				
PE.				
G.				
TD.				
Date Comm. <u>Cellar & pits</u>				
				T.
				R.

County <u>Russell</u> Elev. <u>1783</u>				Co.
Sec. <u>14</u> Twp. <u>19</u> Rge. <u>12W</u>				
Company <u>Shields Oil Prod.</u>				No.
Farm Name <u>Gustafson Est.</u> No. <u>2</u>				
TOPS	DEPTH	LOG	DATUM	Loc. in Sec.
Anh.				NW NE NW
Tr.				
H.				
Tr.	<u>Dodge</u>	<u>2849</u>		
Dg.				
Bl.				
L.				
K.C.				
B.K.C.				
Ce.				
C.				Geol. _____
M.				Contr. _____
M.				Co. tools _____
K.				Pool _____
Mz.				Gustafson
Me.				COMPLETE
V.				
S.				
S.				
A.				
R.				
PE.				
G.				
TD.	<u>2857</u>			
Date Comm. <u>Cellar & pits</u>				
				T.
				R.

JUN 6 '56 JUN 13 '56 JUN 20 '56 JUN 27 '56 JUL 3 '56
6-30-56 R29 10" @ 831
JUL 11 '56 PTD 1.971 @ 18'56 P 2526
JUL 23 '56 7" @ 2851/50 AUG 1 '56 CO
2857 TD @ 2 3/4 Boph no/w
11 @ 5 1/2 Boph no/w 7 hrs
AUG 8 '56 AUG 15 P. 25 Boph
 no wtr.

Russell KANSAS

SEC. 14 TWP. 15 R. 12W

WELL NO. #2 Gustafson Est. FARM

COMPANY Shields Oil Prod.

CONTRACTOR Co. Tools

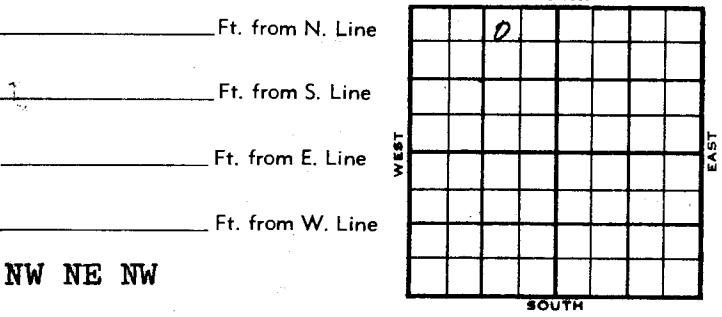

1956 ELEVATION 1783' REPORT

5-9 Cellar & pits
 8-15 Comm. 6-30-56
 10" @ 831
 RTD 1971
 7" @ 2851 w/50
 CO 2857
 S/ 2 3/4 BOPH, no/wtr.,
 S/ 5 1/2 boph, no/wtr., 7 hrs.
 P/ 25 bopd, no wtr.
 H. 2841'; Dodge 2849';
 TD 2857'

COMPLETED

DX-78

Russell KANSAS

SECTION 14 TOWNSHIP 15 RANGE 12W

WELL NO. #2 Gustafson Estate

COMPANY Shields Oil Prod.

