

REPORT

FORM 513 REV. SUNRAY

County Ellis Elev. _____				Loc. in Sec. NE NW NW
Sec. 13 Twp. 15 Rge. 18W				
Company Alpine Oil & Royalty				
FarmName T. S. Lieker No. 4				
TOPS	DEPTH	LOG	DATUM	Geol. _____ Contr. _____ Co. tools Pool _____ E. Lieker
Anh. 1160				
TP.				
H.				
Tr.				
Dg.				
Bl.				
L.				
K.C.				
B.K.C.				
Ce.				
C.				
M.				
M.				
K.				
Mz.				
Me.				
V.				
S.				
S.				
A.				
R.				
PC.				
G.				
TD.				
Date Comm. 5-13-55				No. _____ Sec. _____ T. _____ R. _____
8" @ 1168 w/ 550 drlg. 1320				

FORM 513 REV. SUNRAY

County Ellis Elev. 2015				Loc. in Sec. NE NW NW
Sec. 13 Twp. 15 Rge. 18W				
Company Alpine Oil & Royalty				
FarmName T. S. Lieker No. 4				
TOPS	DEPTH	LOG	DATUM	Geol. _____ Contr. _____ Quaker Pool _____ E. Lieker
Anh.				
TP.				
H.	3247		1232	
Tr.				
Dg.				
Bl.				
L.	3296		1281	
K.C.				
B.K.C.				
Ce.				
C.	3561		1576	
M.				
M.				
K.				
Mz.				
Me.				
V.				
S.				
S.				
A.	3570		1575	
R.				
PC.				
G.				
TD.	3594			
Date Comm. 5-13-55 AUG 1 0 1955				No. _____ Sec. _____ T. _____ R. _____
8" @ 1168/550 DST 3303-28 open 13 min.				
gas in 18 min. Rec. 1200' gassy oil				
30' ho & gcm 760/30" DST 3446-74				
open 25 min. gas in 15 min. Rec. 1380'				
oil 60' oily mud 1230/30" 5 1/2" @ 3592				
CO 3594 S/ 3 boph 500 A S/ 20 boph				
10 hr. P/ 15 boph Comp. 341 bopd				

Ellis KANSAS

SEC. 13 TWP. 15 R. 18W

WELL NO. 4 T. S. Lieker FARM

COMPANY Alpine Oil & Royalty

CONTRACTOR Co. Tools E. Lieker

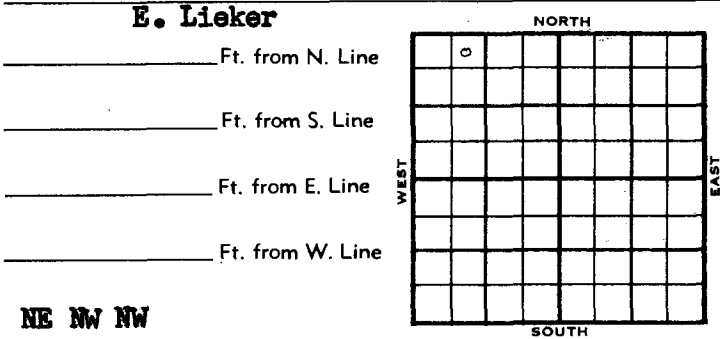

1955 ELEVATION 2015' REPORT

5-26 Comm 5-13-55
 8" @ 1168 w/550
 Anhy 1160'
 Drlg 1320

8/10 Comm 5-13-55
 H 3247
 L 3296
 C 3561
 A 3590
 TD 3594
 8" @ 1168/550 DST 3303-28 open 13
 min. gas in 18 min. Rec 1200' gassy
 oil 30' ho & gcm 760/30" DST 3446-74
 open 25 min. gas in 15 min. Rec 1380'
 oil 60' oily mud 1230/30" 5 1/2"
 @ 3592 CO 3594 S/3 boph 500 A
 S/20 boph 10 hr P/15 boph
 Comp 341 BOPD

COMPLETED

DX 78-1 Ellis KANSAS

Section 13 Township 15 Range 18W

Well No. #4 T. S. Lieker

Company Alpine Oil & Royalty

