

Map No. 75 Sec. 22 Twp. 15 R. 19W

Well No. 1 Heel

Empire Company

Contractor

SECTION PLAT

Ft. from N. Line

330 Ft. from S. Line

330 Ft. from E. Line

Ft. from W. Line

FIRST REPORT

Location

Rig up

Drilling and Remarks:

Rig
at 12 To 10

RECORD

Cased in., ft.

Sand

Gas

Oil

Total Depth

PRODUCTION

1st 24 hrs. Nat.

1st 24 hrs. after shot

Gas Cu. Ft.

Dry Hole

Abandoned

Date

APR 22 1936 192 S. J. LEWIS Scout

Map No. 75 Sec. 22 Twp. 15 R. 19W

Well No. 1 Heel

Empire Company

Contractor

SECTION PLAT

Ft. from N. Line

330 Ft. from S. Line

330 Ft. from E. Line

Ft. from W. Line

ABANDONED

Location

Rig up

Drilling and Remarks:

Conglomerate
3562

Basal Sand
3568

HW 392

IT+H

RECORD

Cased in., ft.

Sand

Gas

Oil 3598?

Total Depth 8298

PRODUCTION

1st 24 hrs. Nat.

1st 24 hrs. after shot

Gas Cu. Ft.

Dry Hole

Abandoned

Date

AUG 12 1936 19 S. J. LEWIS Scout

Map No. **KANSAS** Sec. **22** Twp. **15** R. **19-W**

Well No. **1-Herl** Farm
Empire Company

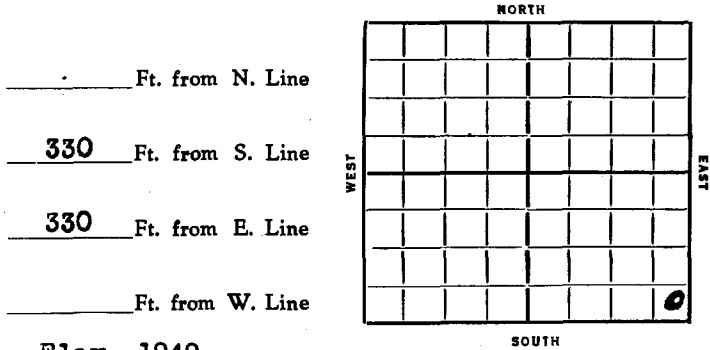

Date	REPORT
1936	
4/22	Rig--cable tools
4/30	Rigging up.
5/7	--
5/14	15" @ 440' Drlg.
5/21	Drlg. 860'.
5/28	Run 12" @ 1142'.
6/4	Drlg. 1595'.
6/11	Drlg. 2240'.
6/18	2535' fishing.
6/25	Drlg. 2625'.
7/2	2775'. Shut down.
7/9	Cleaning out.
7/16	Drlg. 3100'.
7/23	8" @ 3200'. Drlg. 3251'.
7/30	Oswald 3245'. Under ream 8".
8/6	8" @ 3368'. Conglomerate 3490'. Siliceous 3523'. Run 7" @ 3525'.
8/12/36	Conglomerate 3522'. 3598 Basil Sand 3568'. TD 3298'. HPW 3892'. Dry and abandoned.
ABANDONED	

Section **22** Township **15** Range **19-W**

Well Number **1-Herl**

Company **Empire**

