

STATE CORPORATION COMMISSION OF KANSAS
OIL & GAS CONSERVATION DIVISION
WELL COMPLETION OR RECOMPLETION FORM
ACO-1 WELL HISTORY
DESCRIPTION OF WELL AND LEASE

Operator: License # 5663
Name Hess Oil Company
Address P.O. Box 1009
City/State/Zip McPherson, KS 67460

Purchaser Clear Creek, Inc.

Operator Contact Person Bryan Hess
Phone 316-241-4640

Contractor: License # 4958
Name Mallard JV, Inc.

Wellsite Geologist James C. Hess
Phone 316-263-2243

Designate Type of Completion
 New Well Re-Entry Workover
 Oil SWD Temp Abd
 Gas Inj Delayed Comp.
 Dry Other (Core, Water Supply etc.)

If OWO: old well info as follows:
Operator
Well Name
Comp. Date Old Total Depth

WELL HISTORY

Drilling Method:
 Mud Rotary Air Rotary Cable
8-31-88 9-6-88 10-7-88
Spud Date Date Reached TD Completion Date
4355'
Total Depth PBTD

Amount of Surface Pipe Set and Cemented at 203 feet
Multiple Stage Cementing Collar Used? Yes No
If yes, show depth set feet
If alternate 2 completion, cement circulated from 4340 feet depth to surface 450 SX cmt
Cement Company Name Allied
Invoice # 52541

API NO. 15-195-21,989
County Trego
Appx. SW NE Sec. 33 Twp. 15 Rge. 25 East
3580 Ft North from Southeast Corner of Section
2050 Ft West from Southeast Corner of Section
(Note: Locate well in section plat below)

Lease Name Basinger "B" Well # 1
Field Name
Producing Formation Mississippi Dolomite
Elevation: Ground 2427' KB 2435'

JAN 18 1989

RECEIVED

STATE CORPORATION COMMISSION

JAN 17 1989

CONSERVATION DIVISION
Wichita, Kansas

KANSAS GEOLOGICAL SURVEY
WICHITA BRANCH

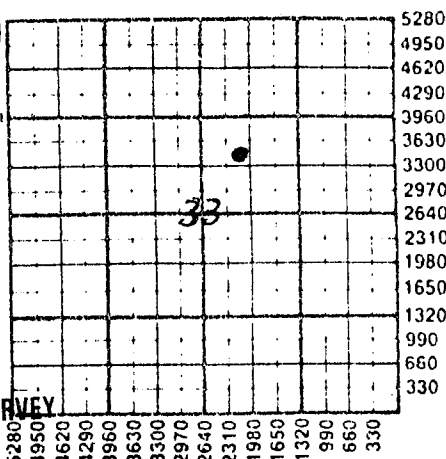

WATER SUPPLY INFORMATION

Disposition of Produced Water: Disposal
Docket # D-24,998 Repressuring
(No water production)

Questions on this portion of the ACO-1 call:

Water Resources Board (913) 296-3717

Source of Water:
Division of Water Resources Permit #

Groundwater Ft North from Southeast Corner (Well) Ft West from Southeast Corner of Sec Twp Rge East West

Surface Water 1320 Ft North from Southeast Corner (Stream, pond etc.) 1320 Ft West from Southeast Corner Sec 14 Twp 16 Rge 26 East West

Other (explain) (purchased from city, R.W.D. #)

INSTRUCTIONS: This form shall be completed in triplicate and filed with the Kansas Corporation Commission, 200 Colorado Derby Building, Wichita, Kansas 67202, within 120 days of the spud date of any well. Rule 82-3-130, 82-3-107 and 82-3-106 apply. Information on side two of this form will be held confidential for a period of 12 months if requested in writing and submitted with the form. See rule 82-3-107 for confidentiality in excess of 12 months. One copy of all wireline logs and drillers time log shall be attached with this form. Submit CP-4 form with all plugged wells. Submit CP-111 form with all temporarily abandoned wells.

All requirements of the statutes, rules and regulations promulgated to regulate the oil and gas industry have been fully complied with and the statements herein are complete and correct to the best of my knowledge.

Signature Bryan Hess, Mgr.
Title Date 1-16-89

Subscribed and sworn to before me this 16th day of January 1989
Notary Public Don J. Reichenberger
Date Commission Expires 11-15-89

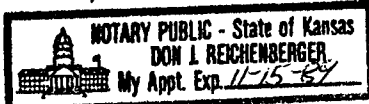

K.C.C. OFFICE USE ONLY
F Letter of Confidentiality Attached
C Wireline Log Received
C Drillers Time Log Received
Distribution
 KCC SWD/Rep NGPA
 KGS Plug Other (Specify)

Sec. 33 Twp. 15 Rge. 25W

Operator Name Hess Oil Company Lease Name Basinger "B" Well # 1

Sec. 33 Twp. 15 Rge. 25 East West County Trego

WELL LOG

INSTRUCTIONS: Show important tops and base of formations penetrated. Detail all cores. Report all drill stem tests giving interval tested, time tool open and closed, flowing and shut-in pressures, whether shut-in pressure reached static level, hydrostatic pressures, bottom hole temperature, fluid recovery, and flow rates if gas to surface during test. Attach extra sheet if more space is needed. Attach copy of log.

.....

Drill Stem Tests Taken Yes No
 Samples Sent to Geological Survey Yes No
 Cores Taken Yes No

Formation Description
 Log Sample

DST#1: 4320' - 4355'. 30-30-60-60. Blow off bottom of bucket in 27 min. 2nd open off bottom of bucket in 29 min. Recovered 250' gas in pipe, 170' free oil, 270' mud cut oil (75% oil, 25% mud). Pressures: IH 2245#, IF 116-148, ISIP 1075, FF 180-222, FSIP 1125, FF 2115. Temp 136.

Name	Top	Bottom
Anhydrite	1861'	1899'
Heebner	3714	
Lansing	3758	
Stark Shale	3988	
Base K.C.		4046
Marmaton	4087	
Pawnee	4175	
Fort Scott	4247	
Cherokee Shale	4274	
Miss. Dolomite	4340	
R.T.D.	4355	

CASING RECORD <input type="checkbox"/> New <input checked="" type="checkbox"/> Used							
Report all strings set-conductor, surface, intermediate, production, etc.							
Purpose of String	Size Hole Drilled	Size Casing Set (in O.D.)	Weight Lbs/Ft.	Setting Depth	Type of Cement	#Sacks Used	Type and Percent Additives
Surface	12 1/2"	8-5/8"	20	203'	60/40 Poz	150	.3% gel, 2% cc
Production		4 1/2"	9.5	4340' and	ATL and 60/40 Poz	300 150	1# Floccal
PERFORATION RECORD				Acid, Fracture, Shot, Cement Squeeze Record (Amount and Kind of Material Used)			
Shots Per Foot	Specify Footage of Each Interval Perforated					Depth	
				500 gal. 15%		4340' - 4355'	
	then			500 gal. 28% and			
				500 gal. 15%			
TUBING RECORD				Liner Run <input type="checkbox"/> Yes <input checked="" type="checkbox"/> No			
Date of First Production		Set At		Racker at			
October 7, 1988		4343'					
Date of First Production		Producing Method <input type="checkbox"/> Flowing <input checked="" type="checkbox"/> Pumping <input type="checkbox"/> Gas Lift <input type="checkbox"/> Other (explain).....					
Estimated Production Per 24 Hours		Oil	Gas	Water	Gas-Oil Ratio	Gravity	
21				0		38	
		Bbls	MCF	Bbls	CFPB		

METHOD OF COMPLETION

Production Interval

Disposition of gas: Vented Open Hole Perforation
 Sold Other (Specify)
 Used on Lease Dually Completed Commingled

4340' - 4355'