

STATE CORPORATION COMMISSION OF KANSAS
OIL & GAS CONSERVATION DIVISION
WELL COMPLETION OR RECOMPLETION FORM
ACO-1 WELL HISTORY
DESCRIPTION OF WELL AND LEASE

Operator: License # 5663
Name Hess Oil Company
Address P.O. Box 1009
City/State/Zip McPherson, KS 67460

Purchaser

Operator Contact Person Bryan Hess
Phone 316-241-4640

Contractor: License # 4958
Name Mallard JV, Inc.

Wellsite Geologist James C. Hess
Phone 316-263-2243

Designate Type of Completion
 New Well Re-Entry Workover

Oil SWD Temp Abd
 Gas Inj Delayed Comp.
 Dry Other (Core, Water Supply etc.)

If OWNED: old well info as follows:

Operator
Well Name
Comp. Date Old Total Depth

WELL HISTORY

Drilling Method:
 Mud Rotary Air Rotary Cable

4-12-89 4-18-89 4-18-89
Spud Date Date Reached TD Completion Date

4415'
Total Depth PBTD

Amount of Surface Pipe Set and Cemented at 200 feet
Multiple Stage Cementing Collar Used? Yes No
If yes, show depth set feet
If alternate 2 completion, cement circulated from feet depth to w/SX cmt
Cement Company Name
Invoice #

API NO. 15-195-22,010
County Trago
50' N. of East
E/2 SE NW Sec 33 Twp 15 Rge 25 X West

3350 Ft North from Southeast Corner of Section
2970 Ft West from Southeast Corner of Section
(Note: Locate well in section plat below)

Lease Name Basinger "C" Well # 1

Field Name

Producing Formation

Elevation: Ground 2452' KB 2460'

Section Plat

MAY 12 1989

KANSAS GEOLOGICAL SURVEY
WICHITA BRANCH

MAY 10 1989

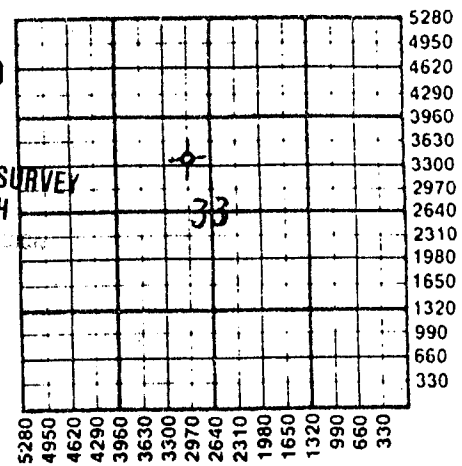

WATER SUPPLY INFORMATION

Disposition of Produced Water: Disposal
Docket # Repressuring

Questions on this portion of the ACO-1 call:
Water Resources Board (913) 296-3717

Source of Water:
Division of Water Resources Permit # 37935

Groundwater Ft North from Southeast Corner
(Well) Ft West from Southeast Corner of
Sec Twp Rge East West

X Surface Water 2310 Ft North from Southeast Corner
(Stream, pond etc) 1230 Ft West from Southeast Corner
SE 1/4 Sec 14 Twp 16 Rge 26 East XX West

Other (explain)
(purchased from city, R.W.D. #)

INSTRUCTIONS: This form shall be completed in triplicate and filed with the Kansas Corporation Commission, 200 Colorado Derby Building, Wichita, Kansas 67202, within 120 days of the spud date of any well. Rule 82-3-130, 82-3-107 and 82-3-106 apply. Information on side two of this form will be held confidential for a period of 12 months if requested in writing and submitted with the form. See rule 82-3-107 for confidentiality in excess of 12 months. One copy of all wireline logs and drillers time log shall be attached with this form. Submit CP-4 form with all plugged wells. Submit CP-111 form with all temporarily abandoned wells.

Operator Name Hess Oil Company Lease Name..... Basinger "C" Well #..... 1

Sec. 33 Twp. 15 Rge. 25 East West County..... Trego

WELL LOG

INSTRUCTIONS: Show important tops and base of formations penetrated. Detail all cores. Report all drill stem tests giving interval tested, time tool open and closed, flowing and shut-in pressures, whether shut-in pressure reached static level, hydrostatic pressures, bottom hole temperature, fluid recovery, and flow rates if gas to surface during test. Attach extra sheet if more space is needed. Attach copy of log.

Drill Stem Tests Taken Yes No
 Samples Sent to Geological Survey Yes No
 Cores Taken Yes No

Formation Description
 Log Sample

Name	Top	Datum Bottom
Anhydrite	1883	(+577)
B/Anhydrite	1921	(+539)
Heebner	3738	(-1278)
Lansing	3780	(-1320)
Stark Shale	4017	(-1557)
B/ K.C.	4078	(-1618)
Marmaton	4124	(-1664)
Pawnee	4210	(-1750)
Fort Scott	4284	(-1824)
Cherokee Shale	4309	(-1849)
Mississippi Dolomite	4398	(-1938)
R.T.D.	4415	(-1955)

CASING RECORD <input type="checkbox"/> New <input checked="" type="checkbox"/> Used							
Report all strings set-conductor, surface, intermediate, production, etc.							
Purpose of String	Size Hole Drilled	Size Casing Set (in O.D.)	Weight Lbs/Ft.	Setting Depth	Type of Cement	#Sacks Used	Type and Percent Additives
Surface	12 1/4"	8-5/8"	32#	200'	60/40Poz.	140	3% cc., 2% gel
PERFORATION RECORD				Acid, Fracture, Shot, Cement Squeeze Record			
Shots Per Foot	Specify Footage of Each Interval Perforated			(Amount and Kind of Material Used)		Depth	
.....	
.....	
.....	
TUBING RECORD				Liner Run <input type="checkbox"/> Yes <input type="checkbox"/> No			
Date of First Production		Producing Method					
		<input type="checkbox"/> Flowing <input type="checkbox"/> Pumping <input type="checkbox"/> Gas Lift <input type="checkbox"/> Other (explain).....					

33-15-25W

MALLARD JV, INC.
P.O. BOX 1009
McPHERSON, KS 67460

DRILLERS' LOG

OPERATOR: Hess Oil Company
P.O. Box 1009
McPherson, KS 67460

WELL: Basinger "C" #1

API#: 15-195-22,010

COMMENCED: April 12, 1989

LOCATION: 50' N of E/2 SE NW

COMPLETED: April 18, 1989

3350 Ft. FSL, 2970 Ft. FEL

TOTAL DEPTH: 4415 Ft.

SEC. 33 TWP. 15 S RGE. 25 W

ELEVATION: 2452 Ft. G.L.

COUNTY: Trego

2460 Ft. K.B.

REMARKS

Cut 12 1/4" hole to 200' and ran 6 joints 8-5/8" x 32# x 190.5' surface casing. Set at 200' and cemented with 140 sacks 60/40 Pozmix, 2% gel, 3% cc. Cement did circulate. P.D. at 8:00 p.m. 4-12-89.

Drilled to 4415' R.T.D., Mississippi Dolomite, and plugged with 200 sacks 60/40 Pozmix, 6% gel as follows:

25 sx @ 1900'

100 sx @ 875'

40 sx @ 250'

10 sx @ 40'

15 sx R.H., 10 sx M.H.

P.D. at 5:45 p.m. 4-18-89.

STATE COMMISSION
STATE OF KANSAS

MAY 10 1989

CONSERVATION DIVISION
Wichita, Kansas
