

KANSAS

State Geological Survey
WICHITA BRANCH
T. 33S R. 3 W

**WELL COMPLETION REPORT AND
DRILLER'S LOG**

API No. 15 — 169 — 20,112
County Number

Loc. S½ SE½ NE½

County Saline

Operator
ENERGY PRODUCTION, INC.

Address
604 One Main Place, Wichita, Kansas 67202

Well No. 1 Lease Name Miller

Footage Location
330 feet from (N) (S) line 660 feet from (E) (W) line NE¼

Principal Contractor Big Springs Drilling, Inc. Geologist Jerry A. Smith

Spud Date 11-28-80 Date Completed 12-6-80 Total Depth 3,510' P.B.T.D. ---

Directional Deviation less than 3° Oil and/or Gas Purchaser Dry Hole

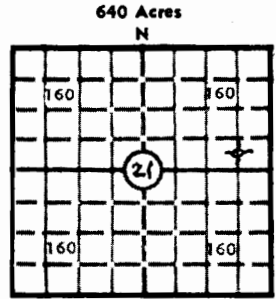

Locate well correctly
Elev.: Gr. 1,265'

DF _____ KB 1,270'

CASING RECORD

Report of all strings set — surface, intermediate, production, etc.

Purpose of string	Size hole drilled	Size casing set (in O.D.)	Weight lbs/ft.	Setting depth	Type cement	Sacks	Type and percent additives
Surface	12¼"	8 5/8"	28	300'	Common	225	2% gel, 3% CaCl

LINER RECORD

PERFORATION RECORD

Top, ft.	Bottom, ft.	Sacks cement	Shots per ft.	Size & type	Depth interval

TUBING RECORD		
Size	Setting depth	Packer set at

ACID, FRACTURE, SHOT, CEMENT SQUEEZE RECORD

Amount and kind of material used	Depth interval treated

INITIAL PRODUCTION

Date of first production		Producing method (flowing, pumping, gas lift, etc.)			
RATE OF PRODUCTION PER 24 HOURS	Oil	Gas	Water	Gas-oil ratio	
	bbls.	MCF	bbls.	CFPB	
Disposition of gas (vented, used on lease or sold)			Producing interval (s)		

INSTRUCTIONS: As provided in KCC Rule 82-2-125, within 90 days after completion of a well, one completed copy of this Drillers Log shall be transmitted to the State Geological Survey of Kansas, 4150 Monroe Street, Wichita, Kansas 67209. Copies of this form are available from the Conservation Division, State Corporation Commission, 245 No. Water, Wichita, Kansas 67202. Phone AC 316-522-2206. If confidential custody is desired, please note Rule 82-2-125. Drillers Logs will be on open file in the Oil and Gas Division, State Geological Survey of Kansas, Lawrence, Kansas 66044.

erator ENERGY PRODUCTION, INC.

DESIGNATE TYPE OF COMP.: OIL, GAS,
 DRY HOLE, SWDW, ETC.:
 Dry hole

Well No. 1	Lease Name Miller
S 21 T15S R 3 	

WELL LOG

Show all important zones of porosity and contents thereof; cored intervals, and all drill-stem tests, including depth interval tested, cushion used, time tool open, flowing and shut-in pressures, and recoveries.

SHOW GEOLOGICAL MARKERS, LOGS RUN, OR OTHER DESCRIPTIVE INFORMATION.

FORMATION DESCRIPTION, CONTENTS, ETC.	TOP	BOTTOM	NAME	DEPTH
<u>Drill Stem Test No. 1 (Maquoketa Dol.)</u> Open 30", shut-in 45", open 30", shut-in 45"; weak blow died in 3", flushed tool but died; no blow second opening; recovered 3 ft. mud w/trace of oil. IFP: 51-36psi; FFP: 55-31 psi; ISIP: 353 psi; FSIP: 241 psi.	3,256	3,280	<u>Electric Log Tops:</u> Heebner Brown Lime Lansing Base Kansas City Wea. Mississippi Solid Miss. Kinderhook Misener Sd. Hunton Maquoketa Sh. Maquoketa Dol. Viola Simpson Sh. Simpson Dol Simpson Sd. Arbuckle Total Depth	1912 (-642) 2054 (-784) 2128 (-858) 2476 (1206) 2740 (-1470) 2746 (-1476) 3011 (-1741) 3162 (-1892) 3166 (-1896) 3204 (-1934) 3259 (-1989) 3314 (-2044) 3424 (-2154) 3431 (-2161) 3461 (-2191) 3484 (-2214) 3511 (-2241)
<u>DRILL Stem Test No. 2 (Viola Lime)</u> Open 30", shut-in 57", open 60", shut-in 84"; fair blow increasing to good blow by end of initial flow period; fair blow throughout final flow period. Recovered 2 ft. free oil, 70 ft. slightly oil cut mud, 60 ft. slightly oil cut watery mud, 185 ft. slightly oil cut muddy water. IFP: 50-85 psi; FFP: 127-174 psi; ISIP: 705 psi; FSIP: 699psi.	3,321	3,355		

USE ADDITIONAL SHEETS, IF NECESSARY, TO COMPLETE WELL RECORD.

Date Received

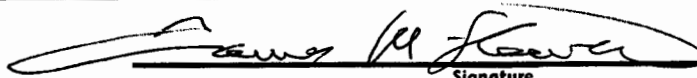

James M. Stewart

Signature

President

Title

January 2, 1981

Date