

County Gove State Kansas
Sec. 24 (Blk. Twp.) 15 (Sur. Rge.) 30W Map No.

Operator Anschutz Drlg.

Well No. 1 Farm Theis Bros.

Elev. Location SW SW SW

330 Ft. From S Line SW

330 Ft. From W Line Quarter

1st. Report MAY 27 1953

Completion

Remarks CSO & Ohio - LHM

Spudding Date

Drlg. Data MCPC has NW 1/4 & E 1/4 SW of 23 Wildcat

Location

J. G. McGEHEE

County Gove State Kansas
Sec. 24 (Blk. Twp.) 15 (Sur. Rge.) 30W Map No.

Operator Anschutz Drlg.

Well No. 1 Farm Theis Bros.

Elev. 2598 Location SW SW SW

330 Ft. From S Line SW

330 Ft. From W Line Quarter

1st. Report

Completion JUN 17 1953

Remarks Wildcat

Spudding Date 5-30-53

Drlg. Data D & A TD 4507

8" @ 227 Anhy 2025 Heeb. 3675

Tor. 3693 Lans. 3726 B KC 4064

Merm. 4080 Ero Miss. 4354

Weathered Miss. 4359 Solid Miss. 4377

TD 4507

D & A

J. G. McGEHEE

HOT FILE

Gove

KANSAS

FORM 51

Gove KANSAS

Sec. 24 Twp. 15 R. 30W

Section 24 Township 15 Range 30 W

Well No. #1 Theis Bros. Farm

Well No. # 1 Theis Bros.

Anschutz Drlg. Company

Company Anschutz Drlg.

Wildcat

Contractor

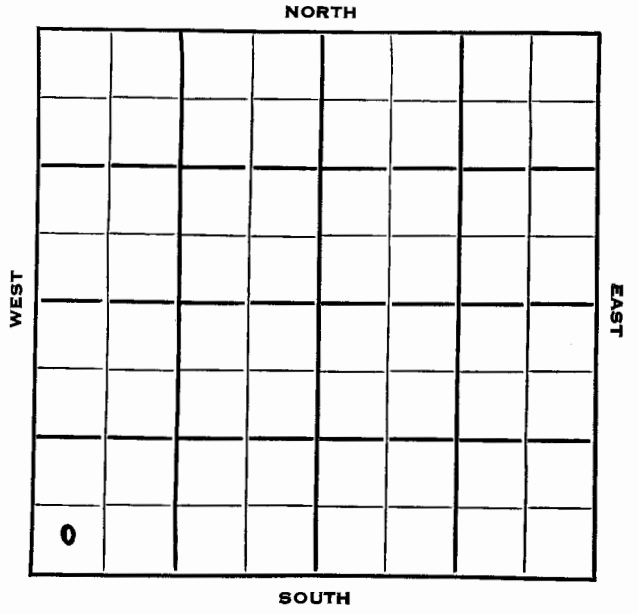
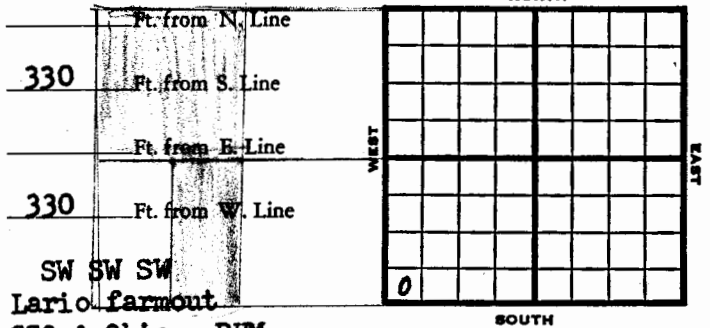

SW SW SW Lario farmout

CSO & Ohio - DHM

1953 Elev. 2598' REPORT

5/27 MCPC has NW 1/4 & E 1/2 SW of 23 Wildcat Location

6/3 Anhy 2025 Drlg. 2420' (Tel)

6/11 Heav 3675', Toro 3693', Lans 3726', B. KC 4064', Marm 4080', Drlg 4161' (Tel)

6/14 Ero. Miss 4354', Wea. Miss 4359', Solid Miss 4577', RTD 4507' Elec. log. D & A (Letter)

6/17 Spud 5-30-53 D & A TD 4507' 4507' 8" @ 227' Anhy 2025, Heeb 3675, Tor 3693, Lans 3726, B KC 4064, Marm 4080, Ero Miss. 4354, Weathered Miss. 4359, Solid Miss 4377 TD 4507' 4507' D & A

ABANDONED