

WICHITA COMPLETION REPORT AND DRILLER'S LOG

API No. 15 — 053 — 20,528
 County Number

S. 32 T. 15 R. 8 E W
 Loc. C N2 NW NW
 County Ellsworth

Operator Ilus Industries, Inc., Executive Building, Suite #128

Address 4121 West 83rd St. Prairie Village, Ks. 66208

Well No. #2 Lease Name Helwick

Footage Location 330 feet from (N) line 620 feet from (E) line

Principal Contractor Emphasis Oil Operations Geologist Pat Balthazor

Spud Date 5-23-79 Date Completed 5-29-79 Total Depth 2678 P.B.T.D. N/A

Directional Deviation N/A Oil and/or Gas Purchaser Ilus Industries, Inc.

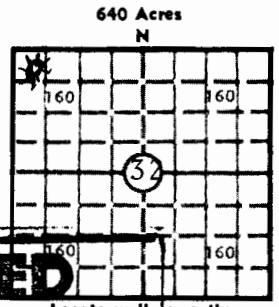

CONFIDENTIAL

RELEASED

Date: APR 9 1982 Elev.: Gr. 1644
 FROM CONFIDENTIAL 1647 KB 1649

CASING RECORD

Report of all strings set— surface, intermediate, production, etc.

Purpose of string	Size hole drilled	Size casing set (in O.D.)	Weight lbs/ft.	Setting depth	Type cement	Socks	Type and percent additives
Surface		8-5/8	28#	239'	Common	160	Gel 3 sks Chlorides 5 sks
Production		4-1/2	11.5#	2677 1/2	Common	60	Pozmix 40 sks Salf 10 sks

LINER RECORD

PERFORATION RECORD

Top, ft.	Bottom, ft.	Sacks cement	Shots per ft.	Size & type	Depth interval
			2	Strip Jet	2660-2676

Size	Setting depth	Packer set at
None		

ACID, FRACTURE, SHOT, CEMENT SQUEEZE RECORD

Amount and kind of material used	Depth interval treated
None	

INITIAL PRODUCTION

Date of first production 6-14-79	Producing method (flowing, pumping, gas lift, etc.) Flowing
RATE OF PRODUCTION PER 24 HOURS	Oil None bbls. Gas 3 m MCF Water None bbls. Gas-oil ratio CFPB
Disposition of gas (vented, used on lease or sold) Sold	Producing interval (s) 2660-2676

INSTRUCTIONS: As provided in KCC Rule 82-2-125, within 90 days after completion of a well, one completed copy of this Drillers Log shall be transmitted to the State Geological Survey of Kansas, 4150 Monroe Street, Wichita, Kansas 67209. Copies of this form are available from the Conservation Division, State Corporation Commission, 245 No. Water, Wichita, Kansas 67202. Phone AC 316-522-2206. If confidential custody is desired, please note Rule 82-2-125. Drillers Logs will be on open file in the Oil and Gas Division, State Geological Survey of Kansas, Lawrence, Kansas 66044.

Operator
Ilus Industries, Inc. DESIGNATE TYPE OF COMP.: OIL, GAS,
DRY HOLE, SWDW, ETC.:
Gas

Well No. 2 Lease Name
Helwick

S 32 T 15 R 8 ^K W 40' West CN/2 NW NW

WELL LOG

Show all important zones of porosity and contents thereof; cored intervals, and all drill-stem tests, including depth interval tested, cushion used, time tool open, flowing and shut-in pressures, and recoveries. SHOW GEOLOGICAL MARKERS, LOGS RUN,
OR OTHER DESCRIPTIVE INFORMATION.

FORMATION DESCRIPTION, CONTENTS, ETC.	TOP	BOTTOM	NAME	DEPTH
Post Rock	80			
Clay & Sand	180			
Shale	250			
Clay & Shale	778			
Shale	1064			
Anhydrite	1093			
Shale & Lime	1240			
Lime & Shale	1560			
Shale & Lime	1735			
Lime & Shale	2250			
Lime	2328			
Lime & Shale	2634			
Shale & Lime (R.T.D.)	2678			

USE ADDITIONAL SHEETS, IF NECESSARY, TO COMPLETE WELL RECORD.

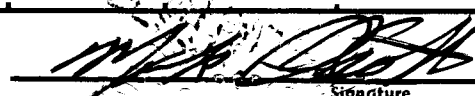
Date Received	 Signature Mark A. Scott, Vice President Title June 18, 1979 Date
---------------	--