

2/28/83
KCC
101
32-15-8W

TYPE

AFFIDAVIT OF COMPLETION FORM

ACO-1 WELL HISTORY

SIDE ONE

Two (2) copies of this form shall be filed with the Kansas Corporation Commission, 200 Colorado Derby Building, Wichita, Kansas 67202, within thirty (30) days after the completion of a well, regardless of how the well was completed.

Attach separate letter of request if the information is to be held confidential. If confidential, only file one copy. Information on Side One will be of public record and Side Two will then be held confidential.

Applications must be made on dual completion, commingling, salt water disposal, injection and temporarily abandoned wells.

Attach one copy only wireline logs (i.e. electrical log, sonic log, gamma ray neutron log, etc.). (Rules 82-2-105 & 82-2-125) KCC# (316) 263-3238.

LICENSE # 5608 EXPIRATION DATE 12/31/83

OPERATOR COMANCHE PRODUCTION, INC. API NO. 15-053-20533

ADDRESS 4121 West 83rd Street COUNTY Ellsworth

Prairie Village, Kansas 66208 FIELD Ellsworth

** CONTACT PERSON Mark A. Scott PROD. FORMATION Lecompton

PHONE (913) 341-9772

PURCHASER Northern Natural Gas Company LEASE Helwick

ADDRESS 2223 Dodge Street WELL NO. #4

Original Omaha, Nebraska 68102 WELL LOCATION C SE NW

DRILLING Emphasis Oil Operations 330 Ft. from East Line and

CONTRACTOR Box 506 330 Ft. from South Line of

ADDRESS Russell, Kansas 67665 the (Qtr.) SEC 32 TWP 15 RGE 8W.

PLUGGING None

CONTRACTOR ADDRESS _____

ADDRESS _____

TOTAL DEPTH 2655' PBTD 2442'

SPUD DATE 7-10-79 DATE COMPLETED 7-17-79

ELEV: GR 1601 DF 1604 Recompletion: 2-28-83 KB 1606

DRILLED WITH (~~CABLE~~) (ROTARY) (~~WIRE~~) TOOLS.

DOCKET NO. OF DISPOSAL OR REPRESSURING WELL BEING USED TO DISPOSE OF WATER FROM THIS LEASE CD 12784

Amount of surface pipe set and cemented 246' (New DV Tool Used? No)

THIS AFFIDAVIT APPLIES TO: (Circle ONE) - Oil, Gas, Shut-in Gas, Dry, Disposal, Injection, Temporarily Abandoned, OWWO. Other _____

ALL REQUIREMENTS OF THE STATUTES, RULES AND REGULATIONS PROMULGATED TO REGULATE THE OIL AND GAS INDUSTRY HAVE BEEN FULLY COMPLIED WITH.

A F F I D A V I T

Mark A. Scott, being of lawful age, hereby certifies that:

I am the Affiant, and I am familiar with the contents of the foregoing Affidavit. The statements and allegations contained therein are true and correct.

WELL PLAT (Office Use Only)

	*		

KCC _____
KGS
SWD/REP _____
PLG. _____

32
RELEASED
Date: MAR 1984
FROM CONFIDENTIAL

Mark A. Scott

SIDE TWO

OPERATOR COMANCHE PRODUCTION, INC LEASE HELWICK

ACO-1 WELL HISTORY
SEC. 32 TWP. 15S RGE. 8W

FILL IN WELL LOG AS REQUIRED:

Show all important zones of porosity and contents thereof; cored intervals, and all drill-stem tests, including depth interval tested, cushion used, time tool open, flowing and shut-in pressures, and recoveries.			SHOW GEOLOGICAL MARKERS, LOGS RUN, OR OTHER DESCRIPTIVE INFORMATION.	
FORMATION DESCRIPTION, CONTENTS, ETC.	TOP	BOTTOM	NAME	DEPTH
Post Rock	155			
Post Rock & Iron	340			
Clay, Shale & Red Bed	948			
Anhydrite	986			
Shale	1318			
Shale & Lime	1738			
Lime & Shale	2488			
Lime	2590			
Lime & Shale (R.T.D.)	2655			

ACID, FRACTURE, SHOT, CEMENT SQUEEZE RECORD

Amount and kind of material used		Depth interval treated
750 gal. 15% MA		2292'-
750 gal. 28% Acid		2298'
Date of first production ^{After} 8-29-79 Re-completion: 3-2-83		Producing method (flowing, pumping, gas lift, etc.) Flowing
RATE OF PRODUCTION PER 24 HOURS		Gravity
Oil -0-	Gas After Re-compl. 120 MCF	Water %
Disposition of gas (vented, used on lease or sold) Sold		Gas-oil ratio
		Perforations 2292' - 2298'

Report of all strings set — surface, intermediate, production, etc. CASING RECORD (New) ~~or~~ (Used)

Purpose of string	Size hole drilled	Size casing set (in O.D.)	Weight lbs/ft.	Setting depth	Type cement	Sacks	Type and percent additives
Surface		8 5/8"		246'			
Production		4 1/2"		2654'			

LINER RECORD

PERFORATION RECORD

Top, ft.	Bottom, ft.	Sacks cement	Shots per ft.	Size & type	Depth interval
			2	jet	2292-2298

TUBING RECORD

Size	Setting depth	Packer set at

15-0-3 P 17
SEP 1982

**WELL COMPLETION REPORT AND
DRILLER'S LOG**

API No. 15 — 053 — 20,533
County Number

S. 32 T. 15 R. 8 W
Loc. C SE NW
County Ellsworth

Operator
Ilus Industries, Inc.

Address
4121 West 83rd St., Suite 128 Prairie Village, Mo. 66208

Well No. #4 Lease Name Helwick

Footage Location
1980 feet from (N) line 1320 feet from (W) line

Principal Contractor Emphasis Oil Operations Geologist Patrick Balthazor
Date: APR 30 1982

Spud Date 7-10-79 Date Completed 7-17-79 Total Depth 2655
P.B.T.D. FROM CONFIDENTIAL

Directional Deviation Oil and/or Gas Purchaser Northern Natural Gas

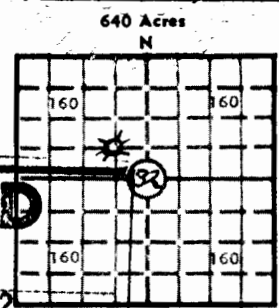

RELEASED

DF 1606 KB 1606

CASING RECORD

Report of all strings set — surface, intermediate, production, etc.

Purpose of string	Size hole drilled	Size casing set (in O.D.)	Weight lbs/ft.	Setting depth	Type cement	Sacks	Type and percent additives

LINER RECORD

PERFORATION RECORD

Top, ft.	Bottom, ft.	Sacks cement	Shots per ft.	Size & type	Depth interval

TUBING RECORD

Size	Setting depth	Packer set at

ACID, FRACTURE, SHOT, CEMENT SQUEEZE RECORD

Amount and kind of material used	Depth interval treated

INITIAL PRODUCTION

Date of first production 8-20-79	Producing method (flowing, pumping, gas lift, etc.)										
<table border="1"> <tr> <th>RATE OF PRODUCTION PER 24 HOURS</th> <th>Oil</th> <th>Gas</th> <th>Water</th> <th>Gas-oil ratio</th> </tr> <tr> <td>Disposition of gas (vented, used on lease or sold)</td> <td>bbls.</td> <td>MCF</td> <td>bbls.</td> <td>CFPB</td> </tr> </table>	RATE OF PRODUCTION PER 24 HOURS	Oil	Gas	Water	Gas-oil ratio	Disposition of gas (vented, used on lease or sold)	bbls.	MCF	bbls.	CFPB	Producing interval (s)
RATE OF PRODUCTION PER 24 HOURS	Oil	Gas	Water	Gas-oil ratio							
Disposition of gas (vented, used on lease or sold)	bbls.	MCF	bbls.	CFPB							

INSTRUCTIONS: As provided in KCC Rule 82-2-125, within 90 days after completion of a well, one completed copy of this Drillers Log shall be transmitted to the State Geological Survey of Kansas, 4150 Monroe Street, Wichita, Kansas 67209. Copies of this form are available from the Conservation Division, State Corporation Commission, 245 No. Water, Wichita, Kansas 67202. Phone AC 316-522-2206. If confidential custody is desired, please note Rule 82-2-125. Drillers Logs will be on open file in the Oil and Gas Division, State Geological Survey of Kansas, Lawrence, Kansas 66044.

