

TIGHT HOLE

KANSAS

P1 *abd*

WELL COMPLETION REPORT AND DRILLER'S LOG

API No. 15 — 053 — 20,558
County Number

S. 32 T. 15 R. 8 E
Loc. 100' W/C S2 SW
County Ellsworth

Operator
Ilus Industries, Inc.

Address Suite 128
4121 W. 83rd St., Prairie Village, Kansas 66208

Well No. #3 Lease Name Svaty

Footage Location
660 feet from (N) (S) line 1220 feet from (E) (W) line

Principal Contractor Emphasis Oil Geologist Patrick Balthazor

Spud Date 10-23-79 Date Completed 11-2-79 Total Depth 2615 P.B.T.D.

Directional Deviation N/A Oil and/or Gas Purchaser Northern Natural Gas

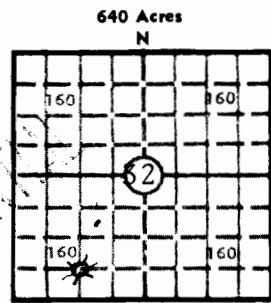

Locate well correctly
Elev.: Gr. 1580
DF 1578 KB 1575

CASING RECORD

Report of all strings set — surface, intermediate, production, etc.

Purpose of string	Size hole drilled	Size casing set (in O.D.)	Weight lbs./ft.	Setting depth	Type cement	Sacks	Type and percent additives
Surface		8-5/8"	9 1/2 #	205'			
Production		4-1/2"		2609'			

LINER RECORD

PERFORATION RECORD

Top, ft.	Bottom, ft.	Sacks cement	Shots per ft.	Size & type	Depth interval

Size	Setting depth	Packer set at

ACID, FRACTURE, SHOT, CEMENT SQUEEZE RECORD

Amount and kind of material used	Depth interval treated

INITIAL PRODUCTION

Date of first production 12-6-79	Producing method (flowing, pumping, gas lift, etc.) Flowing
RATE OF PRODUCTION PER 24 HOURS	Oil bbls. Gas MCF Water bbls. Gas-oil ratio CFPB
Disposition of gas (vented, used on lease or sold) Sold	Producing interval (s)

INSTRUCTIONS: As provided in KCC Rule 82-2-125, within 90 days after completion of a well, one completed copy of this Drillers Log shall be transmitted to the State Geological Survey of Kansas, 4150 Monroe Street, Wichita, Kansas 67209. Copies of this form are available from the Conservation Division, State Corporation Commission, 245 No. Water, Wichita, Kansas 67202. Phone AC 316-522-2206. If confidential custody is desired, please note Rule 82-2-125. Drillers Logs will be on open file in the Oil and Gas Division, State Geological Survey of Kansas, Lawrence, Kansas 66044.

Operator **ILUS INDUSTRIES, INC.** DESIGNATE TYPE OF COMP.: OIL, GAS, DRY HOLE, SWDW, ETC.:

Well No. #3 Lease Name **Svaty** Gas

S 32 T 15 R 8 ~~W~~

WELL LOG

Show all important zones of porosity and contents thereof; cored intervals, and all drill-stem tests, including depth interval tested, cushion used, time tool open, flowing and shut-in pressures, and recoveries.

SHOW GEOLOGICAL MARKERS, LOGS RUN, OR OTHER DESCRIPTIVE INFORMATION.

FORMATION DESCRIPTION, CONTENTS, ETC.	TOP	BOTTOM	NAME	DEPTH
Soil & Clay	20			
Sand & Shale	84			
Iron Pyrite & Shale	210			
Shald & Sand	650			
Lime & Shale	1215			
shale	1512			
Shale & Lime	1730			
Lime & Shale	2293			
Lime	2565			
Lime & Shale (R.T.D.)	2615			

USE ADDITIONAL SHEETS, IF NECESSARY, TO COMPLETE WELL RECORD.

Date Received	ILUS INDUSTRIES, INC. By: <u><i>Mark A. Scott</i></u> <small>Signature</small> Mark A. Scott Title Vice President February 21, 1980 <small>Date</small>
---------------	--