

LAUGHLIN-SIMMONS & CO. OF KANSAS, INC.
 OILWELL ELEVATIONS AND LOCATIONS
 2121 W. 18TH STREET WICHITA, KANSAS 67203 (316) 943-1111

REC'D JAN 20 1975
 1-17-75

DATE: _____
 COUNTY: Ellsworth SECTION: 31 TOWNSHIP: 15s RANGE: 8w
 LOCATION: C NE NE
 OPERATOR: Glen Rupe NO. 1 FARM: HELWICK or Jelinek "OWWO"

ELEVATION: 1652.6

Mr. Glen N. Rupe
 925 Olive Garvey Building
 Wichita, Kansas 67202

SCALE: 2" = 1 Mile

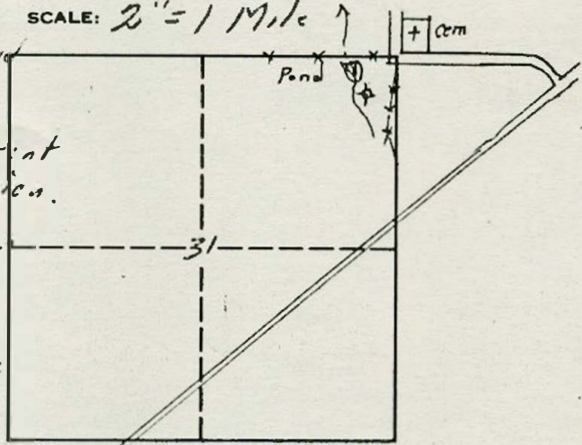

4' iron rod & 1' wood stake of staking.
 In N edge of apparent old collar depression.
 Levelled location on East side of N-S draw
 Good ingress FNE^C of Sect. 31

\$75.00

MINIMUM STAKING CHARGE: _____
 (INCLUDES GROUND ELEVATION)

EXTRA TIME & MILEAGE: _____

ELEVATION CHARGE: _____

TOTAL: \$75.00

[Signature]
 L-S ENGINEER

Laughlin-Simmons & Co. of Kansas, Inc. is not liable in case of errors and/or omissions.

mailed copy Red Figure on per G.N. Rupe 1/25/75