

* AMENDED * 5-12-88

July

STATE CORPORATION COMMISSION OF KANSAS
OIL & GAS CONSERVATION DIVISION
WELL COMPLETION OR RECOMPLETION FORM
ACO-1 WELL HISTORY
DESCRIPTION OF WELL AND LEASE

API NO. 15-.....053-01014
County.....Ellsworth
* NW SE NE
Stn. NE NE Sec. 4.. Twp. 16.. Rge. 10.. East West
* 3630
* 4290 Ft North from Southeast Corner of Section
* 990 Ft West from Southeast Corner of Section
(Note: Locate well in section plat below)

Operator: License #6901
Name ...D.S. & W Well Servicing, Inc....
Address ..P.O. Box 231.....
City/State/Zip ..Claflin, Kansas..67525..

Lease Name.....Heitschmidt * Well # A.3.

Purchaser....Koch Oil Company.....
.....Wichita..Kansas.....

Field Name.....Progress, NW

Operator Contact Person ...Robert L. Strube...
Phone316-587-3361.....

Producing Formation.....Arbuckle

Contractor: License #6901
Name ...D.S. & W Well Servicing, Inc....

Elevation: Ground.....1803.....KB.....1808

Onsite Geologist....None.....
Phone.....

Designate Type of Completion
New Well Re-Entry Workover

Section Plat

MAY 13 1988

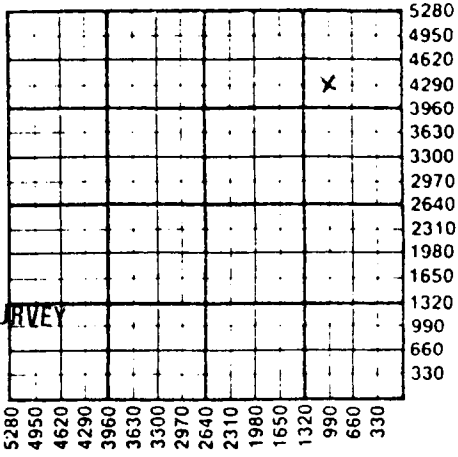

Oil SWD Temp Abd
Gas Inj Delayed Comp.
Dry Other (Core, Water Supply etc.)

KANSAS GEOLOGICAL SURVEY
WICHITA BRANCH

if OWNED: old well info as follows: X
Operator ...Henderson Oil Company.....
* Well Name ...Borecky # A.3.....
* Comp. Date ...NA..... Old Total Depth...3347
10-26-65 3366

WATER SUPPLY INFORMATION

Disposition of Produced Water: Disposal
Docket # Repressuring

Drilling Method:
 Mud Rotary Air Rotary Cable

Questions on this portion of the ACO-1 call:
Water Resources Board (913) 296-3717

Spud Date ..03/20/87... ..04/02/87... ..04/17/87...
Date Reached TD Completion Date

Source of Water:
Division of Water Resources Permit #.....

Total Depth ..3365'..... ..3348.....
PBDT

Groundwater.....Ft North from Southeast Corner
(Well)Ft West from Southeast Corner of
Sec Twp Rge East West

Amount of Surface Pipe Set and Cemented at...345 feet
Multiple Stage Cementing Collar Used? Yes No
If yes, show depth set.....feet
If alternate 2 completion, cement circulated
from.....feet depth to.....w/.....SX cmt
Cement Company Name
Invoice #

Surface Water.....Ft North from Southeast Corner
(Stream, pond etc).....Ft West from Southeast Corner
Sec Twp Rge East West
Other (explain)....City Water.....
(purchased from city, R.W.D. #)

INSTRUCTIONS: This form shall be completed in triplicate and filed with the Kansas Corporation Commission, 200 Colorado Derby Building, Wichita, Kansas 67202, within 120 days of the spud date of any well. Rule 82-3-130, 82-3-107 and 82-3-106 apply.
Information on slide two of this form will be held confidential for a period of 12 months if requested in writing and submitted with the form. See rule 82-3-107 for confidentiality in excess of 12 months.
One copy of all wireline logs and drillers time log shall be attached with this form. Submit CP-4 form with all plugged wells. Submit CP-111 form with all temporarily abandoned wells.

All requirements of the statutes, rules and regulations promulgated to regulate the oil and gas industry have been fully complied with and the statements herein are complete and correct to the best of my knowledge.

Signature ..*Robert L. Strube*.....
Title ..President, D.S. & W..... Date ..May 2, 87

K.C.C. OFFICE USE ONLY
F Letter of Confidentiality Attached
C Wireline Log Received
C Drillers Timelog Received
Distribution
 KCC SWD/Rep NGPA
 KGS Plug RECEIVED for her
STATE CORPORATION COMMISSION (specify)

Subscribed and sworn to before me this ..10th... day of ..May... ..87...
Notary Public ..*Bonnie L. Connell*.....
Notary Commission Expires...April 5, 1987

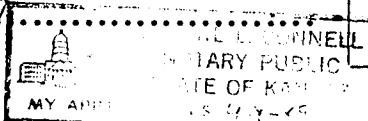

Sec. 4 Twp 16 Rge. 10

Operator Name D S & W Well Servicing, Inc. Lease Name..... Heitschmidt..... Well #... 4...

..... 4..... Twp..... 16... Rge... 10..... East West County..... Ellsworth.....

WELL LOG

INSTRUCTIONS: Show important tops and base of formations penetrated. Detail all cores. Report all drill stem tests giving interval tested, time tool open and closed, flowing and shut-in pressures, whether shut-in pressure reached static level, hydrostatic pressures, bottom hole temperature, fluid recovery, and flow rates gas to surface during test. Attach extra sheet if more space is needed. Attach copy of log.

Drill Stem Tests Taken Yes No
 Samples Sent to Geological Survey Yes No
 Cores Taken Yes No

Formation Description
 Log Sample

Name	Top	Bottom
Arbuckle	3343'	3365

CASING RECORD New Used

Report all strings set-conductor, surface, intermediate, production, etc.

Purpose of String	Size Hole Drilled	Size Casing Set (In O.D.)	Weight Lbs/Ft.	Setting Depth	Type of Cement	#Sacks Used	Type and Percent Additives
Surface	NA	8.5/8"	NA	345	NA	NA	NA
Production cas	NA	5.1/2"	NA	3345	NA	NA	NA
Liner	4.7/8"	4.1/2"	10.1/2#	3365	50-50 Poz	125	50-50 poz 3% gel

PERFORATION RECORD

Acid, Fracture, Shot, Cement Squeeze Record

Shots Per Foot	Specify Footage of Each Interval Perforated	(Amount and Kind of Material Used)	Depth
4	3351' to 3353' set plug @ 3348'	250 gallons 206 FE	
4	3343' to 3345'	250 gallons 206 FE	

TUBING RECORD

Size 2 7/8" Set At 3340' Packer at Liner Run Yes No

Date of First Production 04/18/87 Producing Method Flowing Pumping Gas Lift Other (explain).....

Estimated Production Per 24 Hours	Oil	Gas	Water	Gas-Oil Ratio	Gravity
20 Bbls		MCF	471 Bbls	4% oil	39 CFPB

METHOD OF COMPLETION

Production Interval

Disposition of gas: Vented Open Hole Perforation
 Sold Other (Specify) 3343' to
 Used on Lease Dually Completed 3345'
 Commingled