

RELEASED

Date: APR 1 1989

FROM CONFIDENTIAL
STATE CORPORATION COMMISSION OF KANSAS
OIL & GAS CONSERVATION DIVISION
WELL COMPLETION OR RECOMPLETION FORM
ACC-1 WELL HISTORY
DESCRIPTION OF WELL AND LEASE

SIDE ONE

Operator: License # 5602-3536
Name Pendleton Land and Exploration and
Address Ramco Drilling Services
P.O. Box 86
City/State/Zip Plainville, KS, 67663

Purchaser: Farmland Industries Inc.
Kansas City, Mo.

Operator Contact Person Charles Ramsay
Phone (913) 434-7434

Contractor: License # 5418
Name Allen Drilling Company

Wellsite Geologist Doug Davis
Phone 316-943-8393

Designate Type of Completion
 New well Re-Entry Workover
 Oil SWD Temp Abd
 Gas Inj Delayed Comp.
 Dry Other (Core, Water Supply etc.)

If Old: old well Info as follows:
Operator
Well Name
Comp. Date
Old Total Depth

WELL HISTORY

Drilling Method:
 Mud Rotary Air Rotary Cable
12/18/87... 12-29-87 12/30/87
Spud Date Date Reached TD Completion Date

3600'... 3478'
Total Depth PBTD

Mount of Surface Pipe Set and Cemented at 345 feet
Multiple Stage Cementing Collar Used? Yes No
If yes, show depth set... feet
1 alternate 2 completion, cement circulated
...feet depth to... SX cat
ement Company Name
Invoice #

INSTRUCTIONS: This form shall be completed in triplicate and filed with the Kansas Corporation Commission, 200 Colorado Derby Building, Wichita, Kansas 67202, within 120 days of the spud date of any well. Rule 82-3-130, 82-3-107 and 82-3-106 apply. Information on side two of this form will be held confidential for a period of 12 months if submitted in writing and submitted with the form. See rule 82-3-107 for confidentiality in excess of 12 months. One copy of all wireline logs and drillers time log shall be attached with this form. Submit CP-111 form with all temporarily abandoned wells. All plugged wells. Submit CP-111 form with all temporarily abandoned wells.

Requirements of the statutes, rules and regulations promulgated to regulate the oil and gas industry have been fully complied with and the statements herein are complete and correct to the best of my knowledge.

Signature: [Signature]
Title: Vice Pres H&C Oil Operating Inc
Date: 2-24-88
MAR 02 1988
WICHITA BRANCH

Subscribed and sworn to before me this 25th day of Feb 1989
Notary Public: [Signature]

NOTARY PUBLIC STATE OF KANSAS
DORNE FELLHOELTER
4-11-91

API NO. 15-053-21,036
County: Ellsworth
CWA # 2... SE... Sec... 7... Twp. 16... Rge. 10... East West
1320... Ft North from Southeast Corner of Section
990... Ft West from Southeast Corner of Section
(Note: Locate well in section plat below)
Lease Name: Jezek Well # 1
Field Name: Stoltenberg
Producing Formation: Arbuckle
Elevation: Ground 1872 1877 KB

KANSAS GEOLOGICAL SURVEY
WICHITA BRANCH

APR 26 1989

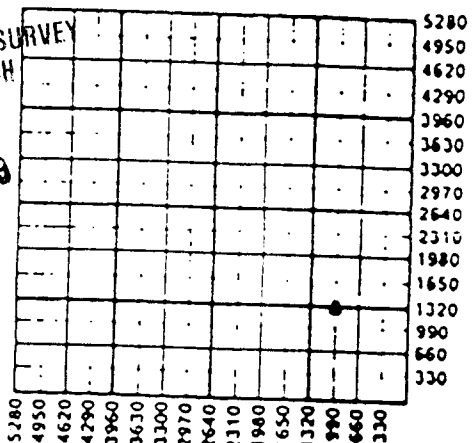

WATER SUPPLY INFORMATION
Disposition of Produced Water: Disposal Repressuring
Docket #

Questions on this portion of the ACC-1 call:
Water Resources Board (913) 296-3717
Source of Water:
Division of Water Resources Permit #
 Groundwater... Ft North from Southeast Corner (Well) ... Ft West from Southeast Corner of Sec Twp Rge East West
 Surface water... Ft North from Southeast Corner (Stream, pond etc.)... Ft West from Southeast Corner Sec Twp Rge East West
 Other (explain): Hauled by contractor (purchased from city, R.W.D. #)

RECEIVED
STATE CORPORATION COMMISSION
OIL & GAS CONSERVATION DIVISION
WICHITA BRANCH

K.C.C. OFFICE USE ONLY
 Letter of Confidentiality Attached
 Wireline Log Received
 Drillers Timelog Received
Distribution
 KCC SWD/Rep NGPA
 KGS Plug Other (Specify)

Sec 7, Twp 16, Rge 10C

Operator Name **Pendleton Land and Exploration and Ramco Drilling Services** Lease Name **Jezeq** Well # **1111**
 Sec. **7** Twp. **16** Rge. **10** East West County **Ellsworth**

HERMAN

WELL LOG

INSTRUCTIONS: Show important tops and base of formations penetrated. Detail all cores. Report all drill stem tests giving interval tested, time tool open and closed, flowing and shut-in pressures, whether shut-in pressure reached static level, hydrostatic pressures, bottom hole temperature, fluid recovery, and flow rates if gas to surface during test. Attach extra sheet if more space is needed. Attach copy of log.

Drill Stem Tests Taken	<input checked="" type="checkbox"/> Yes	<input type="checkbox"/> No	Formation Description <input checked="" type="checkbox"/> Log <input type="checkbox"/> Sample	
Samples Sent to Geological Survey	<input checked="" type="checkbox"/> Yes	<input type="checkbox"/> No		
Cores Taken	<input type="checkbox"/> Yes	<input checked="" type="checkbox"/> No		
ST #1	3295-3347 Arb 30-60-30-60 HP-1699-1524	IFP-62-62 FFP-72-72 ISIP-981 FSIP-827	BHT-108° Rec.-40' Oil cut mud	Oread 2835 Heebner 2919
ST #2	3342-3357 Arb 30-60-60-90 HP-1709-1607	IFP-41-52 FFP-62-83 ISIP-879 FSIP-838	BHT-111° Rec.-40' Free Oil 43° Grav	Toronto 2940 Douglas 2950 Brown Lime 3021 LKC 3034 3298
ST #3	3358-3372 Arb 30-60-30-60 HP-1689-1596	IFP-83-156 FFP-218-260 ISIP-776	FSIP-715 BHT-114° Rec.-70' Free Oil 42° Grav 60' SMWCO 120' SOMCW 300' water	Arbuckle 3033

CASING RECORD New Used

Report all strings set-conductor, surface, intermediate, production, etc.

Purpose of String	Size Hole Drilled	Size Casing Set (In O.D.)	Weight Lbs/Ft.	Setting Depth	Type of Cement	#Sacks Used	Type and Percent Additives
Surface	12 1/4"	8 5/8"	20#	345'	40/60 Poz	160	2% gel; 3% CC
Production	12 1/4"	5 1/2"	15.5#	3533'	40/60 Poz	110	

PERFORATION RECORD

Shots Per Foot	Specify Footage of Each Interval Perforated	Acid, Fracture, Shot, Cement Squeeze Record (Amount and Kind of Material Used)	Depth
4	3380-3383	250 gal 15% MCA	3383
4	3370-3372	100 sks GOMTAN	3383
4	3360-3365	250 gal 15% MCA w/ Hano	3372
4	3350-3356	900 gal 15% NE Acid	3365
		1000 gal 15% NE Acid	3356

TUBING RECORD

Size	Set At	Packer at	Liner Run <input type="checkbox"/> Yes <input type="checkbox"/> No
------	--------	-----------	--

Date of First Production	Producing Method
1-30-88	<input type="checkbox"/> Flowing <input checked="" type="checkbox"/> Pumping <input type="checkbox"/> Gas Lift <input type="checkbox"/> Other (explain).....

Estimated Production Per 24 Hours	Oil	Gas	Water	Gas-Oil Ratio	Gravity
	78 Bbls	MCF	30 Bbls	CFPB	36°

METHOD OF COMPLETION

Disposition of gas: Vented Sold Used on Lease
 Open Hole Perforation
 Other (Specify)
 Dually Completed Corringled

Production Interval
 .3370-3372....
 3360-3365

 3332-3338

7-16-10W

BERMAN FELLHOELTER, JR.

PHONE 913-434-7434

CHARLES RAMSAY

H & C OIL OPERATING, INC.

P. O. Box 86

PLAINVILLE, KANSAS 67663

4

3332-3338

1250 gal 28% INS w/Hamp.

3338

RECEIVED
STATE CORPORATION COMMISSION

MAR.- 3 1988

COMMISSION
Wichita, Kansas