

WELL RECORD

17-16-11W

(Mail to Kansas Geological Survey, 4150 Monroe Street, Wichita, Kansas 67209)

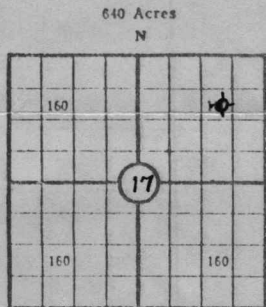

Lease Name: Burmeister Well No. 1
 Well Located: 190' E of Ctr. SW NE NE
SEC 17 TWP 16 RGE 11W
 Operator: M-G-M Oil Company
 Address: 211 N. Broadway, Wichita, Kansas 67202
 Elevation: Ground 1806 D.F. 1809 K.B. 1811
 Type Well: (Oil, gas, dry hole) Dry Hole

Drilling Commenced: 10/19 1971 Drilling Completed: 10/25 19 71
 Well Completed: 10/25 1971 Total Depth 3290'
 Initial Production: D & A

Casing Record

Size: 8 5/8" Set at 329' Size: _____ Set at _____
 Size: _____ Set at _____ Size: _____ Set at _____

Liner Record

Size: _____ Set from _____ To _____

Cementing

Casing Size	Sacks	Type Cement and Additives
<u>8 5/8"</u>	<u>200</u>	<u>Plain with 2% gel and 3% CaCl</u>
_____	_____	_____
_____	_____	_____

Perforations

Formation	Perforated Interval and Number Shots
_____	_____
_____	_____
_____	_____

Electric Log Run (Show type log and depths covered)

NONE

17-16-11W

Show Drill Stem Tests, 17-16-11w
Well Stimulation and
Production Tests

Formation Top Bottom



ANHYDRITE (Driller)	667	692
HEEBNER SH.	2843	47
TORONTO LS.	2859	74
DOUGLAS SH.	2874	2936
BROWN LIME	2936	
LANSING LS.	2953	

DST #1: 2940 - 3016, Open 30 min., SI 30 min.,
Open 30 min., SI 30 min., Fair to Weak
blow, Recovered 248 ft. Mud; IBHP 347#,
FBHP 237#; FP 96 - 192#.

DST #2: 3034 - 3052, Open 30 min. SI 30 min.,
Open 1 hr., SI 30 min., Fair to Good
blow, Recovered 600 ft. Muddy Salt Wtr.;
IBHP 640#, FBHP 622#; FP 73 - 329#.

DST #3: 3134 - 3148, Open 30 min. SI 30 min.,
Open 30 min., SI 30 min., Weak blow,
Recovered 120 ft. Watery Mud; IBHP 668#,
FBHP 577#; FP 265 - 274#.

Penn. CONGL.	3246	3288
ARBUCKLE DOL.	3288	
TOTAL DEPTH		3290

DRY & ABANDONED IN ARBUCKLE DOL.

098915

17-16-11w