

J. J. J.

STATE CORPORATION COMMISSION OF KANSAS
OIL & GAS CONSERVATION DIVISION

WELL COMPLETION OR RECOMPLETION FORM
ACO-1 WELL HISTORY

DESCRIPTION OF WELL AND LEASE

Operator: license # 9629
name Griffin Resources, Inc.
address 100 S. Main, Suite 200
City/State/Zip Wichita, Kansas 67202

Operator Contact Person Van F. Griffin
Phone 316-262-1641

Contractor: license # 5147
name BEREDCO INC.

Wellsite Geologist Mike Freeman
Phone 684-3412

Complete Type of Completion

New Well Re-Entry Workover

- Oil SWD Temp Abd
- Gas Inj Delayed Comp.
- Dry Other (Core, Water Supply etc.)

Old Well Info (if applicable):

Operator
Well Name
Comp. Date Old Total Depth

WELL HISTORY

Drilling Method: Mud Rotary Air Rotary Cable
Date 11/6/85 Date Reached TD 11/12/85 Completion Date 11-12-85

Total Depth 4180' PBTB

Amount of Surface Pipe Set and Cemented at 302' feet

Multiple Stage Cementing Collar Used? Yes No

If Yes, Show Depth Set feet

If alternate 2 completion, cement circulated from feet depth to w/ SX cmt

API NO. 15-135-22,954

County Ness, Kansas

C. SW SW NE Sec. 34 Twp. 16S. Rge. 21W. West

2970 Ft North from Southeast Corner of Section
2310 Ft West from Southeast Corner of Section
(Note: locate well in section plat below)

Lease Name Pfaff "A" Well# 2

Field Name Jolly

Producing Formation Cherokee "A" sand

Elevation: Ground 2226' KB 2231'

Section Plat

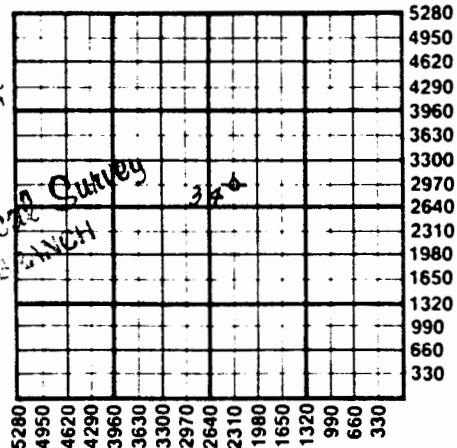

DEC 11 1995
State Geologist
WICHITA BRANCH

WATER SUPPLY INFORMATION

Source of Water:
 Division of Water Resources Permit #
 Groundwater Ft North From Southeast Corner and (Well) Ft. West From Southeast Corner of: Sec Twp Rge East West
 Surface Water Ft North From Southeast Corner and (Stream, Pond etc.) 6 miles away Ft West From Southeast Corner Sec Twp Rge East West
 Other (explain) HAULED WATER (purchased from city, R.W.D.#)

Disposition of Produced Water: Disposal Repressuring

Docket #

INSTRUCTIONS: This form shall be completed in duplicate and filed with the Kansas Corporation Commission, 200 Colorado Derby Building, Wichita, Kansas 67202, within 90 days after completion or recompletion of any well. Rules 82-3-130 and 82-3-107 apply.

Information on side two of this form will be held confidential for a period of 12 months if requested in writing and submitted with the form. See rule 82-3-107 for confidentiality in excess of 12 months.

One copy of all wireline logs and drillers time log shall be attached with this form. Submit CP-4 form with all plugged wells. Submit CP-111 form with all temporarily abandoned wells.

SIDE TWO

Operator Name Griffin Resources, Inc. Lease Name PFAFF "A" Well# 2 SEC 34 TWP. 16S RGE. 21 East West

WELL LOG

INSTRUCTIONS: Show important tops and base of formations penetrated. Detail all cores. Report all drill stem tests giving interval tested, time tool open and closed, flowing and shut-in pressures, whether shut-in pressure reached static level, hydrostatic pressures, bottom hole temperature, fluid recovery, and flow rates if gas to surface during test. Attach extra sheet if more space is needed. Attach copy of log.

Drill Stem Tests Taken Yes No
 Samples Sent to Geological Survey Yes No
 Cores Taken Yes No

Formation Description
 Log Sample

DST #1 4094-4113' (Cherokee "A") 30-30-30-30; Rec. 2' mud, no shows.

DST #2 4096-4130' misrun.

DST #3 4096-4132' (Cher. "B") 10-30-20-60; Rec. 1395' muddy water. IFP 199-336; ISIP 785#; FFP 525-566#; FSIP 827#; FHP 2046#; Orders given to P & A.

Name	Top	Bottom
Anhy.	1512	(+719)
Penn.	3143	(-912)
Heeb.	3608	(-1377)
Pawnee	4006	(-1775)
Bs. Pawn.	4071	(-1825)
Ft. Sc.	4087	(-1856)
Cher. A	4104	(-1873)
Cher. B	4119	(-1888)
Unc.	4145	(-1911)
LTD	4181	

DEC 11 1995
 State Geological Survey
 WICHITA BRANCH

CASING RECORD new used

Report all strings set - conductor, surface, intermediate, production, etc.

Purpose of string	size hole drilled	size casing set (in O.D.)	weight lbs/ft.	setting depth	type of cement	# sacks used	type and percent additives
Surface	12-1/4"	8 5/8"	23#	302'	60-40 Poz.	200	6% gel

PERFORATION RECORD

Acid, Fracture, Shot, Cement Squeeze Record

shots per foot	specify footage of each interval perforated	(amount and kind of material used)	Depth