

**WELL COMPLETION REPORT AND
DRILLER'S LOG**

S. 15 T. 16 R. 28W E W

API No. 15 — 101 — 20,561
County Number

Loc. NW NW SW

County Lane

Operator
Texas Oil & Gas Corp.

Address
200 W. Douglas, Suite 300

Well No. 1 Lease Name Dixon "F"

Footage Location
2310' feet from (N) (S) line 330' feet from (E) (W) line

Principal Contractor Kandrillco Geologist Earl Moore

Spud Date 10-5-81 Date Completed 10-14-81 Total Depth 4635' P.B.T.D. N/A

Directional Deviation Not directionally drilled Oil and/or Gas Purchaser N/A

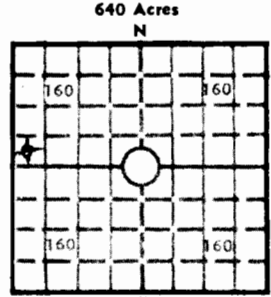

Elev.: Gr. 2655

DF KB 2663

CASING RECORD

Report of all strings set — surface, intermediate, production, etc.

Purpose of string	Size hole drilled	Size casing set (in O.D.)	Weight lbs/ft.	Setting depth	Type cement	Sacks	Type and percent additives
Surface	12 1/4"	8-5/8	24#	598'	lite common	225 125	

LINER RECORD

PERFORATION RECORD

Top, ft.	Bottom, ft.	Sacks cement	Shots per ft.	Size & type	Depth interval
N/A	N/A	N/A	N/A	N/A	N/A

Size	Setting depth	Packer set at
N/A	N/A	N/A

ACID, FRACTURE, SHOT, CEMENT SQUEEZE RECORD

Amount and kind of material used	Depth interval treated
N/A	N/A

INITIAL PRODUCTION

Date of first production D & A 10-14-81		Producing method (flowing, pumping, gas lift, etc.) N/A			
RATE OF PRODUCTION PER 24 HOURS	Oil N/A bbls.	Gas N/A MCF	Water N/A bbls.	Gas-oil ratio N/A	CFPB
Disposition of gas (vented, used on lease or sold) Dry & Abandoned 10-14-81			Producing interval (s) N/A		

INSTRUCTIONS: As provided in KCC Rule 82-2-125, within 90 days after completion of a well, one completed copy of this Drillers Log shall be transmitted to the State Geological Survey of Kansas, 4150 Monroe Street, Wichita, Kansas 67209. Copies of this form are available from the Conservation Division, State Corporation Commission, 245 No. Water, Wichita, Kansas 67202. Phone AC 316-522-2206. If confidential custody is desired, please note Rule 82-2-125. Drillers Logs will be on open file in the Oil and Gas Division, State Geological Survey of Kansas, Lawrence, Kansas 66044.

Operator TXO Production Corp. DESIGNATE TYPE OF COMP.: OIL, GAS, DRY HOLE, SWDW, ETC.: D & A

Well No. #1 Lease Name Dixon "F" #1

S 15 T 16 R 28 E W

WELL LOG
 Show all important zones of porosity and contents thereof; cored intervals, and all drill-stem tests, including depth interval tested, cushion used, time tool open, flowing and shut-in pressures, and recoveries.
 SHOW GEOLOGICAL MARKERS, LOGS RUN, OR OTHER DESCRIPTIVE INFORMATION.

FORMATION DESCRIPTION, CONTENTS, ETC.	TOP	BOTTOM	NAME	DEPTH
<u>LOG TOPS</u>				
Stone Corral	2078	-585		
Topeka	3566	-903		
Heebner	3854	-1191		
Toronto	3872	-1209		
Lansing	3892	-1229		
Lansing "H"	4068	-1405		
Marmaton	4230	-1567		
Pawnee	4368	-1705		
Cherokee	4434	-1771		
Mississippian	4522	-1859		
RTD	4635			
LTD	4634			
Ran O.H. Logs				
No DSTs.				

USE ADDITIONAL SHEETS, IF NECESSARY, TO COMPLETE WELL RECORD.

Date Received	<i>Harold R. Trapp</i>
	Harold R. Trapp District Geologist
	Title
	October 14, 1981
	Date