

Confidential

MAR 17 1977

KANSAS DRILLERS LOG

S. 16 T. 16 R. 7W E

API No. 15 County Number

Loc. C NE/4

County Ellsworth

Operator G.N. RUPE

Address 925 Garvey Bldg. 200 W. Douglas Wichita, Ks.

Well No. #1 Lease Name Vondra

Footage Location 1320 feet from (N) line 1320 feet from (E) line

Principal Contractor Sterling Drilling Geologist Dick Foley

Spud Date July 31, 1973 Total Depth 1825 P.B.T.D.

Date Completed August 6, 1973 Oil Purchaser

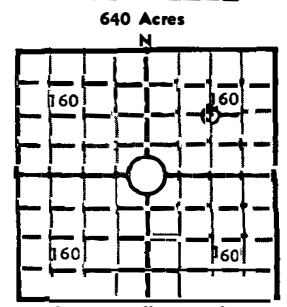

Elev.: Gr. 1567

DF KB

CASING RECORD

Report of all strings set— surface, intermediate, production, etc.

Purpose of string	Size hole drilled	Size casing set (in O.D.)	Weight lbs/ft.	Setting depth	Type cement	Sacks	Type and percent additives
Surface	9"	7"	20	211	Poz mix 60%	100	3% CaCl
Production	6 1/4"	4 1/2"	9.5	1824	Poz mix 50/50	150	Salt Sat.

LINER RECORD

PERFORATION RECORD

Top, ft.	Bottom, ft.	Sacks cement	Shots per ft.	Size & type	Depth interval
			2	jet	1752-54
			2	jet	1758-62
			2	jet	1766-72
			2	jet	1083-92

TUBING RECORD

ACID, FRACTURE, SHOT, CEMENT SQUEEZE RECORD

Amount and kind of material used	Depth interval treated
500 gal Gaswell BD Acid, Frac w/3000 #20/40sd. & 800 scf CO2/B	1752-54, 1756-62 & 1766-72
500 gal Gaswell BD Acid, 3000 gal Gaswell Acid & w/2100 scf CO2/B	1083-92

INITIAL PRODUCTION

Date of first production	Producing method (flowing, pumping, gas lift, etc.)
RATE OF PRODUCTION PER 24 HOURS	Oil bbls. Gas MCF Water bbls. Gas-oil ratio CFPB
Disposition of gas (vented, used on lease or sold)	Producing interval (s)

MAR 17 1976

INSTRUCTIONS: As provided in KCC Rule 82-2-125, within 90 days after completion of a well, one completed copy of this Drillers Log shall be transmitted to the State Geological Survey of Kansas, 4150 Monroe Street, Wichita, Kansas 67209. Copies of this form are available from the Conservation Division, State Corporation Commission, 3830 So. Meridian (P.O. Box 17027), Wichita, Kansas 66217. Phone AC 316-522-2206. If confidential custody is desired, please note Rule 82-2-125. Drillers Logs will be on open file in the Oil and Gas Division, State Geological Survey of Kansas, Lawrence, Kansas 66044.

Operator G. N. Ripe DESIGNATE TYPE OF COMP.: OIL, GAS, DRY HOLE, SWDW, ETC.:

Well No. 1 Lease Name VONDRA SIGW

S 16 T 16 R 7 W

WELL LOG

Show all important zones of porosity and contents thereof; cored intervals, and all drill-stem tests, including depth interval tested, cushion used, time tool open, flowing and shut-in pressures, and recoveries.

SHOW GEOLOGICAL MARKERS, LOGS RUN, OR OTHER DESCRIPTIVE INFORMATION.

FORMATION DESCRIPTION, CONTENTS, ETC.	TOP	BOTTOM	NAME	DEPTH
<u>Dst's</u>				
<u>Dst #1</u> 960-995 open 40" ISIP 39 # 30", FSIP 39 # 30", IFP 24 #, FFP 31 #. Rec. 2' mud.			Herrington ls.	
<u>Dst #2</u> 1015-1055 open 30" ISIP 78 # 30", FSIP 78 # 1'30", IFP 31 #, FFP 39 # Rec. 30' mud.			Winfield ls.	
<u>Dst #3</u> 1080-1110 open 2 1/2 hr. ISIP 305 # 60", FSIP 297 # 60", IFP 31 # FFP 63 # Rec. GTS on 2nd opening in 70". gauge 6,330, 7,934 in 1 1/2 hr. Rec. 90' slightly thin g c mud.			Towanda ls.	
<u>Dst #4</u> 1746-75 Open 2 hr. ISIP 681 # 45", FSIP 673 # 60", IFP 133 #, FFP 172 #. Rec. GTS in 2'. gauge 814, mo/30". 2nd open GTS 5" gauge 920, run stable AT 885, mo 1730".			Grandhaven SS.	
<u>Production Test</u> 1.3 MMcf pd			Grandhaven SS.	

USE ADDITIONAL SHEETS, IF NECESSARY, TO COMPLETE WELL RECORD.

Date Received	Signature
	Title
	Date

State Geological Survey
WICHITA, BRANCH

Released
CONFIDENTIAL

15-055-20301

16-16S-7W

STERLING DRILLING COMPANY
P. O. Box 129
Sterling, Kansas 67579

WELL LOG ----- VONDRA #1
Located: C NE/4, Section 16-16S-7W, Ellsworth County,
Kansas

OWNER: Glen Rupe
ROTARY DRILLING CONTRACTOR: Sterling Drilling Company

COMMENCED: July 31, 1973
COMPLETED: August 6, 1973

TOTAL DEPTH: 1825'

LOG

0 - 105 Shale and Sand
105 - 220 ~~Shale~~ and Shells
220 - 390 Shale
390 - 1825 Lime and Shale

CASING RECORD

Ran 7 joints used seammlless 7" 20# casing.
Tallied 211.28', set at 211' G.L. with 100
sacks 60/40 Pozmix with 3% cc. Plug down
at 4:15 AM, 8-1-73, by Sun Cement Co.

Ran 61 joints 4 1/2" 9.5# used seamless
casing. Set at 1824', cemented with 150
sacks 50/50 Pozmix, salt saturated. Plug
down at 8:00 PM, 8-6-73.

RECEIVED
STATE CORPORATION COMMISSION

MAY 31 1974

CONSERVATION DIVISION
Wichita, Kansas



COPY
ILABLE

GAS SUPPLY EVALUATION
GAS SUPPLY DIVISION

16-16-700 md

INITIAL WELL TEST EVALUATION

Date SEPT. 25, 1973

TO: Contract Operations
Gas Purchases
Liberal
Midland

WELL DESCRIPTION

REC'D U/LT 26 1978

Operator RUPE OIL Co Station No. _____
Well Name & No. VONDRA #1 - Tubing System ELLSWORTH COUNTY
Location 16-16-7 County ELLSWORTH State KANSAS
Reservoir TARKIO Field _____
Perfs: 1756 to 1772 ; _____ to _____ : _____ to _____
_____ to _____ ; _____ to _____ : _____ to _____

TEST RESULTS

Shot-in Pressure 661.4 psia; Duration 72.0 hours; Date 9-4-73

Wellhead "n" 0.649 Absolute "n" 0.661

Calculated Deliverability: 365 MCF/d after 72.0 hours at 50 % P

Stabilized Deliverability: 333 MCF/d against 494 psia Line Pressu

1.0 Hour 4 Point Wellhead Potential 2351 MC

1.0 Hour 4 Point Absolute Potential 2482 MC

20.7 Hr. Wellhead Potential 833 MCF/d; 20.2 Hr. Absolute Potential 848 MC

72.0 Hr. Wellhead Potential 708 MCF/d; _____ Hr. Absolute Potential _____ MC

Stabilized Wellhead Potential 567 MCF/d; Stabilization Time 1,000 ho

Stabilization Factors: ESTIMATED

20.7 hours to 72 hours: 0.850

72 hours to Trb: 0.80

JUN 1 9 1975

By: [Signature]

Gas Supply Evaluation Dept.

September 11, 1973

Mr. Dan M. Carney
P. O. Box 18423
Wichita, Kansas 67218

Mr. Bill Higgins
313 First National Bank Building
Wichita, Kansas 67202

Dear Dan and Bill:

Two discovery Wells in new Zones in Pool

KANAK #1 - 100' SE of C W/2 of Section 15-16S-7W, Ellsworth County, Kansas
Northern Natural's 4 Point Test--open flow potential

Grand Haven Sandstone 600,000 cu. ft. gas
Towanda 410,000 cu. ft. gas

VONDRA #1 - C NE/4 of Section 16-16S-7W, Ellsworth County, Kansas

Northern Natural's 4 Point Test--open flow potential

Grand Haven Sandstone 2,800,000 cu. ft. gas
Towanda 300,000 cu. ft. gas

The ANDERSON #1 - SW SE SW of Section 11-20S-8W, McPherson County, Kansas
4 Point Test--open flow
335,000 Cu. ft. Gas

The ANDREWS #1 - 75' NE of E/2 NW SE of Sec. 4-17S-8W, Ellsworth County, Kansas
watered up--will clean up more or may set separator.
Well looks good and stable.

Handwritten note:
Kurdle
Refer 10/73
for analysis

JOHNSON #1 - NW NW SE of Sec. 5-18S-8W, Rice County, Kansas
4 Point Test - Approx. 250,000 cu. ft. gas/day
as per John Cecil, Jr. 10/8/73