

KANSAS CORPORATION COMMISSION

WELL RECORD

20-17-13W

(Mail to Kansas Geological Survey, 4150 Monroe Street, Wichita, Kansas 67209)

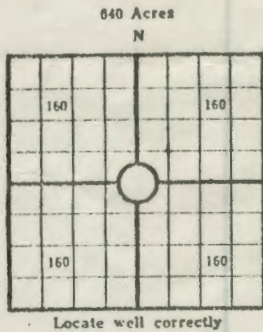

Lease Name: Anderson "A" Well No. 2
 Well Located: C N $\frac{1}{2}$ SE NW McPherson County
SEC 20 TWP 17s RGE 13w
 Operator: J. A. Allison
 Address: 1415 Wichita Plaza Bldg., Wichita, Ks.
 Elevation: Ground 1331 D.F. 1334 K.B. 1336
 Type Well: (Oil, gas, dry hole) dry hole

Drilling Commenced: 5/15 1972 Drilling Completed: 5/24 1972
 Well Completed: 19 Total Depth 3490'
 Initial Production: dry

Casing Record

Size: 13" Set at 200' Size: _____ Set at _____
 Size: 8 5/8" Set at 406' Size: _____ Set at _____

Liner Record

Size: _____ Set from _____

RECEIVED
 STATE CORPORATION COMMISSION
 To _____

JUN 7 1972

CONSERVATION DIVISION
 Wichita, Kansas

Cementing

Casing Size	Sacks	Type Cement and Additives
<u>13"</u>	<u>225</u>	<u>Portland - 3% CC, 2% Gel</u>
<u>8 5/8"</u>	<u>200</u>	<u>Portland - 3% CC, 2% Gel</u>

Perforations

Formation Perforated Interval and Number Shots

Formation	Perforated Interval	Number Shots
_____	_____	_____
_____	_____	_____
_____	_____	_____
_____	_____	_____
_____	_____	_____

Electric Log Run (Show type log and depths covered)

Radiation-Guard Log 2850'-3397'

20-11-120

FORMATION, TESTING AND COMPLETION RECORD

20-17-13w

Show Drill Stem Tests,
Well Stimulation and
Production Tests

Formation Top Bottom

Mississippi	2896	3115
Kinderhook	3115	3344
Maquoketa	3344	3385
Viola	3385	3462
Simp Dolomite	3470	3473
Simp Sand	3473	RTD



Michigan Kansas
CONSERVATION DIVISION
STATE CORPORATION COMMISSION
RECEIVED

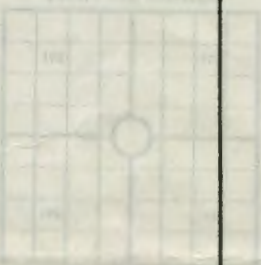

20-17-13w