

State Geological Survey
WICHITA, BRANCH

KANSAS DRILLERS LOG

S. 2 T. 17 R. 40 ^E_W

API No. 15 — 071 — 20,107
County Number

Loc. C SW

County Greeley

Operator
Dorchester Exploration, Inc.

Address
1100 Midland National Bank Tower, Midland, Texas 79701

Well No. 1 Lease Name Adams

Footage Location
1320 feet from NE (S) line 1320 feet from NE (W) line

Principal Contractor Earl F. Wakefield, Inc. Geologist R. L. Higginbottom

Spud Date 5-25-76 Total Depth 3060 P.B.T.D. 3055

Date Completed 6-18-76 Oil Purchaser

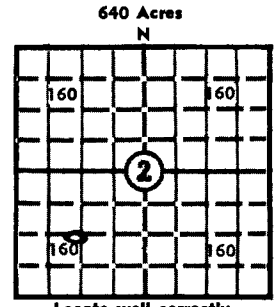

Elev.: Gr. 3615

DF _____ KB _____

CASING RECORD

Report of all strings set — surface, intermediate, production, etc.

Purpose of string	Size hole drilled	Size casing set (in O.D.)	Weight lbs/ft.	Setting depth	Type cement	Sacks	Type and percent additives
Surface	12 1/4"	8 5/8"	24	235	Class "H"	200	3% CaCl
Production	7 7/8"	4 1/2"	10.5	3055	Class "H"	400	4 1/2% Gal

LINER RECORD

PERFORATION RECORD

Top, ft.	Bottom, ft.	Sacks cement	Shots per ft.	Size & type	Depth interval
			1 hole per ft		2948-2958
			1 hole per ft		2968-2972

TUBING RECORD

Size	Setting depth	Packer set at
2 3/8"	2990	

ACID, FRACTURE, SHOT, CEMENT SQUEEZE RECORD

Amount and kind of material used	Depth interval treated
Acid 500 gals 15% with HC-2 Morflo & FE-1A	2948-58, 2968-72
Frac 21,000 gals gelled 2% KCL water, 13,500# 20-40 sand	2948-58, 2968-72

INITIAL PRODUCTION

Date of first production 9-7-76	Producing method (flowing, pumping, gas lift, etc.) Flow
RATE OF PRODUCTION PER 24 HOURS	Oil -0- bbls. Gas 5041 MCF Water trace bbls. Gas-oil ratio ---- CFPB
Disposition of gas (vented, used on lease or sold) Sold - Sunflower Coop	Producing interval(s) 2948-58, 2968-72

INSTRUCTIONS: As provided in KCC Rule 82-2-125, within 90 days after completion of a well, one completed copy of this Drillers Log shall be transmitted to the State Geological Survey of Kansas, 4150 Monroe Street, Wichita, Kansas 67209. Copies of this form are available from the Conservation Division, State Corporation Commission, 3830 So. Meridian (P.O. Box 17027), Wichita, Kansas 66217. Phone AC 316-522-2206. If confidential custody is desired, please note Rule 82-2-125. Drillers Logs will be on open file in the Oil and Gas Division, State Geological Survey of Kansas, Lawrence, Kansas 66044.

Operator Worcester Exploration, Inc.		DESIGNATE TYPE OF COMP.: OIL, GAS, DRY HOLE, SWDW, ETC.:
Well No. 1	Lease Name Adams	Gas
S 2 T 17-R 40 ^F _W		

WELL LOG

Show all important zones of porosity and contents thereof; cored intervals, and all drill-stem tests, including depth interval tested, cushion used, time tool open, flowing and shut-in pressures, and recoveries.

SHOW GEOLOGICAL MARKERS, LOGS RUN, OR OTHER DESCRIPTIVE INFORMATION.

FORMATION DESCRIPTION, CONTENTS, ETC.	TOP	BOTTOM	NAME	DEPTH
Sand, Blue Shale	0	234	Base Stone Corral	2621
Blue Clay & Shale	234	1634	Top Winfield	2916
Lime & Shale	1634	1664	Top U. Ft Riley	2977
Shale, Anhydrite & salt	1654	2047	Top L. Ft Riley	3013
Glorietta Sand & Anhydrite	2047	2460		
Shale & Lime	2460	3060		
			Walex Compensated Acoustic Velocity Gamma Ray-Caliper Log 220-3059 ¹	

USE ADDITIONAL SHEETS, IF NECESSARY, TO COMPLETE WELL RECORD.

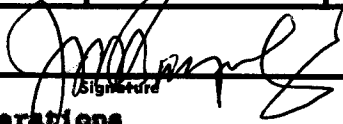
Date Received	J. W. Payne 
	Manager of Operations
	11-16-76
	<small>Signature</small> <small>Title</small> <small>Date</small>

882118