

**KANSAS DRILLERS LOG**

20069  
 State Geological Survey  
 WICHITA, BRANCH

S. 20 T. 17 R. 40  $\frac{1}{4}$  W  
 Loc. CNE  
 County \_\_\_\_\_

API No. 15 — 071 — 20,000  
 County Number

Operator  
 R. C. Banks & Cecil Rhodes

Address  
 Box 242, Midland, Texas 79701

Well No. 1 Lease Name Hunt

Footage Location  
 1320 feet from (N)  line 1320 feet from (E)  line

Principal Contractor Sterling Drilling Company Geologist D. Lloyd Henderson

Spud Date January 25, 1975 Total Depth 3325 P.B.T.D. 3042

Date Completed \_\_\_\_\_ Oil Purchaser \_\_\_\_\_

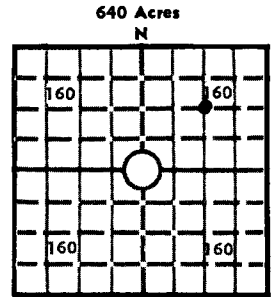

Elev.: Gr. 3630  
 DF \_\_\_\_\_ KB 3640

**CASING RECORD**

Report of all strings set — surface, intermediate, production, etc.

Purpose of string	Size hole drilled	Size casing set (in O.D.)	Weight lbs/ft.	Setting depth	Type cement	Sacks	Type and percent additives
Surface	12 1/4"	8 5/8"	28#	261'	Class "H"	225	3% Ca Cl
Production	7 7/8"	4 1/2"	10.50#	3053'	Pozmix	125	6# salt/sk

**LINER RECORD**

**PERFORATION RECORD**

Top, ft.	Bottom, ft.	Sacks cement	Shots per ft.	Size & type	Depth interval
None	---	—	7 total	Jet	2978-2986
<b>TUBING RECORD</b>			11 total	Jet	( 2960-2968
					( 2948-2954
					( 2936-2938
Size	Setting depth	Packer set at			
2 3/8"	3012	None			

**ACID, FRACTURE, SHOT, CEMENT SQUEEZE RECORD**

Amount and kind of material used	Depth interval treated
500 gal 15% acid	2978-2986
1000 gal 15% acid	2936-2968

**INITIAL PRODUCTION**

Date of first production \_\_\_\_\_ Producing method (flowing, pumping, gas lift, etc.)  
 Flow

RATE OF PRODUCTION PER 24 HOURS  
 Oil None bbls. Gas 420 MCF Water None bbls. Gas-oil ratio — CFPB

Disposition of gas (vented, used on lease or sold) Wait on pipeline connection Producing interval (s) 2936 - 2986

INSTRUCTIONS: As provided in KCC Rule 82-2-125, within 90 days after completion of a well, one completed copy of this Drillers Log shall be transmitted to the State Geological Survey of Kansas, 4150 Monroe Street, Wichita, Kansas 67209. Copies of this form are available from the Conservation Division, State Corporation Commission, 3830 So. Meridian (P.O. Box 17027), Wichita, Kansas 66217. Phone AC 316-522-2206. If confidential custody is desired, please note Rule 82-2-125. Drillers Logs will be on open file in the Oil and Gas Division, State Geological Survey of Kansas, Lawrence, Kansas 66044.

operator

R. C. Banks & Cecil Rhodes

DESIGNATE TYPE OF COMP.: OIL, GAS,  
DRY HOLE, SWDW, ETC.:  
Gas

Well No.

Lease Name

S 20 T 17 R 40 <sup>X</sup><sub>W</sub>

### WELL LOG

Show all important zones of porosity and contents thereof; cored intervals, and all drill-stem tests, including depth interval tested, cushion used, time tool open, flowing and shut-in pressures, and recoveries.

SHOW GEOLOGICAL MARKERS, LOGS RUN, OR OTHER DESCRIPTIVE INFORMATION.

FORMATION DESCRIPTION, CONTENTS, ETC.	TOP	BOTTOM	NAME	DEPTH
No DST's			Welex	
No Cores			Gamma -	250'-3315'
<u>Lower Winfield</u> , tan to buff, very fine grained dolomitic sandstone, porous friable in part, contains gas.	2927'	2954'	Acoustic Velocity - Caliper	
<u>Upper Fort Riley</u> , dolomitic sandstone, as above, contains gas.	2958	2988	<u>GO INTERNATIONAL</u> Cement Bond - GR Correlation	2500' 3044'
			<u>Formation Tops</u>	
			Base Stone Corral	2616'
			Upper Winfield	2900'
			Lower Winfield	2927'
			Upper Fort Riley	2958'
			Lower Fort Riley	2998'
			Council Grove	3048'

USE ADDITIONAL SHEETS, IF NECESSARY, TO COMPLETE WELL RECORD.

Date Received

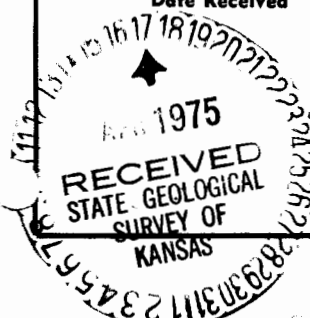

*R.C. Banks*  
Signature

Operator  
Title  
3/21/75  
Date